

ABN 31 105 704 078

13 Brock Street, Thomastown

Victoria 3074

(P) +61 3 9464 4617



LEVEL 1 INSPECTION & TESTING REPORT 236 PAYNES ROAD – STAGE 3 THE THORNHILL GARDENS

Prepared for Winslow Constructors Pty Ltd

Report Reference: GS7855.1 AC

Date: 10 November 2025

ABN 31 105 704 078

13 Brock Street, Thomastown

Victoria 3074

(P) +61 3 9464 4617



PROJECT DETAILS

Project Reference	GS7855.1	Rev	AC
Project Title	236 Paynes Road – Stage 3, The Thornhill Gardens		
Project Location	Thornhill Park	State	VIC
Date	10 November 2025		

CLIENT DETAILS

Prepared For (Client)	Winslow Constructors Pty Ltd
Client Address	373 Brown Road, Officer, 3809

DISTRIBUTION

Original Held By	Ground Science Pty Ltd
One (1) Electronic Copy	Winslow Constructors Pty Ltd

This document presents the results of the Level 1 Inspection and Testing performed by Ground Science for the aforementioned project, as the nominated project Geotechnical Inspection & Testing Authority (GITA). This report is detailed for the sole use of the intended recipient(s). Should you have any questions related to this report please do not hesitate to contact the undersigned.

Author

Jamie Masters
Geotechnician
Ground Science Pty Ltd

Technical Review

Nathan Chow, RPEV, MIEAust, NER
Senior Geotechnical Engineer
Ground Science Pty Ltd

Co-Author

Alhasan Sumer, MIEAust
Geotechnical Engineer
Ground Science Pty Ltd

Table of Contents

1. INTRODUCTION	1
2. PROJECT BACKGROUND	1
3. SCOPE OF WORKS.....	1
3.1 AREAS & DURATION OF WORKS	1
3.2 PLACEMENT METHODOLOGY	1
4. INSPECTION AND TESTING RESULTS	2
4.1 SUBGRADE PREPARATION.....	2
4.2 FILL SOURCE MATERIALS	2
4.3 INSPECTION OF FILL SOURCE MATERIALS.....	2
4.3.1 MATERIAL SUITABILITY	2
4.3.2 BUILDING DEBRIS & VEGETATIVE MATTER	3
4.3.3 OVERSIZE PARTICLES	3
4.3.4 FILL MOISTURE	3
4.3.5 CONTAMINATION TESTING.....	3
4.4 FILL CONSTRUCTION	3
4.4.1 CLIMATE.....	3
4.4.2 FILLING PROCESS	3
4.5 COMPACTION CONTROL & MOISTURE TESTING RESULTS.....	4
4.6 FINAL SURFACE LEVELS	4
5. COMPLIANCE	4
6. UNDERSTANDING LEVEL 1 INSPECTION & TESTING AND THE ROLE OF A GITA	5
7. LIMITATIONS	6
8. REFERENCES	7

APPENDICES

APPENDIX A	FIELD DENSITY TEST SUMMARY
APPENDIX B	FIELD DENSITY TEST REPORT SHEETS & TEST LOCATIONS
APPENDIX C	SITE PHOTOGRAPHS

1. INTRODUCTION

This report presents the results of the Level 1 inspection activities, compaction control services and laboratory testing services performed by Ground Science for 236 Payne Road Stage 3 The Thornhill Gardens located in Thornhill Park, Victoria (the site).

2. PROJECT BACKGROUND

It is understood that the project involves the construction of fill platforms to support the proposed residential subdivision within Stage 3. Ground Science was engaged to provide Level 1 Inspection and Testing services for these components of the project. Authorisation to proceed was provided by Winslow Constructors Pty Ltd (the 'Client').

Level 1 Inspection & Testing, as defined in AS3798 (2007) 'Guidelines on Earthworks for Commercial and Residential Developments' provides for full time inspection of the construction of controlled fill and compaction testing in accordance with AS1289 'Methods of Testing Soils for Engineering Purposes' and AS1726 (2017) 'Geotechnical Site Investigations'. Ground Science performed the role of the project Geotechnical Inspection & Testing Authority (GITA) with all Level 1 Inspection and Testing services described in this report undertaken by an experienced GITA site representative.

3. SCOPE OF WORKS

3.1 AREAS & DURATION OF WORKS

The works generally involved the placement of controlled fill on the areas shown in **Appendix B**. This report details the Level 1 earthworks process performed on-site which commenced on 01 October 2024 and completed on 11 November 2024, requiring 18 days of on-site inspection and testing services. One additional day of testing was completed on 6th November 2025.

3.2 PLACEMENT METHODOLOGY

A technical specification or preceding geotechnical report was not provided. The placement of controlled fill on the above-mentioned areas was instructed to be carried out in general accordance with Level 1 Inspection & Testing fill procedures as detailed in Section 8.2 of AS3798 (2007) 'Guidelines on Earthworks for Commercial and Residential Developments' and previous experience. The fill placement methodology for the works involved:

1. preparing the base by stripping all loose surficial fill, topsoil, soft material, vegetation, and materials containing significant organic matter to expose the natural soil subgrade
2. sorting and mixing the fill materials to eliminate oversize particles greater than 20 % by volume, no particles coarser than 37.5 mm, and no particle over 200 mm in any dimension
3. placing engineered fill material in compacted horizontal layers of up to 200 mm
4. minimum dry density ratio of 95 % Standard Dry Density Ratio
5. completing field density testing at a frequency for large scale developments (Type 1 AS3798) which nominates a frequency of not less than:
 - one test per layer or 200 mm per 2500 m²
 - one test per 500 m³ distributed reasonably evenly throughout the full depth and area, or
 - three tests per site visit; whichever requires the most tests.

4. INSPECTION AND TESTING RESULTS

4.1 SUBGRADE PREPARATION

The subgrade preparation works involved the use of graders and scrapers to strip topsoil, loose/soft and unsuitable materials until a suitable natural subgrade was achieved.

The exposed subgrade was visually assessed using tactile methods described in AS1726 (2017) by the on-site GITA. The materials were observed to be naturally occurring residual soil deposits comprising Silty CLAY (CI-CH), medium to high plasticity, red brown, with varying proportions of sand and gravel inclusions.

The subgrade was also proof rolled using a loaded Moxy truck in the presence of the on-site GITA and subsequently test rolled, scarified and moisture conditioned. All areas were generally found to comply, with no visible signs of rutting, springing, or deflections.

4.2 FILL SOURCE MATERIALS

The fill material used was nominated by the on-site contractor, the material was inspected by the GITA and noted to be dry of the optimum moisture content. Table 1 summarises the fill source and general material properties:

Table 1: Fill Source & General Material Properties

Source & Location	General Material Description
Imported Material – Bluestone	Silty CLAY (CI-CH), medium to high plasticity, red/brown/grey
Imported Material – Westwood	Silty CLAY (CI-CH), medium to high plasticity, red/brown/grey
Imported Material – Fraser Rise	Gravelly CLAY (CL-CI), Low to medium plasticity, fine to coarse, brown
Imported Material – Massell	Gravelly CLAY (CL), Low plasticity, fine to coarse, with boulders, grey <u>Note: this material was assessed to contain significant amounts of rock cobbles and boulders and was deemed unsuitable for controlled fill use.</u>

4.3 INSPECTION OF FILL SOURCE MATERIALS

Ground Science performed an assessment of the fill source materials listed in Table 1 for the following:

1. identifying fill material suitability (engineering properties) including cohesion and composition
2. observing any building debris and vegetative matter (cleanliness) in the fill
3. distinguishing oversize rock particles
4. examining the fill moisture.

4.3.1 MATERIAL SUITABILITY

The fill materials were noted to be generally compliant with AS3798 Section 4.0 for the intent and purpose of general filling.

Visual/tactile assessments were conducted to identify the condition of the fill used. The fill materials generally comprised Silty / Gravelly CLAY (CL-CH), low to high plasticity, red / brown / grey, with varying proportions of sand and gravel.

Note: Imported Material from Massell was assessed to contain significant amounts of rock cobbles and boulders and was deemed unsuitable for controlled fill use. It is understood that this material did not form part of the controlled fill.

4.3.2 BUILDING DEBRIS & VEGETATIVE MATTER

No fill material containing building debris and/or vegetation matter was observed.

4.3.3 OVERSIZE PARTICLES

Some oversize particles were observed by the on-site GITA and rejected as unsuitable for use as level one fill.

4.3.4 FILL MOISTURE

The majority of the fill sources were assessed to be dry of the optimum moisture content. Portions of the fill material that were found to be dry of the of the optimum moisture content were moisture conditioned with a water cart truck prior and / or during placement.

4.3.5 CONTAMINATION TESTING

Ground Science did not perform any chemical or contamination analysis of the fill. The project contractor is responsible to ensure that the fill materials conform to the relevant EPA guidelines.

4.4 FILL CONSTRUCTION

The contractor had the following plant available on-site during the construction period for use in the fill placement;

1. water cart truck
2. compactor
3. bulldozer
4. excavator
5. graders
6. scrapers
7. highway and moxy trucks.

4.4.1 CLIMATE

During fill placement, the weather conditions were noted to be generally fine.

4.4.2 FILLING PROCESS

The filling process involved the following:

- compactor spreading fill material across the filling works area to form thin, loose layers
- watercart spraying the loose material to moisture condition and achieve a moisture close to the OMC
- compactor preformed 5 to 10 passes to compact the loose fill to 200 mm composite layer
- this process was repeated until the finished levels were achieved
- GITA performed representative nuclear density tests and samples across area of works.

It is considered that a 100 mm to 150 mm thick layer of topsoil would be spread at the completion of all works, which does not form part of the Level 1 process. Any fill placed as part of newly constructed drainage, sewer works, or similar does not form part of this Level 1 report.

4.5 COMPACTION CONTROL & MOISTURE TESTING RESULTS

Throughout the filling process and/or at the completion of the day's production, compaction control testing was performed to assess the achieved density ratio of each layer. The onsite GITA nominated the location and performed each test.

Testing comprised a total of 66 density tests using a nuclear moisture-density gauge and 66 rapid HILF compaction tests (AS1289 5.8.1 and AS1289 5.7.1).

The moisture variation was generally within $\pm 3\%$ of OMC.

Test location S1 to S4, S6 to S9 and S51 failed to meet the minimum target density ratio or the moisture variation. The failed test areas were re-worked and moisture conditioned and subsequently re-tested with passing results.

All other areas were generally found to achieve the minimum target density ratio of 95 % Standard Compaction.

A summary of the field density tests performed for the project is presented in **Appendix A**. Field density and compaction control testing report sheets and test locations are presented in **Appendix B**. It should be noted that the tests are a representation of the fill placed and support the visual assessment of the works completed. Site photographs are presented in **Appendix C**.

4.6 FINAL SURFACE LEVELS

Observations were made by a Ground Science staff member that filling had been completed up to the nominated finished levels as per confirmation provided by the contractor's site foreman. The observed final levels are the constructed finished surface levels of the controlled fill.

It should be noted that the overall fill depths are estimated using on-site visual tactile methods and may not be a true representation of fill depths given that conditions on-site may change over time. True fill depths should be obtained from the contractor's survey data.

5. COMPLIANCE

Ground Science Staff have undertaken Level 1 Inspection and Testing services of the construction of the controlled fill in the areas shown in **Appendix B**. Ground Science field staff have also observed that the prepared subgrade provided an adequate base for the subsequent placement of controlled fill.

Based on observations made by Ground Science staff and the results of density tests, we consider that the controlled fill placed within the areas inspected by the GITA, has been constructed in general accordance with the guidelines provided by AS3798 (2007).

The above compliance statement is applicable to the following lots within Stage 3:

- Lot 301, 306 to 313, Lot 314 to 324, Lot 325 to 344, and Superlot C.

The above compliance statement is NOT applicable to the following lots within Stage 3 due to no fill being present:

- Lot 302 to 305

It should be noted that the final fill layers may be subjected to adverse weather conditions resulting in either surface softening or drying and cracking over time; regardless of the compactive efforts and moisture conditioning applied during the works.

The integrity of the top 200 mm to 300 mm of the fill will deteriorate with time and should be taken into account by the foundation engineer prior to the construction of dwellings or buildings.

6. UNDERSTANDING LEVEL 1 INSPECTION & TESTING AND THE ROLE OF A GITA

The purpose of performing Level 1 Inspection and Testing is to ensure compliance of the fill with the specification.

The engagement of a Geotechnical Inspection Testing Authority (GITA) is provided to document the activities completed by the civil contractor and allows the contractor to perform their role in the construction of the filling operation while the GITA monitors the quality control process of the fill placement.

The visual observations of thorough processes and work practices by the contractor allows the GITA to approve the subsequent placement of fill without having to wait for the completion of testing and the extended time it takes to get a test result back.

The GITA will, however, carry out random spot checks of the filling operations throughout the day's production as confirmation that the placement procedures and the fill moisture content is appropriate. At the end of a day's production the GITA will sign off the completed works as satisfactory based on visual observations.

Any failed tests identified post the days production will result in that particular area of operation requiring rectification in the following activities. This may be as simple as extra rolling with compaction plant if moisture conditioning is suitable. Sometimes these areas may be retested if the GITA feels it is necessary.

While AS3798 (2007) is a guideline on the minimum requirements of filling on commercial and residential developments, some projects require a more detailed project specification to deal with site specific issues. While moisture conditioning of fill sources aids in the ease with which compaction is achieved, it is not necessarily a physical characteristic that determines if the placed fill is acceptable.

In some situations, the moisture requirement is an extremely important function of the final constructed product. In these situations, a specific project specification should apply to the project as detailed by the designing geotechnical engineer.

These are typical of clay liners for wet lands, dams, landfill liners and caps and an array of other engineering situations. Creating a consolidated platform of which is similar to equivalent surrounding natural conditions is the primary aim of level one processes and preventing the occurrence of differential ground movements to footing structures.

Level 1 Inspection & Testing requires full time inspection and testing of the fill placement undertaken on a site. Ground Science (project GITA), are notified daily (or at the completion of each day's work) by the project foreman where subsequent days of fill placement under Level 1 is to occur.

On projects that rely upon the importation of a fill source, there can be delays in the receipt of sufficient materials to warrant fill placement works which may result in periods of time where a GITA representative is not required on site.

It is the contractor's responsibility to notify the GITA when works proceed and their attendance on site is required again. A GITA relies upon the integrity of the contractor to advise when site attendance is required and makes all reasonable visual attempts to assess if the works are the same as the previous day's attendance.

Note: A GITA is not a site supervisor and does not instruct the construction team. Advice may be sought from the GITA, to assist with achieving compaction.

7. LIMITATIONS

This type of investigation (as per our commission) is not designed or capable of locating all soil conditions, (which can vary even over short distances). The advice given in this report is based on the assumption that the test results are representative of the overall soil conditions.

However, it should be noted that actual conditions in some parts of the Site might differ from those found. If further sampling reveals soil conditions significantly different from those shown in our findings, Ground Science must be consulted.

Maintenance and upkeep of finished fill placement must be regularly monitored as exposure to extended weather periods/other elements may cause surface drying which may lead to cracking. Conversely, excessive exposure to moisture may cause heaving/softening in the soils.

It is recognised that the passage of time affects the information and assessment provided in this document. Ground Science's assessment is based on information that existed at the time of the preparation of this document.

It is understood that the services provided allowed Ground Science to form no more than an opinion of the actual site conditions observed during sampling and observations of the site visit and cannot be used to assess the effects of any subsequent changes in the quality of the site, or its surroundings, or any laws or regulations.

The scope and the period of Ground Science services are described in the proposal and are subject to restrictions and limitations. Ground Science did not perform a complete assessment of all possible conditions or circumstances that may exist at the Site.

If a service is not expressly indicated, do not assume it has been provided. If a matter is not addressed, do not assume that any determination has been made by Ground Science in regards to it.

Where data has been supplied by the client or a third party, it is assumed that the information is correct unless otherwise stated. No responsibility is accepted by Ground Science for incomplete or inaccurate data supplied by others.

Any drawings or figures presented in this report should be considered only as pictorial evidence of our work. Therefore, unless otherwise stated, any dimensions should not be used for accurate calculations or dimensioning.

This document is COPYRIGHT- all rights reserved. No part of this document may be reproduced or copied in any form or by means without written permission by Ground Science Pty Ltd.

All other property in this submission shall not pass until all fees for preparation have been settled. This submission is for the use only of the party to whom it is addressed and for no other purpose.

No responsibility is accepted to any third party who may use or rely on the whole or any part of the content of this submission. No responsibility will be taken for this report if it is altered in any way, or not reproduced in full. This document remains the property of Ground Science Pty Ltd until all fees and monies have been paid in full.



GroundScience

8. REFERENCES

- AS3798 (2007) Guidelines on Earthworks for Residential and Commercial Developments
- AS1289 Methods of Testing Soils for Engineering Purposes
- AS1726 (2017): Geotechnical Site Investigations

APPENDIX A

Field Density Test Summary

Project Summary Report



Report Date: 10/11/2025
Client: Winslow Constructors Pty Ltd
 Lot 13, 6 Latchford Street, Cranbourne West VIC 3977
Contact: Raymond Lara
Project Number: GS7855/1
Project Name: 236 Paynes Road – Stage 3 (Level one)
Project Location: 236 Paynes Road
Specification: 95% Standard Compaction & +/- 3% Moisture Variation
Test Methods: AS 1289 5.7.1 STD & 5.8.1 & 2.1.1

Ground Science Pty Ltd
 Ground Science Laboratory
 13 Brock Street Thomastown Victoria 3074
 Phone: (03) 9464 4617
 Email: ernie@groundscience.com.au

Lot #	Sample #	Date Sampled	Location	Easting	Northing	Elevation (m)	Layer	Relative Compaction (%)	Moisture Variation (%)	Moisture Content (%)	Field Wet Density (t/m3)
**	78551-S1	01/10/2024	Lot 306	291109	5822129	**	1	99.5	4.5	16.3	1.92
**	78551-S2	01/10/2024	Lot 310	291073	5822135	**	1	100.5	4.0	17.3	1.90
**	78551-S3	01/10/2024	Lot 311	291060	5822135	**	1	101.5	2.5	19.5	1.93
**	78551-S6	04/10/2024	Lot 317	290993	5822232	**	1	92.0	3.0	10.0	1.77
**	78551-S7	04/10/2024	Lot 318	290981	5822239	**	1	100.0	4.0	17.6	1.94
**	78551-S8	04/10/2024	Lot 319	291020	5822302	**	1	98.0	5.0	18.8	1.81
**	78551-S9	04/10/2024	Lot 320	290988	5722244	**	1	88.5	2.5	19.6	1.72
**	78551-S10	04/10/2024	Retest #4	**	**	**	1	93.5	0.5	22.5	1.88
**	78551-S11	04/10/2024	Retest #1	**	**	**	1	102.5	3.0	21.7	1.96
**	78551-S12	04/10/2024	Retest #2	**	**	**	1	104.5	3.0	23.2	1.96
**	78551-S13	08/10/2024	Retest #6	**	**	**	1	105.5	3.0	19.1	2.01
**	78551-S14	08/10/2024	Retest #7	**	**	**	1	104.5	3.5	19.8	2.00
**	78551-S15	08/10/2024	Retest #8	**	**	**	1	101.5	2.5	20.1	1.96
**	78551-S16	09/10/2024	Lot 308	291081	5822139	**	2	101.5	1.5	19.9	1.99
**	78551-S17	09/10/2024	Lot 310	291060	5822153	**	2	100.5	2.5	18.1	1.99
**	78551-S18	09/10/2024	Lot 312	291045	5822151	**	2	101.0	2.5	14.8	2.00
**	78551-S19	09/10/2024	Retest #9	**	**	**	1	97.5	3.0	16.1	1.98
**	78551-S20	09/10/2024	Retest #10(4)	**	**	**	1	100.5	1.5	15.2	2.04
**	78551-S21	10/10/2024	Superlot C (East)	290991	5822148	**	1	96.5	0.5	22.3	1.96
**	78551-S22	10/10/2024	Superlot C (West)	290963	5822153	**	1	96.5	0.0	20.3	1.97
**	78551-S23	10/10/2024	Superlot C (Middle)	290889	5822152	**	1	100.5	1.0	22.6	2.03
**	78551-S4	10/10/2024	Lot 323	290994	5822301	**	1	89.0	2.0	14.1	1.84
**	78551-S5	10/10/2024	Lot 322	290992	5822289	**	1	99.0	2.0	15.0	2.00
**	78551-S24	11/10/2024	Retest S14(7)	**	**	**	1	95.5	-0.5	18.4	2.01
**	78551-S25	11/10/2024	Lot 318	290984	5822233	**	2	95.0	0.0	18.3	2.00
**	78551-S26	11/10/2024	Lot 319	290988	5822248	**	2	95.5	0.0	18.3	2.01
**	78551-S27	11/10/2024	Lot 311	291053	5822150	**	3	105.5	5.0	17.4	1.99
**	78551-S28	14/10/2024	Superlot C FUT901	0290878	5822154	**	2	97.5	-0.5	26.2	1.91
**	78551-S29	14/10/2024	Superlot C FUT902	0290891	5822156	**	2	96.5	0.0	23.5	1.91
**	78551-S30	14/10/2024	Superlot C FUT903	0290914	5822150	**	2	99.0	2.0	21.5	1.92
**	78551-S38	05/11/2024	Lot-322	0291051	5822265	**	1	95.0	-0.5	24.1	1.86
**	78551-S39	05/11/2024	Lot-320	0291048	5822254	**	1	97.0	2.5	23.0	1.84
**	78551-S40	05/11/2024	Lot-318	0291049	5822239	**	1	96.5	0.5	25.4	1.86
**	78551-S41	09/11/2024	Lot-339	0291181	5822228	**	1	95.5	-0.5	21.5	1.93
**	78551-S42	09/11/2024	Lot-340	0291178	5822213	**	1	97.0	1.5	20.2	1.94
**	78551-S43	09/11/2024	Lot-341	0291173	5822194	**	1	98.0	1.5	19.4	1.95
**	78551-S44	09/11/2024	Lot-342	0291179	5822175	**	1	97.0	0.5	22.1	1.92
**	78551-S45	09/11/2024	Lot-343	0291171	5822178	**	1	97.5	0.5	22.7	1.93
**	78551-S46	09/11/2024	Lot-344	0291165	5822181	**	1	99.0	0.5	20.6	1.96
**	78551-S47	11/11/2024	Lot-326	0291106	5822254	**	1	95.0	0.0	23.8	1.87
**	78551-S48	11/11/2024	Lot-328	0291095	5822237	**	1	95.5	-0.5	24.5	1.88
**	78551-S49	11/11/2024	Lot-336	0291137	5822217	**	1	95.0	1.0	21.5	1.86
**	78551-S50	11/11/2024	Lot-338	0291142	5822240	**	1	96.5	0.0	22.2	1.88
**	78551-S51	11/11/2024	Lot-335	0291139	5822205	**	1	93.0	-0.5	24.6	1.86
**	78551-S52	06/11/2025	Stage 3 Lot 314	291022	5822194	**	Final layer	95.5	3.0	17.8	1.94
**	78551-S53	06/11/2025	Stage 3 Lot 315	291035	5822194	**	Final layer	104.5	2.5	24.3	2.00
**	78551-S54	06/11/2025	Stage 3 Lot 316	291047	5822190	**	Final layer	101.5	2.5	20.3	1.95
**	78551-S55	06/11/2025	Stage 3 Lot 321	291059	5822257	**	Final layer	104.0	2.5	20.1	2.04
**	78551-S56	06/11/2025	Stage 3 Lot 330	291089	5822185	**	Final layer	104.5	3.0	20.6	2.00
**	78551-S57	06/11/2025	Stage 3 Lot 331	291100	5822182	**	Final layer	104.0	2.5	22.0	2.03
**	78551-S58	06/11/2025	Stage 3 Lot 332	291115	5822178	**	Final layer	99.5	2.5	21.1	1.92
**	78551-S59	06/11/2025	Stage 3 Lot 333	291121	5822181	**	Final layer	99.5	3.0	21.9	1.92
**	78551-S60	06/11/2025	Stage 3 Lot 334	291131	5822182	**	Final layer	101.5	3.0	21.2	1.95
**	78551-S61	06/11/2025	Stage 3 Lot 335 (Retest of S51)	291124	5822210	**	Final layer	99.0	3.0	18.6	1.93
**	78551-S62	06/11/2025	Stage 3 Lot 337	291130	5822235	**	Final layer	100.0	2.0	20.2	1.97
**	78551-S63	06/11/2025	Stage 3 Lot 313	291056	5822126	**	Final layer	101.0	3.0	24.1	1.91
**	78551-S64	06/11/2025	Stage 3 Lot 309	291085	5822140	**	Final layer	98.5	1.5	17.3	2.00
**	78551-S65	06/11/2025	Stage 3 Lot 307	291123	5822123	**	Final layer	98.5	2.5	21.1	1.96
**	78551-S66	06/11/2025	Stage 3 Lot 301	291191	5822131	**	Final layer	101.5	2.0	25.9	1.92

APPENDIX B

Field Density Test Report Sheets & Test Locations

Material Test Report



Report Number: GS7855/1-1
Issue Number: 1
Date Issued: 03/10/2024
Client: Winslow Constructors Pty Ltd
 Lot 13, 6 Latchford Street, Cranbourne West VIC 3977
Contact: Raymond Lara
Project Number: GS7855/1
Project Name: 236 Paynes Road – Stage 3(Level one)
Project Location: 236 Paynes Road
Work Request: 20368
Date Sampled: 01/10/2024 8:00
Dates Tested: 01/10/2024 - 03/10/2024
Sampling Method: AS 1289.1.2.1 6.4 (b) - Sampling from layers in earthworks or pavement - compacted
Specification: 95% Standard Compaction & +/- 3% Moisture Variation
Location: 236 Paynes Rd. Thornhill Park
Material: Silty CLAY, medium to high plasticity, red brown, grey
Material Source: Imported - Bluestone & Westwood Stg 11

Ground Science Pty Ltd
 Ground Science Laboratory
 13 Brock Street Thomastown Victoria 3074
 Phone: (03) 9464 4617
 Email: kallam@groundscience.com.au

Accredited for compliance with ISO/IEC 17025 - Testing



J. Collins

Approved Signatory: Kallam Collins
Laboratory 2IC

NATA Accredited Laboratory Number: 15055

Compaction Control AS 1289 5.7.1 & 5.8.1 & 2.1.1

Sample Number	78551-S1	78551-S2	78551-S3
Date Tested	01/10/2024	01/10/2024	01/10/2024
Time Tested	14:55	15:15	15:40
Test Request #/Location	Lot 306	Lot 310	Lot 311
Easting	291109	291073	291060
Northing	5822129	5822135	5822135
Layer / Reduced Level	1	1	1
Thickness of Layer (mm)	200	200	200
Soil Description	Silty CLAY, medium to high plasticity, red brown	Silty CLAY, medium to high plasticity, red brown	Silty CLAY, medium to high plasticity, red brown
Test Depth (mm)	175	175	175
Sieve used to determine oversize (mm)	19.0	19.0	19.0
Percentage of Wet Oversize (%)	4	4	1
Field Wet Density (FWD) t/m ³	1.92	1.90	1.93
Field Moisture Content %	16.3	17.3	19.5
Field Dry Density (FDD) t/m ³	1.65	1.62	1.61
Peak Converted Wet Density t/m ³	**	**	**
Adjusted Peak Converted Wet Density t/m ³	1.93	1.89	1.90
Moisture Variation (Wv) %	**	**	**
Adjusted Moisture Variation %	4.5	4.0	2.5
Hilf Density Ratio (%)	99.5	100.5	101.5
Compaction Method	Standard	Standard	Standard
Report Remarks	**	**	**

Moisture Variation Note:

Positive values = test is dry of OMC
 Negative values = test is wet of OMC

Sample Locations Plan

x - approximate test location

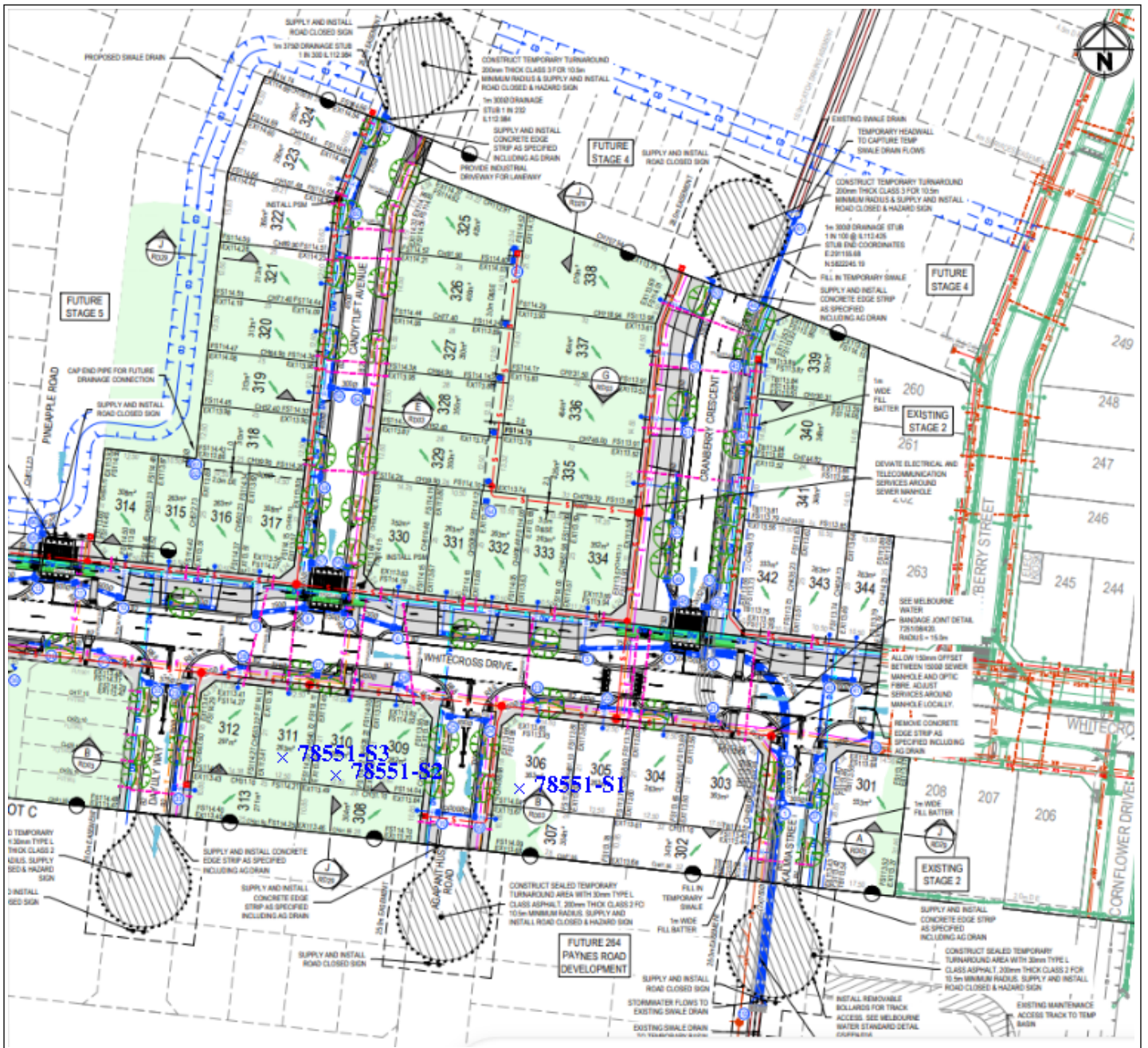

Material Test Report



Report Number: GS7855/1-2
Issue Number: 1
Date Issued: 07/10/2024
Client: Winslow Constructors Pty Ltd
 Lot 13, 6 Latchford Street, Cranbourne West VIC 3977
Contact: Raymond Lara
Project Number: GS7855/1
Project Name: 236 Paynes Road – Stage 3(Level one)
Project Location: 236 Paynes Road
Work Request: 20406
Date Sampled: 03/10/2024 8:00
Dates Tested: 03/10/2024 - 04/10/2024
Sampling Method: AS 1289.1.2.1 6.4 (b) - Sampling from layers in earthworks or pavement - compacted
Specification: 95% Standard Compaction & +/- 3% Moisture Variation
Location: 236 Paynes Rd. Thornhill Park
Material: Silty CLAY, medium to high plasticity, red brown/grey
Material Source: Imported - Bluestone & Westwood Stg 11

Ground Science Pty Ltd
 Ground Science Laboratory
 13 Brock Street Thomastown Victoria 3074
 Phone: (03) 9464 4617
 Email: kallam@groundscience.com.au

Accredited for compliance with ISO/IEC 17025 - Testing



J. Collins

Approved Signatory: Kallam Collins
Laboratory 21C

NATA Accredited Laboratory Number: 15055

Compaction Control AS 1289 5.7.1 & 5.8.1 & 2.1.1

Sample Number	78551-S4	78551-S5	
Date Tested	10/10/2024	10/10/2024	
Time Tested	14:41	14:48	
Test Request #/Location	Lot 323	Lot 322	
Easting	290994	290992	
Northing	5822301	5822289	
Layer / Reduced Level	1	1	
Thickness of Layer (mm)	200	200	
Soil Description	Silty CLAY, low to medium plasticity, brown	Silty CLAY, low to medium plasticity, brown	
Test Depth (mm)	175	175	
Sieve used to determine oversize (mm)	19.0	19.0	
Percentage of Wet Oversize (%)	4	7	
Field Wet Density (FWD) t/m ³	1.84	2.00	
Field Moisture Content %	14.1	15.0	
Field Dry Density (FDD) t/m ³	1.61	1.74	
Peak Converted Wet Density t/m ³	**	**	
Adjusted Peak Converted Wet Density t/m ³	2.06	2.02	
Moisture Variation (Wv) %	**	**	
Adjusted Moisture Variation %	2.0	2.0	
Hilf Density Ratio (%)	89.0	99.0	
Compaction Method	Standard	Standard	
Report Remarks	**	**	

Moisture Variation Note:

Positive values = test is dry of OMC
 Negative values = test is wet of OMC

Sample Locations Plan

x - approximate test location

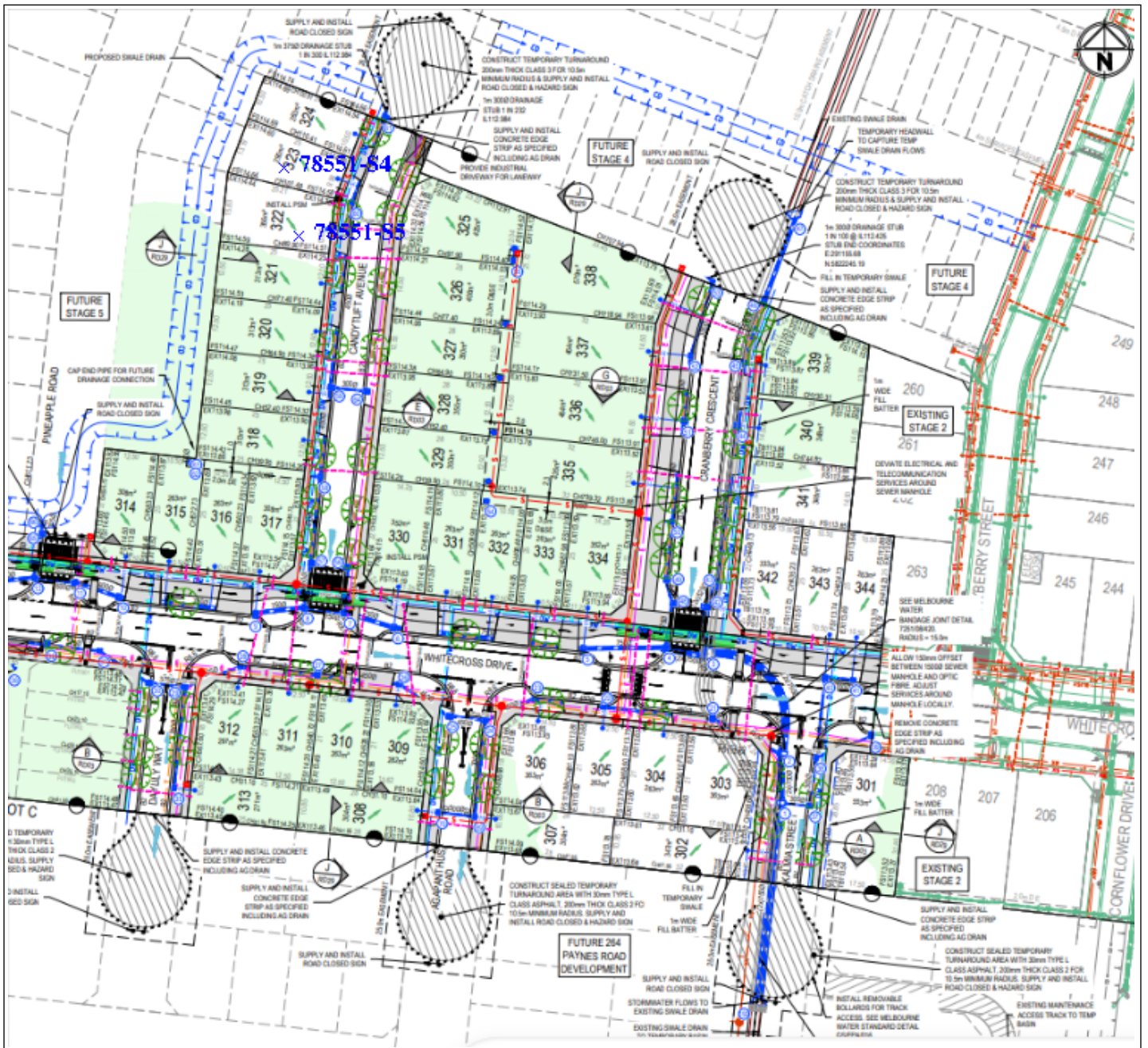

Material Test Report



Report Number: GS7855/1-3
Issue Number: 1
Date Issued: 07/10/2024
Client: Winslow Constructors Pty Ltd
 Lot 13, 6 Latchford Street, Cranbourne West VIC 3977
Contact: Raymond Lara
Project Number: GS7855/1
Project Name: 236 Paynes Road – Stage 3(Level one)
Project Location: 236 Paynes Road
Work Request: 20420
Date Sampled: 04/10/2024 8:00
Dates Tested: 04/10/2024 - 07/10/2024
Sampling Method: AS 1289.1.2.1 6.4 (b) - Sampling from layers in earthworks or pavement - compacted
Specification: 95% Standard Compaction & +/- 3% Moisture Variation
Location: 236 Paynes Road- Stage 3
Material: Silty CLAY, medium to high plasticity, brown
Material Source: Imported - Bluestone & Westwood Stg 11

Ground Science Pty Ltd
 Ground Science Laboratory
 13 Brock Street Thomastown Victoria 3074
 Phone: (03) 9464 4617
 Email: kallam@groundscience.com.au



Accredited for compliance with ISO/IEC 17025 - Testing

J. Collins

Approved Signatory: Kallam Collins
Laboratory 21C

NATA Accredited Laboratory Number: 15055

Compaction Control AS 1289 5.7.1 & 5.8.1 & 2.1.1

Sample Number	78551-S6	78551-S7	78551-S8	78551-S9
Date Tested	04/10/2024	04/10/2024	04/10/2024	04/10/2024
Time Tested	12:39	12:45	12:48	12:52
Test Request #/Location	Lot 317	Lot 318	Lot 319	Lot 320
Easting	290993	290981	291020	290988
Northing	5822232	5822239	5822302	5722244
Layer / Reduced Level	1	1	1	1
Thickness of Layer (mm)	200	200	200	200
Soil Description	Silty CLAY, medium to high plasticity, brown	Silty CLAY, medium to high plasticity, brown	Silty CLAY, medium to high plasticity, brown	Silty CLAY, medium to high plasticity, brown
Test Depth (mm)	175	175	175	175
Sieve used to determine oversize (mm)	19.0	19.0	19.0	19.0
Percentage of Wet Oversize (%)	3	4	6	5
Field Wet Density (FWD) t/m ³	1.77	1.94	1.81	1.72
Field Moisture Content %	10.0	17.6	18.8	19.6
Field Dry Density (FDD) t/m ³	1.61	1.65	1.53	1.43
Peak Converted Wet Density t/m ³	**	**	**	**
Adjusted Peak Converted Wet Density t/m ³	1.92	1.94	1.85	1.94
Moisture Variation (Wv) %	**	**	**	**
Adjusted Moisture Variation %	3.0	4.0	5.0	2.5
Hilf Density Ratio (%)	92.0	100.0	98.0	88.5
Compaction Method	Standard	Standard	Standard	Standard
Report Remarks	**	**	**	**

Moisture Variation Note:

Positive values = test is dry of OMC
 Negative values = test is wet of OMC

Material Test Report



Report Number: GS7855/1-3
Issue Number: 1
Date Issued: 07/10/2024
Client: Winslow Constructors Pty Ltd
 Lot 13, 6 Latchford Street, Cranbourne West VIC 3977
Contact: Raymond Lara
Project Number: GS7855/1
Project Name: 236 Paynes Road – Stage 3(Level one)
Project Location: 236 Paynes Road
Work Request: 20420
Date Sampled: 04/10/2024 8:00
Dates Tested: 04/10/2024 - 07/10/2024
Sampling Method: AS 1289.1.2.1 6.4 (b) - Sampling from layers in earthworks or pavement - compacted
Specification: 95% Standard Compaction & +/- 3% Moisture Variation
Location: 236 Paynes Road- Stage 3
Material: Silty CLAY, medium to high plasticity, brown
Material Source: Imported - Bluestone & Westwood Stg 11

Ground Science Pty Ltd
 Ground Science Laboratory
 13 Brock Street Thomastown Victoria 3074
 Phone: (03) 9464 4617
 Email: kallam@groundscience.com.au

Accredited for compliance with ISO/IEC 17025 - Testing



J. Collins

Approved Signatory: Kallam Collins
Laboratory 21C

NATA Accredited Laboratory Number: 15055

Compaction Control AS 1289 5.7.1 & 5.8.1 & 2.1.1

Sample Number	78551-S10	78551-S11	78551-S12	
Date Tested	04/10/2024	04/10/2024	04/10/2024	
Time Tested	12:55	13:37	13:40	
Test Request #/Location	Retest #4	Retest #1	Retest #2	
Easting	**	**	**	
Northing	**	**	**	
Layer / Reduced Level	1	1	1	
Thickness of Layer (mm)	200	200	200	
Soil Description	Silty CLAY, medium to high plasticity, brown	Silty CLAY, medium to high plasticity, brown	Silty CLAY, medium to high plasticity, brown	
Test Depth (mm)	175	175	175	
Sieve used to determine oversize (mm)	19.0	19.0	19.0	
Percentage of Wet Oversize (%)	3	0	0	
Field Wet Density (FWD) t/m ³	1.88	1.96	1.96	
Field Moisture Content %	22.5	21.7	23.2	
Field Dry Density (FDD) t/m ³	1.53	1.61	1.59	
Peak Converted Wet Density t/m ³	**	1.91	1.88	
Adjusted Peak Converted Wet Density t/m ³	2.01	**	**	
Moisture Variation (Wv) %	**	3.0	3.0	
Adjusted Moisture Variation %	0.5	**	**	
Hilf Density Ratio (%)	93.5	102.5	104.5	
Compaction Method	Standard	Standard	Standard	
Report Remarks	**	**	**	

Moisture Variation Note:

Positive values = test is dry of OMC

Negative values = test is wet of OMC

Sample Locations Plan

x - approximate test location

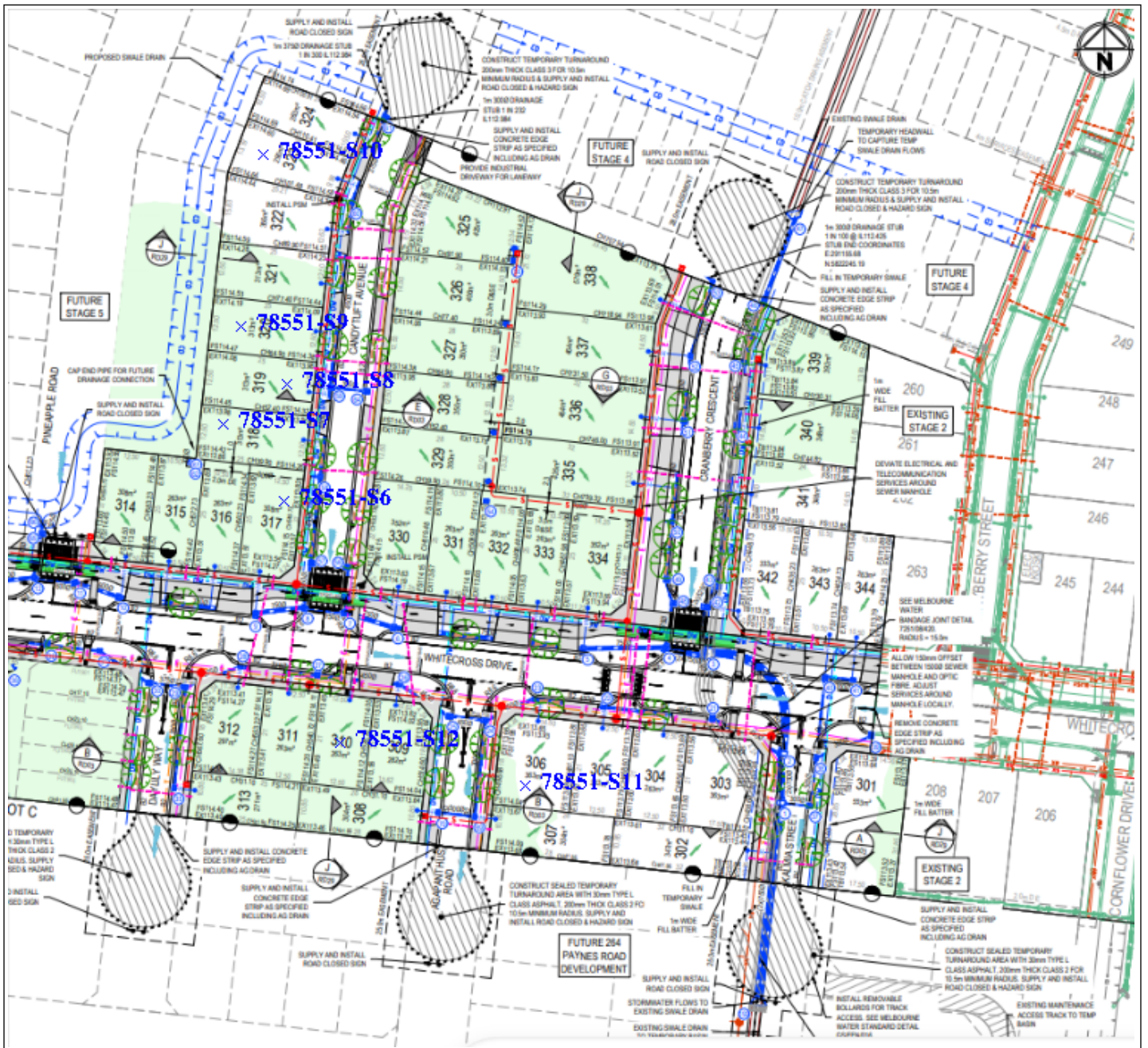

Material Test Report



Report Number: GS7855/1-4
Issue Number: 1
Date Issued: 10/10/2024
Client: Winslow Constructors Pty Ltd
 Lot 13, 6 Latchford Street, Cranbourne West VIC 3977
Contact: Raymond Lara
Project Number: GS7855/1
Project Name: 236 Paynes Road – Stage 3(Level one)
Project Location: 236 Paynes Road
Work Request: 20455
Date Sampled: 08/10/2024 08:00
Dates Tested: 08/10/2024 - 10/10/2024
Sampling Method: AS 1289.1.2.1 6.4 (b) - Sampling from layers in earthworks or pavement - compacted
Specification: 95% Standard Compaction & +/- 3% Moisture Variation
Location: 236 Paynes Road - Stage 3
Material: Silty CLAY, medium to high plasticity, brown
Material Source: Imported - Westwood Stg 11

Ground Science Pty Ltd
 Ground Science Laboratory
 13 Brock Street Thomastown Victoria 3074
 Phone: (03) 9464 4617
 Email: kallam@groundscience.com.au

Accredited for compliance with ISO/IEC 17025 - Testing



J. Collins

Approved Signatory: Kallam Collins
Laboratory 21C

NATA Accredited Laboratory Number: 15055

Compaction Control AS 1289 5.7.1 & 5.8.1 & 2.1.1

Sample Number	78551-S13	78551-S14	78551-S15
Date Tested	08/10/2024	08/10/2024	08/10/2024
Time Tested	14:38	14:44	14:50
Test Request #/Location	Retest #6	Retest #7	Retest #8
Layer / Reduced Level	1	1	1
Thickness of Layer (mm)	200	200	200
Soil Description	Silty CLAY, medium to high plasticity, brown	Silty CLAY, medium to high plasticity, brown	Silty CLAY, medium to high plasticity, brown
Test Depth (mm)	175	175	175
Sieve used to determine oversize (mm)	19.0	19.0	19.0
Percentage of Wet Oversize (%)	7	6	2
Field Wet Density (FWD) t/m ³	2.01	2.00	1.96
Field Moisture Content %	19.1	19.8	20.1
Field Dry Density (FDD) t/m ³	1.69	1.67	1.63
Peak Converted Wet Density t/m ³	**	**	**
Adjusted Peak Converted Wet Density t/m ³	1.90	1.91	1.94
Moisture Variation (Wv) %	**	**	**
Adjusted Moisture Variation %	3.0	3.5	2.5
Hilf Density Ratio (%)	105.5	104.5	101.5
Compaction Method	Standard	Standard	Standard
Report Remarks	**	**	**

Moisture Variation Note:

Positive values = test is dry of OMC

Negative values = test is wet of OMC

Material Test Report



Report Number: GS7855/1-5
Issue Number: 1
Date Issued: 11/10/2024
Client: Winslow Constructors Pty Ltd
 Lot 13, 6 Latchford Street, Cranbourne West VIC 3977
Contact: Raymond Lara
Project Number: GS7855/1
Project Name: 236 Paynes Road – Stage 3 (Level one)
Project Location: 236 Paynes Road
Work Request: 20491
Date Sampled: 09/10/2024 08:00
Dates Tested: 09/10/2024 - 11/10/2024
Sampling Method: AS 1289.1.2.1 6.4 (b) - Sampling from layers in earthworks or pavement - compacted
Specification: 95% Standard Compaction & +/- 3% Moisture Variation
Location: 236 Paynes Road - Stage 3
Material: Silty CLAY, medium to high plasticity, brown
Material Source: Imported Westwood Stg 11

Ground Science Pty Ltd
 Ground Science Laboratory
 13 Brock Street Thomastown Victoria 3074
 Phone: (03) 9464 4617
 Email: kallam@groundscience.com.au

Accredited for compliance with ISO/IEC 17025 - Testing



K. Collins

Approved Signatory: Kallam Collins
Laboratory 21C

NATA Accredited Laboratory Number: 15055

Compaction Control AS 1289 5.7.1 & 5.8.1 & 2.1.1					
Sample Number	78551-S16	78551-S17	78551-S18	78551-S19	78551-S20
Date Tested	09/10/2024	09/10/2024	09/10/2024	09/10/2024	09/10/2024
Time Tested	12:20	12:26	12:32	14:14	14:20
Test Request #/Location	Lot 308	Lot 310	Lot 312	Retest #9	Retest #10(4)
Easting	291081	291060	291045	**	**
Northing	5822139	5822153	5822151	**	**
Layer / Reduced Level	2	2	2	1	1
Thickness of Layer (mm)	200	200	200	200	200
Soil Description	Silty CLAY, medium to high plasticity, brown	Silty CLAY, medium to high plasticity, brown	Silty CLAY, medium to high plasticity, brown	Silty CLAY, medium to high plasticity, brown	Silty CLAY, medium to high plasticity, brown
Test Depth (mm)	175	175	175	175	175
Sieve used to determine oversize (mm)	19.0	19.0	19.0	19.0	19.0
Percentage of Wet Oversize (%)	7	8	12	3	3
Field Wet Density (FWD) t/m ³	1.99	1.99	2.00	1.98	2.04
Field Moisture Content %	19.9	18.1	14.8	16.1	15.2
Field Dry Density (FDD) t/m ³	1.66	1.68	1.75	1.71	1.77
Peak Converted Wet Density t/m ³	**	**	**	**	**
Adjusted Peak Converted Wet Density t/m ³	1.95	1.97	1.98	2.03	2.03
Moisture Variation (Wv) %	**	**	**	**	**
Adjusted Moisture Variation %	1.5	2.5	2.5	3.0	1.5
Hilf Density Ratio (%)	101.5	100.5	101.0	97.5	100.5
Compaction Method	Standard	Standard	Standard	Standard	Standard
Report Remarks	**	**	**	**	**

Moisture Variation Note:

Positive values = test is dry of OMC
 Negative values = test is wet of OMC

Sample Locations Plan

x - approximate test location

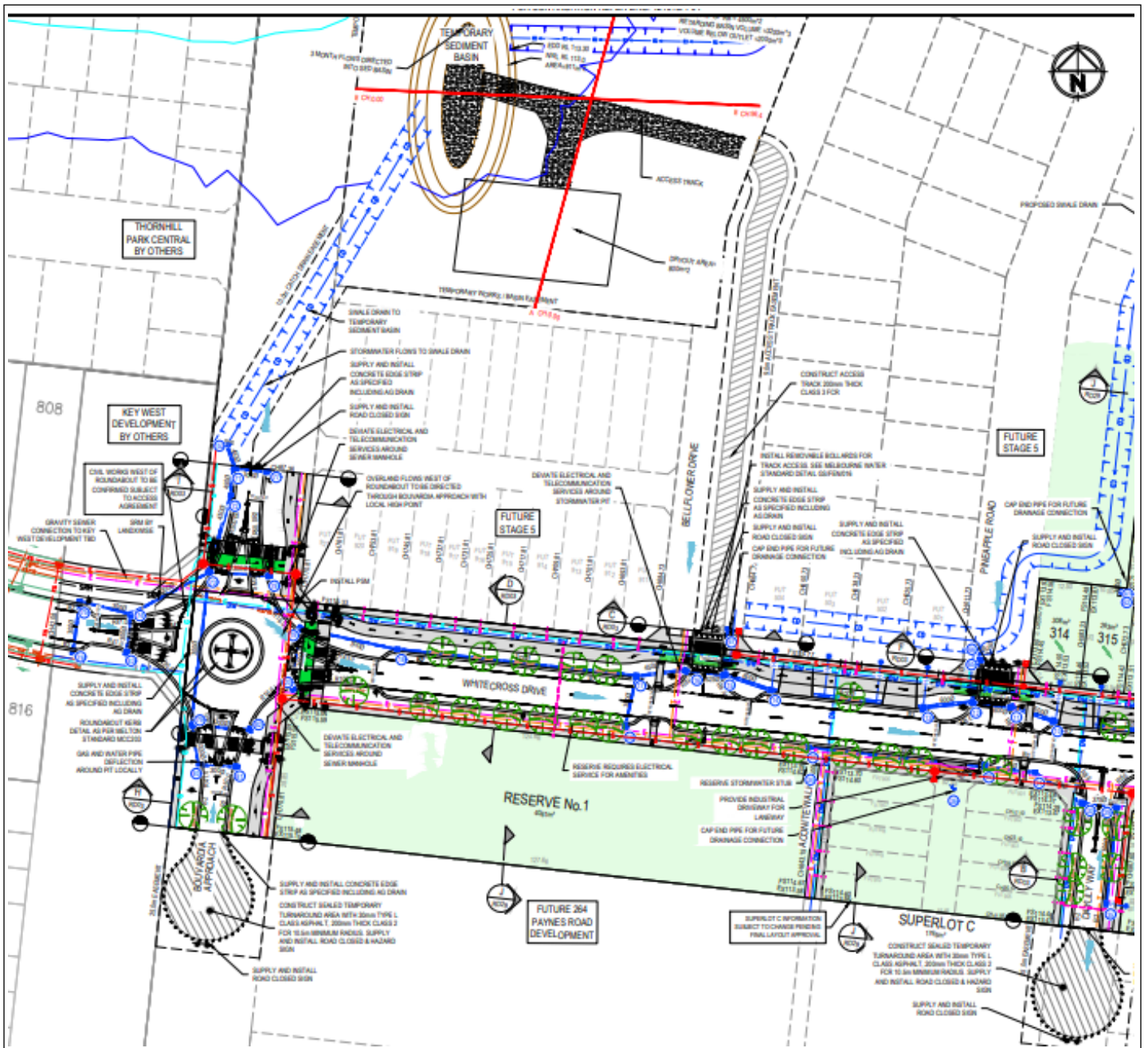

Material Test Report



Report Number: GS7855/1-6
Issue Number: 1
Date Issued: 14/10/2024
Client: Winslow Constructors Pty Ltd
 Lot 13, 6 Latchford Street, Cranbourne West VIC 3977
Contact: Raymond Lara
Project Number: GS7855/1
Project Name: 236 Paynes Road – Stage 3 (Level one)
Project Location: 236 Paynes Road
Work Request: 20537
Date Sampled: 11/10/2024
Dates Tested: 11/10/2024 - 14/10/2024
Sampling Method: AS 1289.1.2.1 6.4 (b) - Sampling from layers in earthworks or pavement - compacted
Specification: 95% Standard Compaction & +/- 3% Moisture Variation
Location: 236 Paynes Road - Stage 3
Material: Silty CLAY, medium to high plasticity, brown
Material Source: Imported Westwood Stg 11

Ground Science Pty Ltd
 Ground Science Laboratory
 13 Brock Street Thomastown Victoria 3074
 Phone: (03) 9464 4617
 Email: kallam@groundscience.com.au

Accredited for compliance with ISO/IEC 17025 - Testing



K. Collins

Approved Signatory: Kallam Collins
Laboratory 21C

NATA Accredited Laboratory Number: 15055

Compaction Control AS 1289 5.7.1 & 5.8.1 & 2.1.1				
Sample Number	78551-S24	78551-S25	78551-S26	78551-S27
Date Tested	11/10/2024	11/10/2024	11/10/2024	11/10/2024
Time Tested	14:10	14:20	14:30	14:40
Test Request #/Location	Retest S14(7)	Lot 318	Lot 319	Lot 311
Easting	**	290984	290988	291053
Northing	**	5822233	5822248	5822150
Layer / Reduced Level	1	2	2	3
Thickness of Layer (mm)	200	200	200	200
Soil Description	Silty CLAY, medium to high plasticity, brown	Silty CLAY, medium to high plasticity, brown	Silty CLAY, medium to high plasticity, brown	Silty CLAY, medium to high plasticity, brown
Test Depth (mm)	175	175	175	175
Sieve used to determine oversize (mm)	19.0	19.0	19.0	19.0
Percentage of Wet Oversize (%)	7	10	12	7
Field Wet Density (FWD) t/m ³	2.01	2.00	2.01	1.99
Field Moisture Content %	18.4	18.3	18.3	17.4
Field Dry Density (FDD) t/m ³	1.70	1.69	1.70	1.70
Peak Converted Wet Density t/m ³	**	**	**	**
Adjusted Peak Converted Wet Density t/m ³	2.11	2.10	2.11	1.89
Moisture Variation (Wv) %	**	**	**	**
Adjusted Moisture Variation %	-0.5	0.0	0.0	5.0
Hilf Density Ratio (%)	95.5	95.0	95.5	105.5
Compaction Method	Standard	Standard	Standard	Standard
Report Remarks	**	**	**	**

Moisture Variation Note:

Positive values = test is dry of OMC
 Negative values = test is wet of OMC

Sample Locations Plan

x - approximate test location

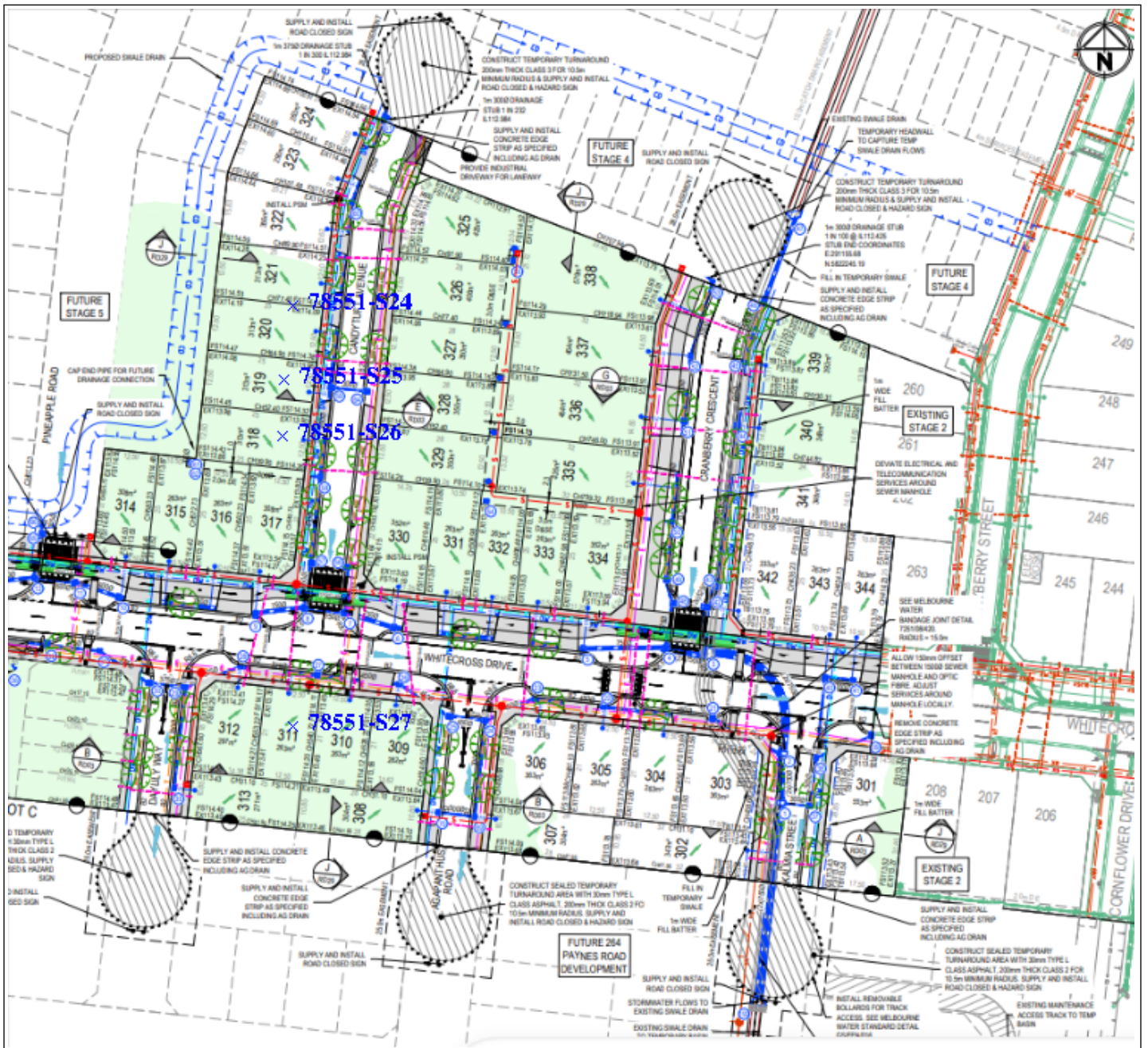

Material Test Report



Report Number: GS7855/1-7
Issue Number: 1
Date Issued: 14/10/2024
Client: Winslow Constructors Pty Ltd
Lot 13, 6 Latchford Street, Cranbourne West VIC 3977
Contact: Raymond Lara
Project Number: GS7855/1
Project Name: 236 Paynes Road – Stage 3 (Level one)
Project Location: 236 Paynes Road
Work Request: 20511
Date Sampled: 10/10/2024
Dates Tested: 10/10/2024 - 14/10/2024
Sampling Method: AS 1289.1.2.1 6.4 (b) - Sampling from layers in earthworks or pavement - compacted
Specification: 95% Standard Compaction & +/- 3% Moisture Variation
Location: 236 Paynes Road - Stage 3
Material: Silty CLAY, medium to high plasticity, brown
Material Source: Imported Westwood Stg 11

Ground Science Pty Ltd
Ground Science Laboratory
13 Brock Street Thomastown Victoria 3074
Phone: (03) 9464 4617
Email: kallam@groundscience.com.au

Accredited for compliance with ISO/IEC 17025 - Testing



Approved Signatory: Kallam Collins
Laboratory 21C

NATA Accredited Laboratory Number: 15055

Compaction Control AS 1289 5.7.1 & 5.8.1 & 2.1.1

Sample Number	78551-S21	78551-S22	78551-S23
Date Tested	10/10/2024	10/10/2024	10/10/2024
Time Tested	11:30	11:36	14:18
Test Request #/Location	Superlot C (East)	Superlot C (West)	Superlot C (Middle)
Easting	290991	290963	290889
Northing	5822148	5822153	5822152
Layer / Reduced Level	1	1	1
Thickness of Layer (mm)	200	200	200
Soil Description	Silty CLAY, medium to high plasticity, brown	Silty CLAY, medium to high plasticity, brown	Silty CLAY, medium to high plasticity, brown
Test Depth (mm)	175	175	175
Sieve used to determine oversize (mm)	19.0	19.0	19.0
Percentage of Wet Oversize (%)	16	10	10
Field Wet Density (FWD) t/m ³	1.96	1.97	2.03
Field Moisture Content %	22.3	20.3	22.6
Field Dry Density (FDD) t/m ³	1.60	1.64	1.65
Peak Converted Wet Density t/m ³	**	**	**
Adjusted Peak Converted Wet Density t/m ³	2.03	2.04	2.02
Moisture Variation (Wv) %	**	**	**
Adjusted Moisture Variation %	0.5	0.0	1.0
Hilf Density Ratio (%)	96.5	96.5	100.5
Compaction Method	Standard	Standard	Standard
Report Remarks	**	**	**

Moisture Variation Note:

Positive values = test is dry of OMC
Negative values = test is wet of OMC

Sample Locations Plan

x - approximate test location

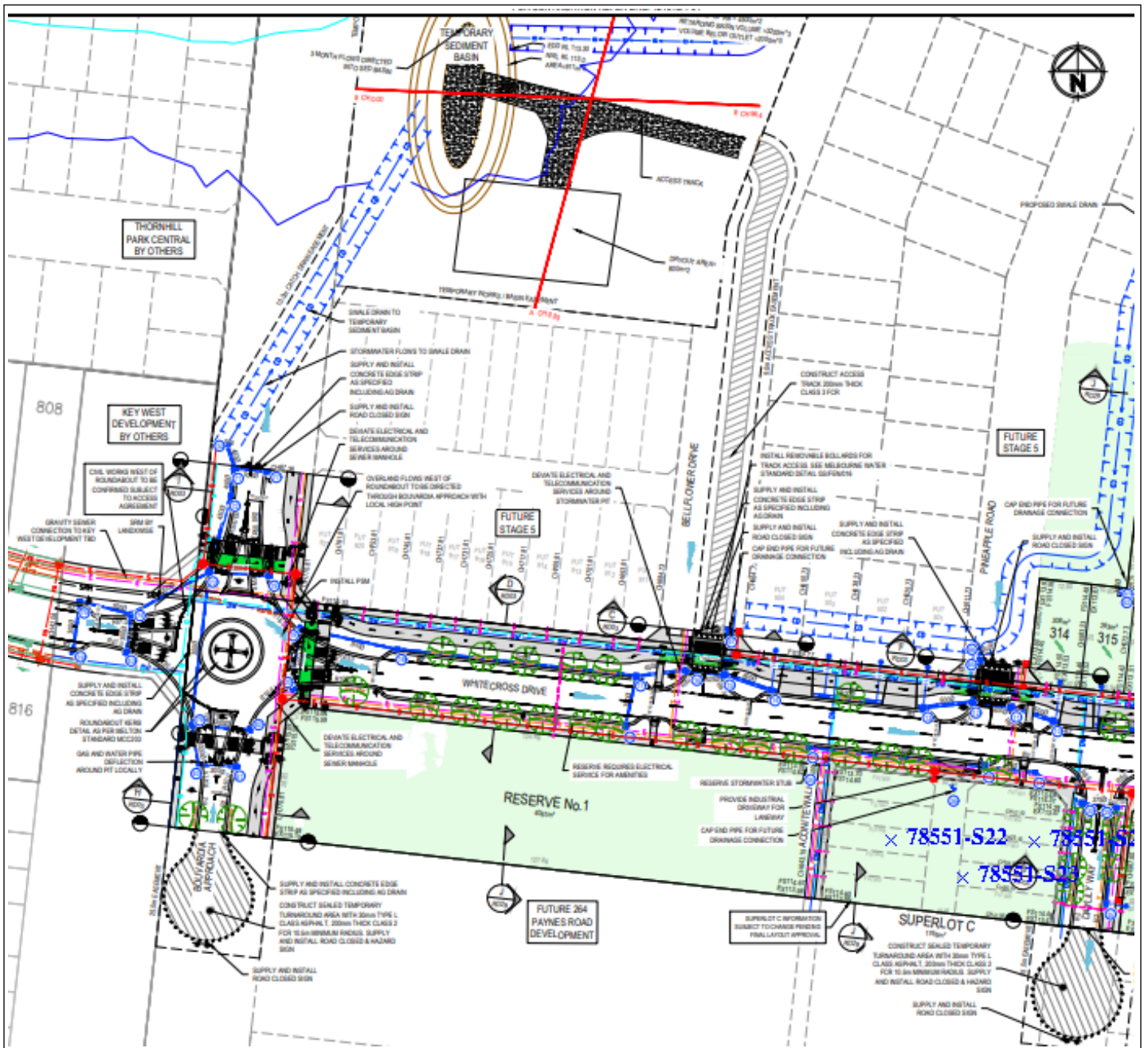

Material Test Report



Report Number: GS7855/1-8
Issue Number: 1
Date Issued: 19/10/2024
Client: Winslow Constructors Pty Ltd
 Lot 13, 6 Latchford Street, Cranbourne West VIC 3977
Contact: Raymond Lara
Project Number: GS7855/1
Project Name: 236 Paynes Road – Stage 3 (Level one)
Project Location: 236 Paynes Road
Work Request: 20605
Date Sampled: 15/10/2024
Dates Tested: 15/10/2024 - 18/10/2024
Sampling Method: AS 1289.1.2.1 6.4 (b) - Sampling from layers in earthworks or pavement - compacted
Specification: 95% Standard Compaction & +/- 3% Moisture Variation
Site Selection: Selected by Client
Location: Thornhill Vic
Material: Silty CLAY, medium to high plasticity, brown
Material Source: Imported Westwood Stg 11 Fraser rise

Ground Science Pty Ltd
 Ground Science Laboratory
 13 Brock Street Thomastown Victoria 3074
 Phone: (03) 9464 4617
 Email: tim@groundscience.com.au

Accredited for compliance with ISO/IEC 17025 - Testing



Approved Signatory: Tim Senserrick
Laboratory Manager

NATA Accredited Laboratory Number: 15055

Compaction Control AS 1289 5.7.1 & 5.8.1 & 2.1.1					
Sample Number	78551-S31	78551-S32	78551-S33	78551-S34	78551-S35
Date Tested	15/10/2024	15/10/2024	15/10/2024	15/10/2024	15/10/2024
Time Tested	14:11	14:17	14:23	14:30	14:37
Test Request #/Location	Lot-325	Lot-327	Lot-329	Lot-335	Lot-336
Easting	0290974	0290969	0290960	0290991	0291005
Northing	5822301	5822279	5822234	5822228	5822270
Layer / Reduced Level	3	3	3	3	3
Thickness of Layer (mm)	200	200	200	200	200
Soil Description	Silty CLAY, medium to high plasticity, brown	Silty CLAY, medium to high plasticity, brown	Silty CLAY, medium to high plasticity, brown	Silty CLAY, medium to high plasticity, brown	Silty CLAY, medium to high plasticity, brown
Test Depth (mm)	175	175	175	175	175
Sieve used to determine oversize (mm)	19.0	19.0	19.0	19.0	19.0
Percentage of Wet Oversize (%)	2	7	5	5	2
Field Wet Density (FWD) t/m ³	1.96	1.97	1.92	1.97	1.98
Field Moisture Content %	20.3	20.3	19.0	22.1	22.0
Field Dry Density (FDD) t/m ³	1.63	1.64	1.61	1.61	1.62
Peak Converted Wet Density t/m ³	**	**	**	**	**
Adjusted Peak Converted Wet Density t/m ³	2.08	2.06	2.04	2.06	2.04
Moisture Variation (Wv) %	**	**	**	**	**
Adjusted Moisture Variation %	-0.5	-0.5	0.5	0.0	-0.5
Hilf Density Ratio (%)	95.0	96.0	95.0	95.5	97.0
Compaction Method	Standard	Standard	Standard	Standard	Standard
Report Remarks	**	**	**	**	**

Moisture Variation Note:

Positive values = test is dry of OMC
 Negative values = test is wet of OMC

Sample Locations Plan

x - approximate test location

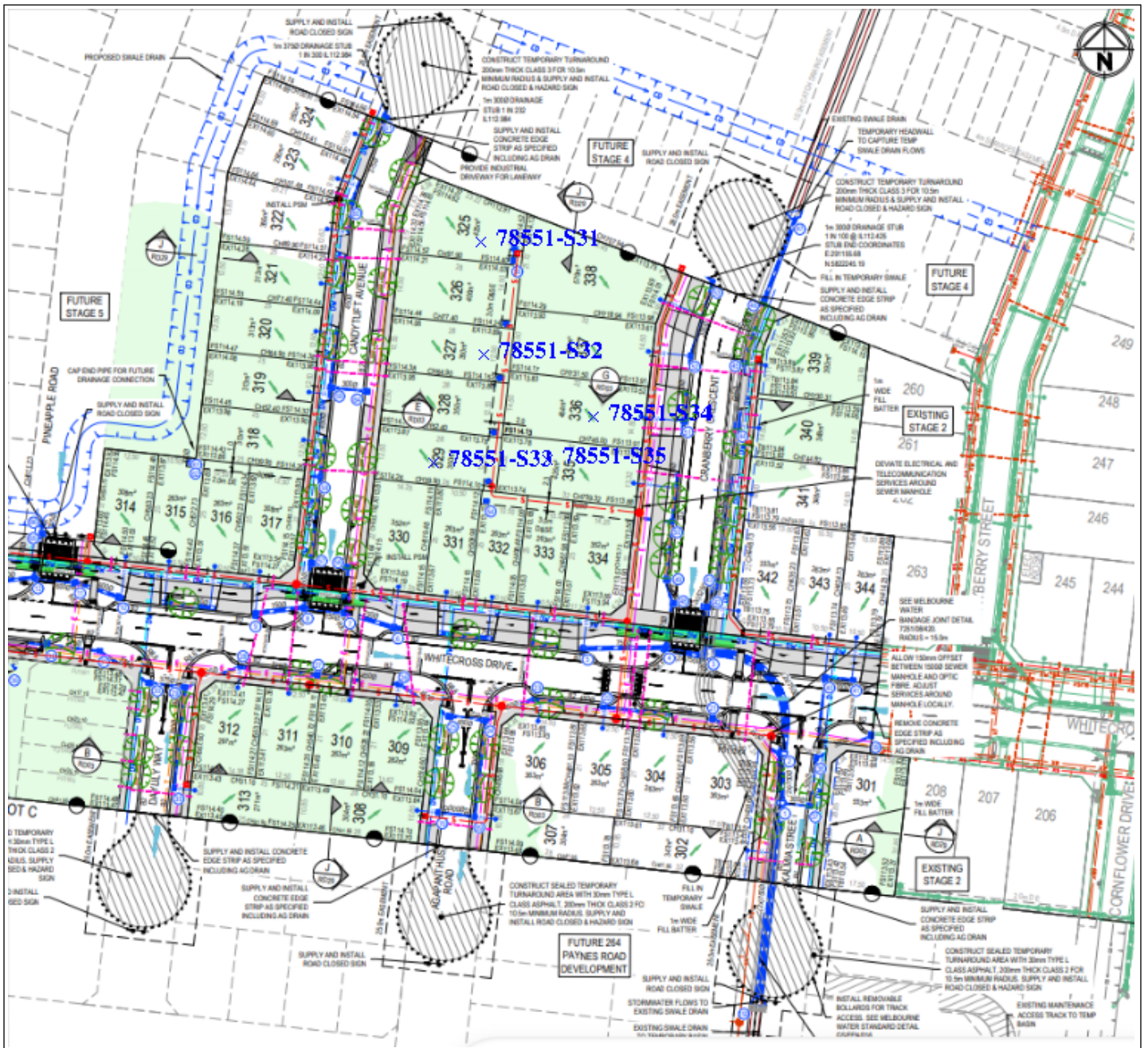

Material Test Report



Report Number: GS7855/1-9
Issue Number: 1
Date Issued: 21/10/2024
Client: Winslow Constructors Pty Ltd
 Lot 13, 6 Latchford Street, Cranbourne West VIC 3977
Contact: Raymond Lara
Project Number: GS7855/1
Project Name: 236 Paynes Road – Stage 3 (Level one)
Project Location: 236 Paynes Road
Work Request: 20572
Date Sampled: 14/10/2024 8:00
Dates Tested: 14/10/2024 - 18/10/2024
Sampling Method: AS 1289.1.2.1 6.4 (b) - Sampling from layers in earthworks or pavement - compacted
Location: Thornhill Vic
Material: Silty CLAY, medium to high plasticity, brown
Material Source: Imported Westwood Stg 11 Fraser rise

Ground Science Pty Ltd
 Ground Science Laboratory
 13 Brock Street Thomastown Victoria 3074
 Phone: (03) 9464 4617
 Email: kallam@groundscience.com.au



Accredited for compliance with ISO/IEC 17025 - Testing

J. Collins

Approved Signatory: Kallam Collins
Laboratory 21C

NATA Accredited Laboratory Number: 15055

Compaction Control AS 1289 5.7.1 & 5.8.1 & 2.1.1

Sample Number	78551-S28	78551-S29	78551-S30
Date Tested	14/10/2024	14/10/2024	14/10/2024
Time Tested	12:17	12:26	12:32
Test Request #/Location	Superlot C FUT901	Superlot C FUT902	Superlot C FUT903
Easting	0290878	0290891	0290914
Northing	5822154	5822156	5822150
Layer / Reduced Level	2	2	2
Thickness of Layer (mm)	200	200	200
Soil Description	Silty CLAY, low to medium plasticity, brown	Silty CLAY, low to medium plasticity, brown	Silty CLAY, low to medium plasticity, brown
Test Depth (mm)	175	175	175
Sieve used to determine oversize (mm)	19.0	19.0	19.0
Percentage of Wet Oversize (%)	0	2	2
Field Wet Density (FWD) t/m ³	1.91	1.91	1.92
Field Moisture Content %	26.2	23.5	21.5
Field Dry Density (FDD) t/m ³	1.51	1.55	1.58
Peak Converted Wet Density t/m ³	1.95	**	**
Adjusted Peak Converted Wet Density t/m ³	**	1.98	1.94
Moisture Variation (Wv) %	-0.5	**	**
Adjusted Moisture Variation %	**	0.0	2.0
Hilf Density Ratio (%)	97.5	96.5	99.0
Compaction Method	Standard	Standard	Standard
Report Remarks	**	**	**

Moisture Variation Note:

Positive values = test is dry of OMC

Negative values = test is wet of OMC

Material Test Report



Report Number: GS7855/1-10
Issue Number: 1
Date Issued: 31/10/2024
Client: Winslow Constructors Pty Ltd
 Lot 13, 6 Latchford Street, Cranbourne West VIC 3977
Contact: Raymond Lara
Project Number: GS7855/1
Project Name: 236 Paynes Road – Stage 3 (Level one)
Project Location: 236 Paynes Road
Work Request: 20898
Date Sampled: 28/10/2024
Dates Tested: 28/10/2024 - 30/10/2024
Sampling Method: AS 1289.1.2.1 6.4 (b) - Sampling from layers in earthworks or pavement - compacted
Specification: 95% Standard Compaction & +/- 3% Moisture Variation
Location: Thornhill Park
Material: Silty CLAY, medium to high plasticity, brown
Material Source: Important Westwood stage 11 Fraser rise.

Ground Science Pty Ltd
 Ground Science Laboratory
 13 Brock Street Thomastown Victoria 3074
 Phone: (03) 9464 4617
 Email: kallam@groundscience.com.au



Accredited for compliance with ISO/IEC 17025 - Testing

J. Collins

Approved Signatory: Kallam Collins
Laboratory 21C

NATA Accredited Laboratory Number: 15055

Compaction Control AS 1289 5.7.1 & 5.8.1 & 2.1.1

Sample Number	78551-S36	78551-S37	
Date Tested	28/10/2024	28/10/2024	
Time Tested	15:20	15:28	
Test Request #/Location	Compound pad	Compound pad	
Easting	290905	290909	
Northing	5822255	5822249	
Layer / Reduced Level	1	1	
Thickness of Layer (mm)	200	200	
Soil Description	Silty CLAY, medium to high plasticity, brown	Silty CLAY, medium to high plasticity, brown	
Test Depth (mm)	175	175	
Sieve used to determine oversize (mm)	19.0	19.0	
Percentage of Wet Oversize (%)	0	8	
Field Wet Density (FWD) t/m ³	1.80	1.78	
Field Moisture Content %	16.5	18.4	
Field Dry Density (FDD) t/m ³	1.55	1.50	
Peak Converted Wet Density t/m ³	1.86	**	
Adjusted Peak Converted Wet Density t/m ³	**	1.90	
Moisture Variation (Wv) %	4.5	**	
Adjusted Moisture Variation %	**	4.0	
Hilf Density Ratio (%)	97.0	95.0	
Compaction Method	Standard	Standard	
Report Remarks	**	**	

Moisture Variation Note:

Positive values = test is dry of OMC
 Negative values = test is wet of OMC

Sample Locations Plan

x - approximate test location

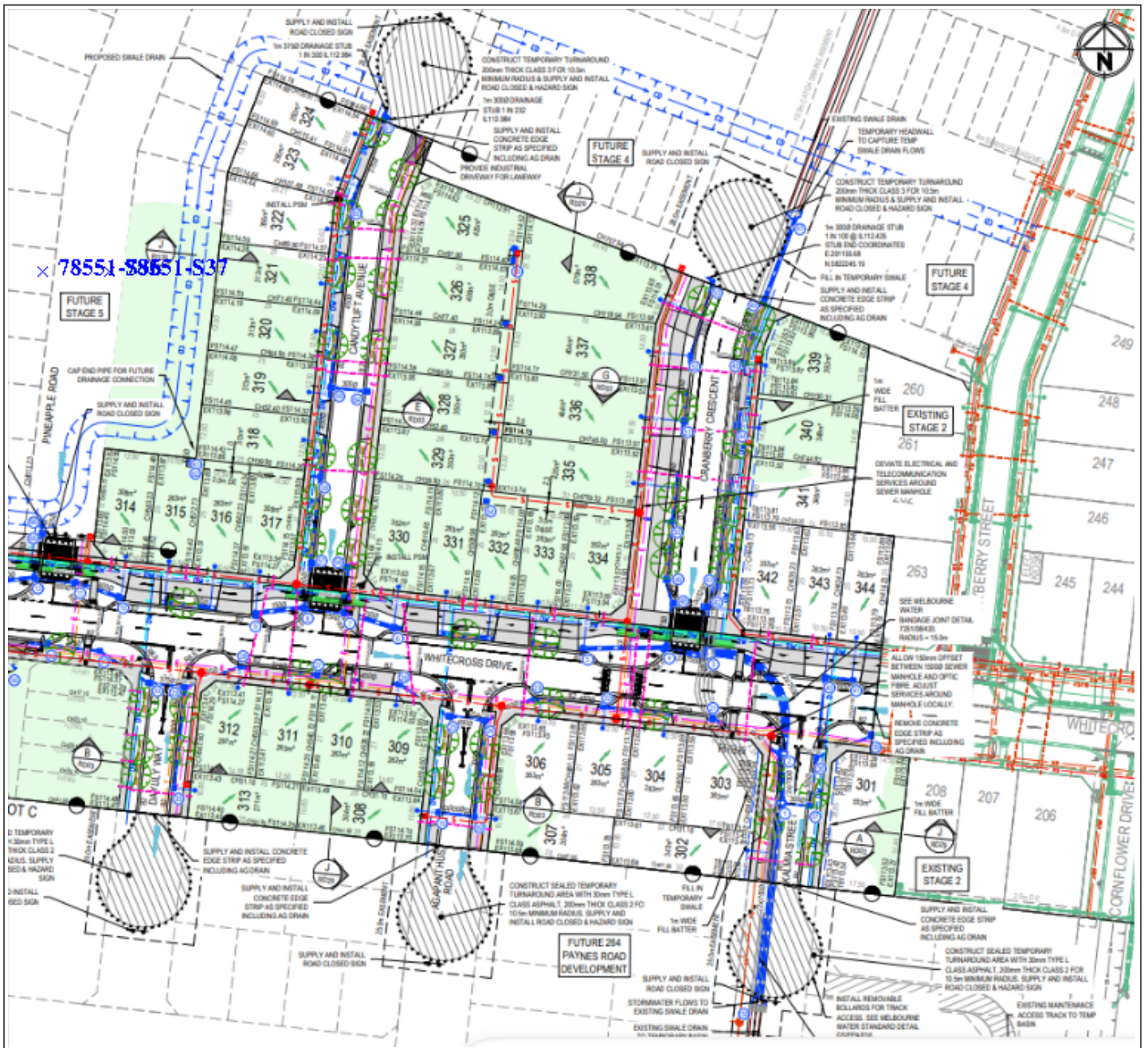

Material Test Report



Report Number: GS7855/1-11
Issue Number: 1
Date Issued: 01/11/2024
Client: Winslow Constructors Pty Ltd
 Lot 13, 6 Latchford Street, Cranbourne West VIC 3977
Contact: Raymond Lara
Project Number: GS7855/1
Project Name: 236 Paynes Road – Stage 3 (Level one)
Project Location: 236 Paynes Road
Work Request: 20929
Date Sampled: 29/10/2024
Dates Tested: 29/10/2024 - 01/11/2024
Sampling Method: AS 1289.1.2.1 6.4 (b) - Sampling from layers in earthworks or pavement - compacted
Specification: 95% Standard Compaction & +/- 3% Moisture Variation
Site Selection: Selected by Client
Location: Thornhill Park
Material: Silty CLAY, medium to high plasticity, brown
Material Source: Imported - Westwood stage 11 Fraser rise

Ground Science Pty Ltd
 Ground Science Laboratory
 13 Brock Street Thomastown Victoria 3074
 Phone: (03) 9464 4617
 Email: kallam@groundscience.com.au



Accredited for compliance with ISO/IEC 17025 - Testing

K. Collins

Approved Signatory: Kallam Collins
Laboratory 21C

NATA Accredited Laboratory Number: 15055

Compaction Control AS 1289 5.7.1 & 5.8.1 & 2.1.1			
Sample Number	78551-S38	78551-S39	78551-S40
Date Tested	05/11/2024	05/11/2024	05/11/2024
Time Tested	15:23	15:30	15:40
Test Request #/Location	Lot-322	Lot-320	Lot-318
Easting	0291051	0291048	0291049
Northing	5822265	5822254	5822239
Layer / Reduced Level	1	1	1
Thickness of Layer (mm)	200	200	200
Soil Description	Silty CLAY, medium to high plasticity, brown	Silty CLAY, medium to high plasticity, brown	Silty CLAY, medium to high plasticity, brown
Test Depth (mm)	175	175	175
Sieve used to determine oversize (mm)	19.0	19.0	19.0
Percentage of Wet Oversize (%)	0	0	5
Field Wet Density (FWD) t/m ³	1.86	1.84	1.86
Field Moisture Content %	24.1	23.0	25.4
Field Dry Density (FDD) t/m ³	1.49	1.50	1.48
Peak Converted Wet Density t/m ³	1.95	1.90	**
Adjusted Peak Converted Wet Density t/m ³	**	**	1.93
Moisture Variation (Wv) %	-0.5	2.5	**
Adjusted Moisture Variation %	**	**	0.5
Hilf Density Ratio (%)	95.0	97.0	96.5
Compaction Method	Standard	Standard	Standard
Report Remarks	**	**	**

Moisture Variation Note:

Positive values = test is dry of OMC
 Negative values = test is wet of OMC

Material Test Report



Report Number: GS7855/1-12
Issue Number: 1
Date Issued: 12/11/2024
Client: Winslow Constructors Pty Ltd
 Lot 13, 6 Latchford Street, Cranbourne West VIC 3977
Contact: Raymond Lara
Project Number: GS7855/1
Project Name: 236 Paynes Road – Stage 3 (Level one)
Project Location: 236 Paynes Road
Work Request: 21167
Date Sampled: 09/11/2024
Dates Tested: 09/11/2024 - 11/11/2024
Sampling Method: AS 1289.1.2.1 6.4 (b) - Sampling from layers in earthworks or pavement - compacted
Specification: 95% Standard Compaction & +/- 3% Moisture Variation
Site Selection: Selected by Client
Location: Thornhill Vic
Material: Silty CLAY, medium to high plasticity, brown
Material Source: Important Westwood stage 11 Fraser rise

Ground Science Pty Ltd
 Ground Science Laboratory
 13 Brock Street Thomastown Victoria 3074
 Phone: (03) 9464 4617
 Email: kallam@groundscience.com.au



Accredited for compliance with ISO/IEC 17025 - Testing

J. Collins

Approved Signatory: Kallam Collins
Laboratory 2IC

NATA Accredited Laboratory Number: 15055

Compaction Control AS 1289 5.7.1 & 5.8.1 & 2.1.1						
Sample Number	78551-S41	78551-S42	78551-S43	78551-S44	78551-S45	78551-S46
Date Tested	09/11/2024	09/11/2024	09/11/2024	09/11/2024	09/11/2024	09/11/2024
Time Tested	10:20	10:28	10:35	10:42	10:50	11:02
Test Request #/Location	Lot-339	Lot-340	Lot-341	Lot-342	Lot-343	Lot-344
Easting	0291181	0291178	0291173	0291179	0291171	0291165
Northing	5822228	5822213	5822194	5822175	5822178	5822181
Layer / Reduced Level	1	1	1	1	1	1
Thickness of Layer (mm)	200	200	200	200	200	200
Soil Description	Silty CLAY, medium to high plasticity, brown	Silty CLAY, medium to high plasticity, brown	Silty CLAY, medium to high plasticity, brown	Silty CLAY, medium to high plasticity, brown	Silty CLAY, medium to high plasticity, brown	Silty CLAY, medium to high plasticity, brown
Test Depth (mm)	175	175	175	175	175	175
Sieve used to determine oversize (mm)	19.0	19.0	19.0	19.0	19.0	19.0
Percentage of Wet Oversize (%)	0	6	5	4	0	0
Field Wet Density (FWD) t/m ³	1.93	1.94	1.95	1.92	1.93	1.96
Field Moisture Content %	21.5	20.2	19.4	22.1	22.7	20.6
Field Dry Density (FDD) t/m ³	1.59	1.62	1.63	1.57	1.57	1.62
Peak Converted Wet Density t/m ³	2.02	**	**	**	1.98	1.98
Adjusted Peak Converted Wet Density t/m ³	**	2.00	1.98	1.98	**	**
Moisture Variation (Wv) %	-0.5	**	**	**	0.5	0.5
Adjusted Moisture Variation %	**	1.5	1.5	0.5	**	**
Hilf Density Ratio (%)	95.5	97.0	98.0	97.0	97.5	99.0
Compaction Method	Standard	Standard	Standard	Standard	Standard	Standard
Report Remarks	**	**	**	**	**	**

Moisture Variation Note:

Positive values = test is dry of OMC
 Negative values = test is wet of OMC

Sample Locations Plan

x - approximate test location

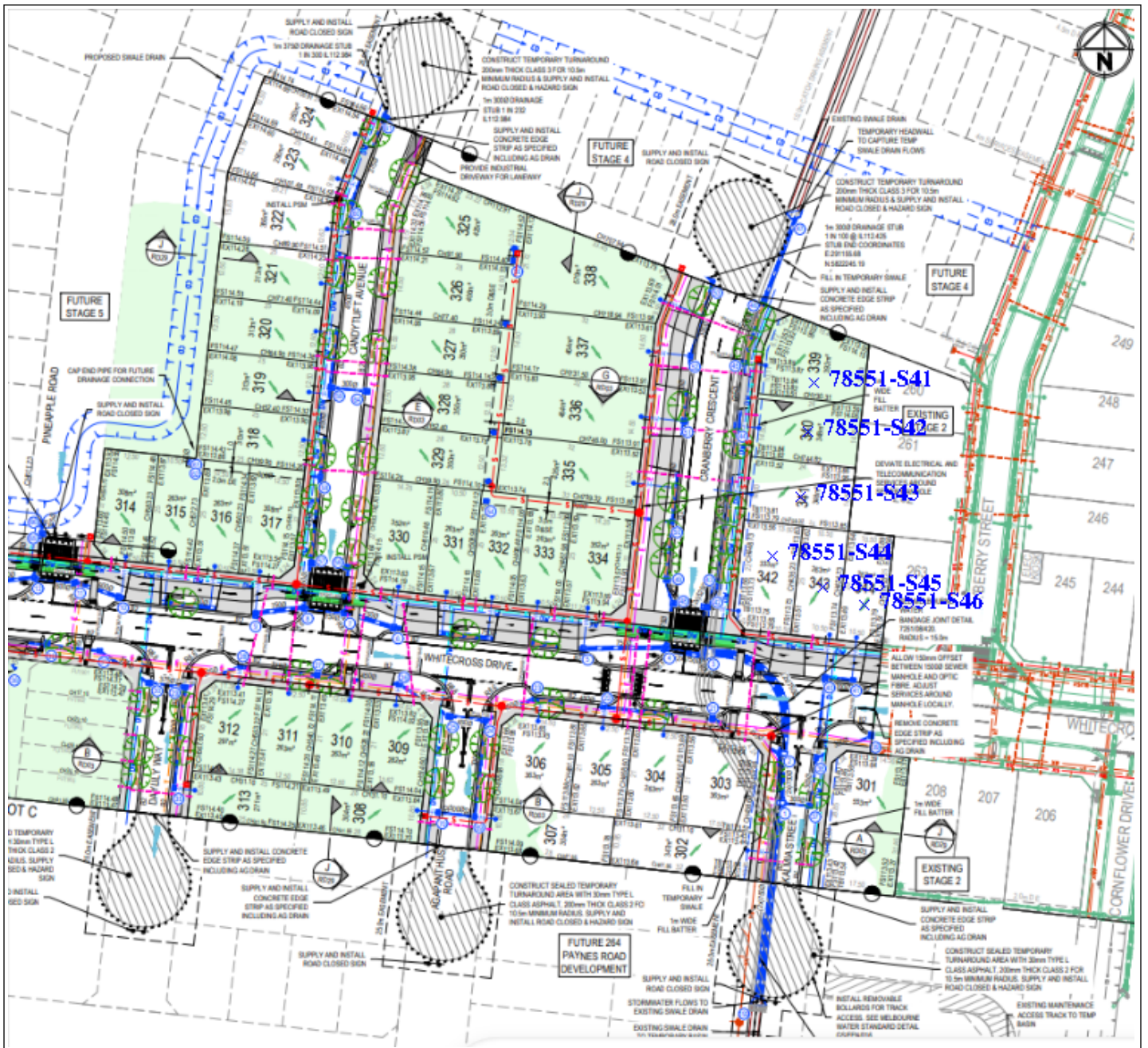

Material Test Report



Report Number: GS7855/1-13A
Issue Number: 1
Date Issued: 15/11/2024
Client: Winslow Constructors Pty Ltd
 Lot 13, 6 Latchford Street, Cranbourne West VIC 3977
Contact: Raymond Lara
Project Number: GS7855/1
Project Name: 236 Paynes Road – Stage 3 (Level one)
Project Location: 236 Paynes Road
Work Request: 21175
Date Sampled: 11/11/2024
Dates Tested: 11/11/2024 - 13/11/2024
Sampling Method: AS 1289.1.2.1 6.4 (b) - Sampling from layers in earthworks or pavement - compacted
Specification: 95% Standard Compaction & +/- 3% Moisture Variation
Site Selection: Selected by Client
Location: Thornhill Vic
Material: Silty CLAY, medium to high plasticity, brown
Material Source: Important Westwood stage 11

Ground Science Pty Ltd
 Ground Science Laboratory
 13 Brock Street Thomastown Victoria 3074
 Phone: (03) 9464 4617
 Email: lee@groundscience.com.au

Accredited for compliance with ISO/IEC 17025 - Testing



Approved Signatory: Lee Christie
 Level One Co-ordinator
 NATA Accredited Laboratory Number: 15055

Compaction Control AS 1289 5.7.1 & 5.8.1 & 2.1.1					
Sample Number	78551-S47	78551-S48	78551-S49	78551-S50	78551-S51
Date Tested	11/11/2024	11/11/2024	11/11/2024	11/11/2024	11/11/2024
Time Tested	15:21	15:28	15:37	15:44	15:52
Test Request #/Location	Lot-326	Lot-328	Lot-336	Lot-338	Lot-335
Easting	0291106	0291095	0291137	0291142	0291139
Northing	5822254	5822237	5822217	5822240	5822205
Layer / Reduced Level	1	1	1	1	1
Thickness of Layer (mm)	200	200	200	200	200
Soil Description	Silty CLAY, medium to high plasticity, brown	Silty CLAY, medium to high plasticity, brown	Silty CLAY, medium to high plasticity, brown	Silty CLAY, medium to high plasticity, brown	Silty CLAY, medium to high plasticity, brown
Test Depth (mm)	175	175	175	175	175
Sieve used to determine oversize (mm)	19.0	19.0	19.0	19.0	19.0
Percentage of Wet Oversize (%)	2	2	0	2	2
Field Wet Density (FWD) t/m ³	1.87	1.88	1.86	1.88	1.86
Field Moisture Content %	23.8	24.5	21.5	22.2	24.6
Field Dry Density (FDD) t/m ³	1.51	1.51	1.53	1.54	1.49
Peak Converted Wet Density t/m ³	**	**	1.95	**	**
Adjusted Peak Converted Wet Density t/m ³	1.96	1.96	**	1.95	2.00
Moisture Variation (Wv) %	**	**	1.0	**	**
Adjusted Moisture Variation %	0.0	-0.5	**	0.0	-0.5
Hilf Density Ratio (%)	95.0	95.5	95.0	96.5	93.0
Compaction Method	Standard	Standard	Standard	Standard	Standard
Report Remarks	**	**	**	**	**

Moisture Variation Note:

Positive values = test is dry of OMC
 Negative values = test is wet of OMC

Sample Locations Plan

x - approximate test location

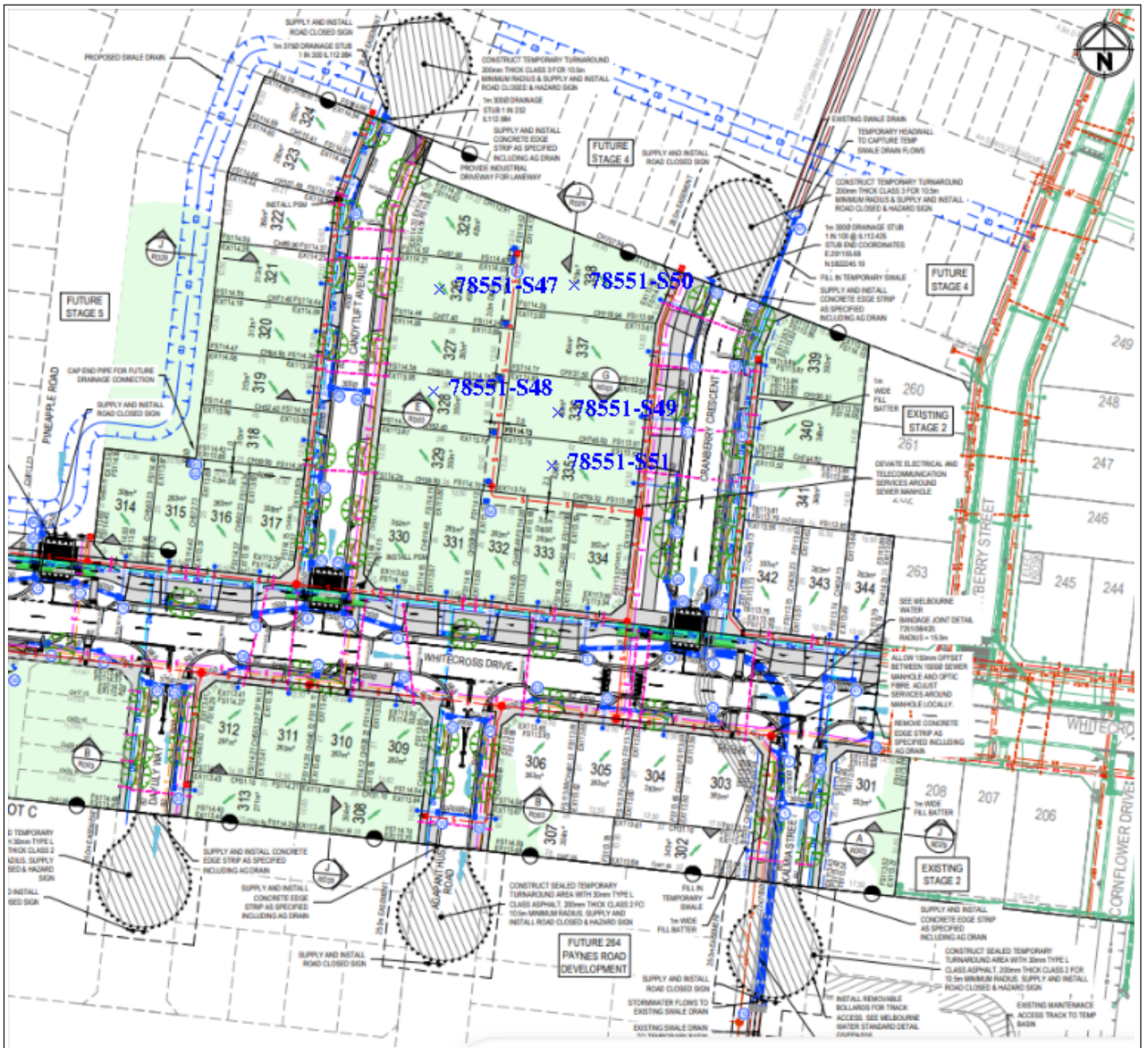

Material Test Report



Report Number: GS7855/1-14
Issue Number: 1
Date Issued: 10/11/2025
Client: Winslow Constructors Pty Ltd
 Lot 13, 6 Latchford Street, Cranbourne West VIC 3977
Contact: Raymond Lara
Project Number: GS7855/1
Project Name: 236 Paynes Road – Stage 3 (Level one)
Project Location: 236 Paynes Road
Work Request: 25655
Date Sampled: 06/11/2025
Dates Tested: 06/11/2025 - 07/11/2025
Sampling Method: AS 1289.1.2.1 6.4 (b) - Sampling from layers in earthworks or pavement - compacted
Specification: 95% Standard Compaction & +/- 3% Moisture Variation
Site Selection: Selected by Client
Location: Thornhill Park
Material: Gravelly CLAY, medium to high plasticity, brown
Material Source: Onsite

Ground Science Pty Ltd
 Ground Science Laboratory
 13 Brock Street Thomastown Victoria 3074
 Phone: (03) 9464 4617
 Email: troyt@groundscience.com.au

Accredited for compliance with ISO/IEC 17025 - Testing



Troy Thynne

Approved Signatory: Troy Thynne
 Earthworks Field / Level 1
 Manager
 NATA Accredited Laboratory Number: 15055

Compaction Control AS 1289 5.7.1 & 5.8.1 & 2.1.1					
Sample Number	78551-S52	78551-S53	78551-S54	78551-S55	78551-S56
Date Tested	06/11/2025	06/11/2025	06/11/2025	06/11/2025	06/11/2025
Time Tested	12:05	12:15	12:24	12:33	12:42
Test Request #/Location	Stage 3 Lot 314	Stage 3 Lot 315	Stage 3 Lot 316	Stage 3 Lot 321	Stage 3 Lot 330
Easting	291022	291035	291047	291059	291089
Northing	5822194	5822194	5822190	5822257	5822185
Layer / Reduced Level	Final layer	Final layer	Final layer	Final layer	Final layer
Thickness of Layer (mm)	200	200	200	200	200
Soil Description	Gravelly CLAY, medium to high plasticity, brown	Gravelly CLAY, medium to high plasticity, brown	Gravelly CLAY, medium to high plasticity, brown	Gravelly CLAY, medium to high plasticity, brown	Gravelly CLAY, medium to high plasticity, brown
Test Depth (mm)	175	175	175	175	175
Sieve used to determine oversize (mm)	19.0	19.0	19.0	19.0	19.0
Percentage of Wet Oversize (%)	7	1	1	12	3
Field Wet Density (FWD) t/m ³	1.94	2.00	1.95	2.04	2.00
Field Moisture Content %	17.8	24.3	20.3	20.1	20.6
Field Dry Density (FDD) t/m ³	1.65	1.61	1.62	1.70	1.66
Peak Converted Wet Density t/m ³	**	**	**	**	**
Adjusted Peak Converted Wet Density t/m ³	2.03	1.91	1.92	1.96	1.91
Moisture Variation (Wv) %	**	**	**	**	**
Adjusted Moisture Variation %	3.0	2.5	2.5	2.5	3.0
Hilf Density Ratio (%)	95.5	104.5	101.5	104.0	104.5
Compaction Method	Standard	Standard	Standard	Standard	Standard
Report Remarks	**	**	**	**	**

Moisture Variation Note:

Positive values = test is dry of OMC
 Negative values = test is wet of OMC

Material Test Report



Report Number: GS7855/1-14
Issue Number: 1
Date Issued: 10/11/2025
Client: Winslow Constructors Pty Ltd
 Lot 13, 6 Latchford Street, Cranbourne West VIC 3977
Contact: Raymond Lara
Project Number: GS7855/1
Project Name: 236 Paynes Road – Stage 3 (Level one)
Project Location: 236 Paynes Road
Work Request: 25655
Date Sampled: 06/11/2025
Dates Tested: 06/11/2025 - 07/11/2025
Sampling Method: AS 1289.1.2.1 6.4 (b) - Sampling from layers in earthworks or pavement - compacted
Specification: 95% Standard Compaction & +/- 3% Moisture Variation
Site Selection: Selected by Client
Location: Thornhill Park
Material: Gravelly CLAY, medium to high plasticity, brown
Material Source: Onsite

Ground Science Pty Ltd
 Ground Science Laboratory
 13 Brock Street Thomastown Victoria 3074
 Phone: (03) 9464 4617
 Email: troyt@groundscience.com.au

Accredited for compliance with ISO/IEC 17025 - Testing



Troy Thynne

Approved Signatory: Troy Thynne
 Earthworks Field / Level 1
 Manager
 NATA Accredited Laboratory Number: 15055

Compaction Control AS 1289 5.7.1 & 5.8.1 & 2.1.1					
Sample Number	78551-S57	78551-S58	78551-S59	78551-S60	78551-S61
Date Tested	06/11/2025	06/11/2025	06/11/2025	06/11/2025	06/11/2025
Time Tested	12:52	13:02	13:11	13:18	13:35
Test Request #/Location	Stage 3 Lot 331	Stage 3 Lot 332	Stage 3 Lot 333	Stage 3 Lot 334	Stage 3 Lot 335 (Retest of S51)
Easting	291100	291115	291121	291131	291124
Northing	5822182	5822178	5822181	5822182	5822210
Layer / Reduced Level	Final layer	Final layer	Final layer	Final layer	Final layer
Thickness of Layer (mm)	200	200	200	200	200
Soil Description	Gravelly CLAY, medium to high plasticity, brown	Gravelly CLAY, medium to high plasticity, brown	Gravelly CLAY, medium to high plasticity, brown	Gravelly CLAY, medium to high plasticity, brown	Gravelly CLAY, medium to high plasticity, brown
Test Depth (mm)	175	175	175	175	175
Sieve used to determine oversize (mm)	19.0	19.0	19.0	19.0	19.0
Percentage of Wet Oversize (%)	6	4	2	1	3
Field Wet Density (FWD) t/m ³	2.03	1.92	1.92	1.95	1.93
Field Moisture Content %	22.0	21.1	21.9	21.2	18.6
Field Dry Density (FDD) t/m ³	1.67	1.59	1.57	1.61	1.63
Peak Converted Wet Density t/m ³	**	**	**	**	**
Adjusted Peak Converted Wet Density t/m ³	1.96	1.93	1.93	1.92	1.95
Moisture Variation (Wv) %	**	**	**	**	**
Adjusted Moisture Variation %	2.5	2.5	3.0	3.0	3.0
Hilf Density Ratio (%)	104.0	99.5	99.5	101.5	99.0
Compaction Method	Standard	Standard	Standard	Standard	Standard
Report Remarks	**	**	**	**	**

Moisture Variation Note:

Positive values = test is dry of OMC
 Negative values = test is wet of OMC

Material Test Report



Report Number: GS7855/1-14
Issue Number: 1
Date Issued: 10/11/2025
Client: Winslow Constructors Pty Ltd
 Lot 13, 6 Latchford Street, Cranbourne West VIC 3977
Contact: Raymond Lara
Project Number: GS7855/1
Project Name: 236 Paynes Road – Stage 3 (Level one)
Project Location: 236 Paynes Road
Work Request: 25655
Date Sampled: 06/11/2025
Dates Tested: 06/11/2025 - 07/11/2025
Sampling Method: AS 1289.1.2.1 6.4 (b) - Sampling from layers in earthworks or pavement - compacted
Specification: 95% Standard Compaction & +/- 3% Moisture Variation
Site Selection: Selected by Client
Location: Thornhill Park
Material: Gravelly CLAY, medium to high plasticity, brown
Material Source: Onsite

Ground Science Pty Ltd
 Ground Science Laboratory
 13 Brock Street Thomastown Victoria 3074
 Phone: (03) 9464 4617
 Email: troyt@groundscience.com.au

Accredited for compliance with ISO/IEC 17025 - Testing



Troy Thynne

Approved Signatory: Troy Thynne
 Earthworks Field / Level 1
 Manager
 NATA Accredited Laboratory Number: 15055

Compaction Control AS 1289 5.7.1 & 5.8.1 & 2.1.1					
Sample Number	78551-S62	78551-S63	78551-S64	78551-S65	78551-S66
Date Tested	06/11/2025	06/11/2025	06/11/2025	06/11/2025	06/11/2025
Time Tested	13:43	14:24	14:32	14:41	14:50
Test Request #/Location	Stage 3 Lot 337	Stage 3 Lot 313	Stage 3 Lot 309	Stage 3 Lot 307	Stage 3 Lot 301
Easting	291130	291056	291085	291123	291191
Northing	5822235	5822126	5822140	5822123	5822131
Layer / Reduced Level	Final layer	Final layer	Final layer	Final layer	Final layer
Thickness of Layer (mm)	200	200	200	200	200
Soil Description	Gravelly CLAY, medium to high plasticity, brown	Gravelly CLAY, medium to high plasticity, brown	Gravelly CLAY, medium to high plasticity, brown	Gravelly CLAY, medium to high plasticity, brown	Gravelly CLAY, medium to high plasticity, brown
Test Depth (mm)	175	175	175	175	175
Sieve used to determine oversize (mm)	19.0	19.0	19.0	19.0	19.0
Percentage of Wet Oversize (%)	4	0	3	5	1
Field Wet Density (FWD) t/m ³	1.97	1.91	2.00	1.96	1.92
Field Moisture Content %	20.2	24.1	17.3	21.1	25.9
Field Dry Density (FDD) t/m ³	1.64	1.54	1.71	1.61	1.52
Peak Converted Wet Density t/m ³	**	1.89	**	**	**
Adjusted Peak Converted Wet Density t/m ³	1.97	**	2.03	1.99	1.88
Moisture Variation (Wv) %	**	3.0	**	**	**
Adjusted Moisture Variation %	2.0	**	1.5	2.5	2.0
Hilf Density Ratio (%)	100.0	101.0	98.5	98.5	101.5
Compaction Method	Standard	Standard	Standard	Standard	Standard
Report Remarks	**	**	**	**	**

Moisture Variation Note:

Positive values = test is dry of OMC
 Negative values = test is wet of OMC

Sample Locations Plan

x - approximate test location

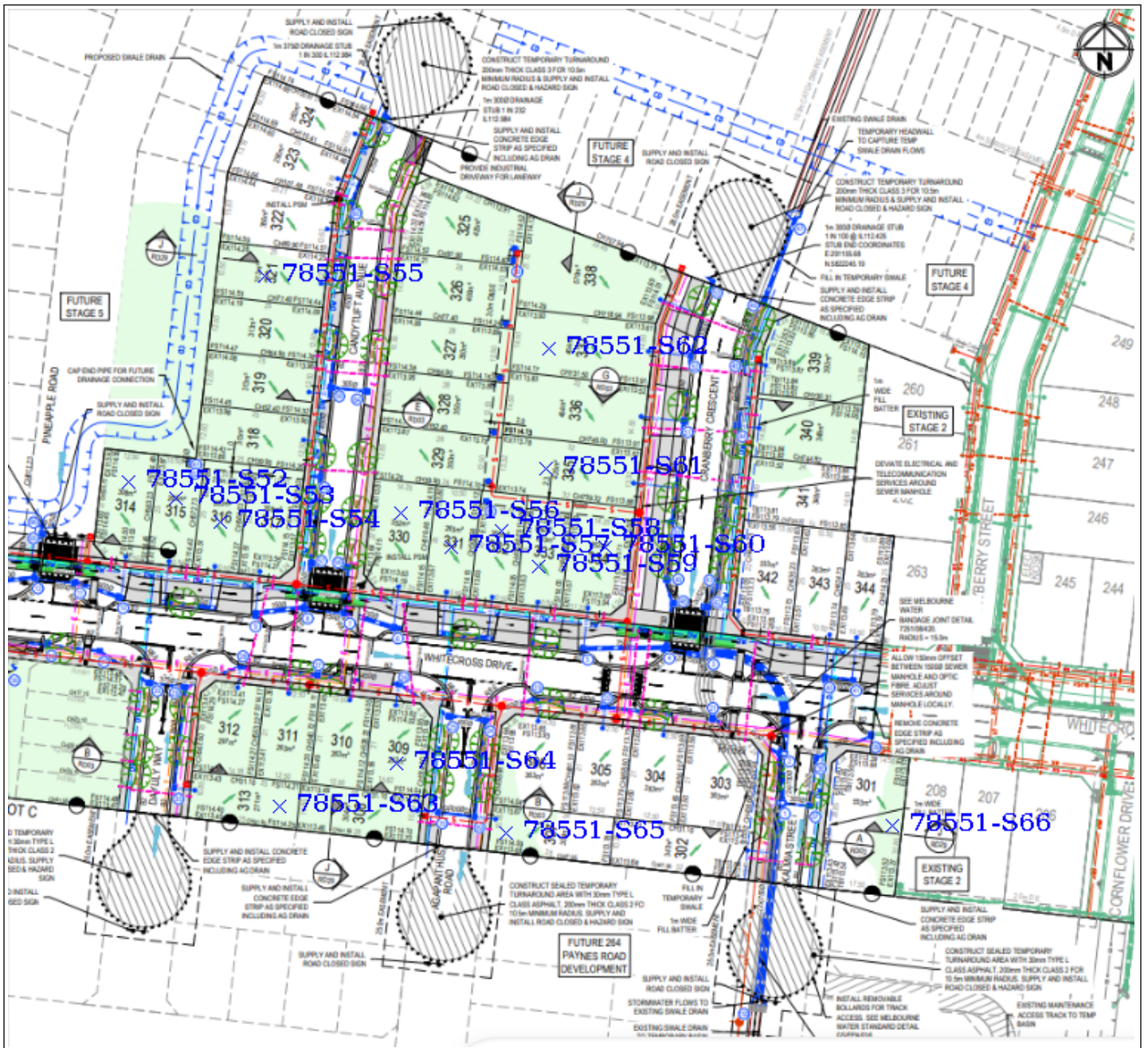

APPENDIX C

Site Photographs





8 Oct 2024 10:35:14 am
GS7855.1
WR20455
236 Paynes Rd Stg 3
Day 6



9 Oct 2024 11:52:38 am
GS7855.1
WR20491
236 Paynes Rd Stg 3
Day 7

25 Oct 2024 10:15:24 am
Payne's Rd, stage 3.
compactor operating@ area Footpath



14 Oct 2024 8:20:12 am
GS7855.1
WR20572
236 Paynes Rd Stg 3
Day 10

31 Oct 2024 9:07:11 am
Winslow constructors Pty,
236 Payne's Rd
stage 3,



8 Nov 2024 9:15:34 am
GS7855/1 Day 20
fill placement lots 339 to 344