

LEVELING PAD AND STEP DETAILS

NOT TO SCALE

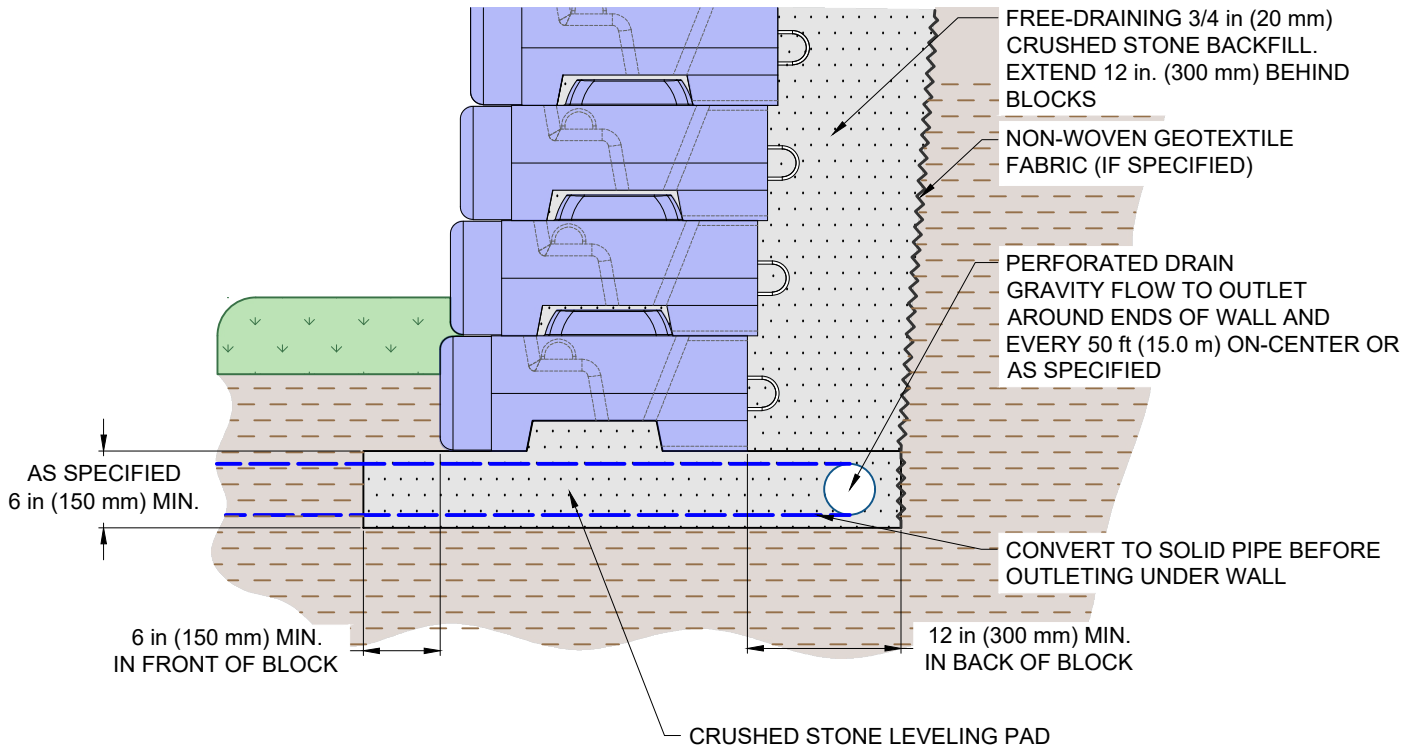

CROSS SECTION - CRUSHED STONE LEVELING PAD

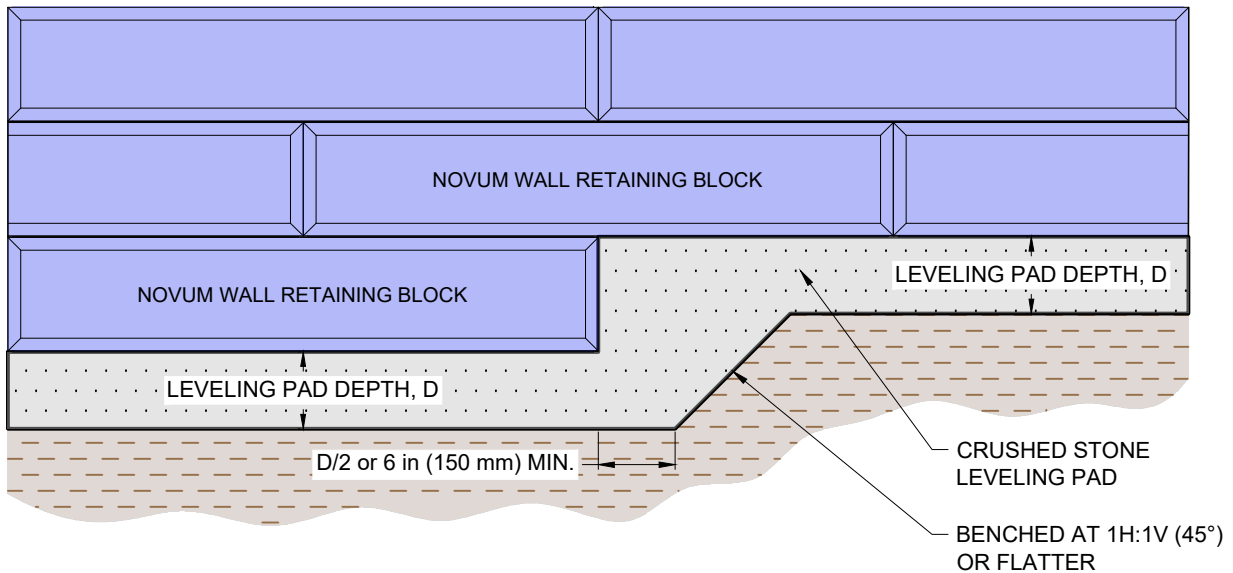

PROFILE VIEW - CRUSHED STONE LEVELING PAD WITH STEP

NOTE: The use of unreinforced mass concrete for leveling pads is also acceptable and may be preferred in certain applications, but is not structurally required.

This drawing is for reference only. Determination of the suitability and/or manner of use of any details contained in this document is the sole responsibility of the design engineer of record. Final project designs, including all construction details, internal and external stability, and drainage, shall be prepared by a licensed professional engineer using the actual conditions of the proposed site.

DRAWN BY:	LBH
APPROVED BY:	DJC
DATE:	21-FEB-2025
SHEET:	1 of 1

TITLE:	LEVELING PAD AND STEP DETAILS
FILE:	Leveling_Pad_And_Step_Details.dwg

NOVUM WALL®

3890 CHARLEVOIX AVE, PETOSKEY, MI 49720
(866) 222-8400 ext 33010 • engineering@redi-rock.com • www.novumwall.com