

## QUICKTIP

# StarLink Edge Table Microphone



## Pairing

The 2.4 GHz Table Microphone must be paired to interact with compatible 2.4 GHz hearing aids with the G2 Neuro Processor. Pairing occurs once, then the hearing aids and Table Microphone will automatically recognize each other. The Table Microphone can be paired within the fitting software or outside of the fitting software.

### Pairing within Pro Fit

- 1 Launch Pro Fit and connect hearing aids.
- 2 Select **Accessories** from the Preparation Session in Pro Fit or from the **Flyout Menu** ☰.
- 3 Select **How to Pair Accessories** for pairing instructions if needed.
- 4 Ensure the Table Microphone is powered on by holding the power button for 2–3 seconds until the brackets light up green.
- 5 Place the hearing aids within 6 inches of the Table Microphone.
- 6 Place the Table Microphone in pairing mode by pressing the Hearing Aid Pairing Button on the bottom of the device for 2 seconds. The blinking blue brackets on the top of the device indicate the Table Microphone is in pairing mode.
- 7 Select **+** to put the hearing aids in pairing mode.
- 8 Pairing is successful when the Table Microphone displays on the Accessories screen.
- 9 Use the dropdown menu below the Table Microphone to set **Hearing Aid Mic while Streaming**.
- 10 Use the dropdown menu below the Table Mic to optimize streaming sound. Options are Equalized (default), Treble Boost, Bass Boost, and Overall Boost.

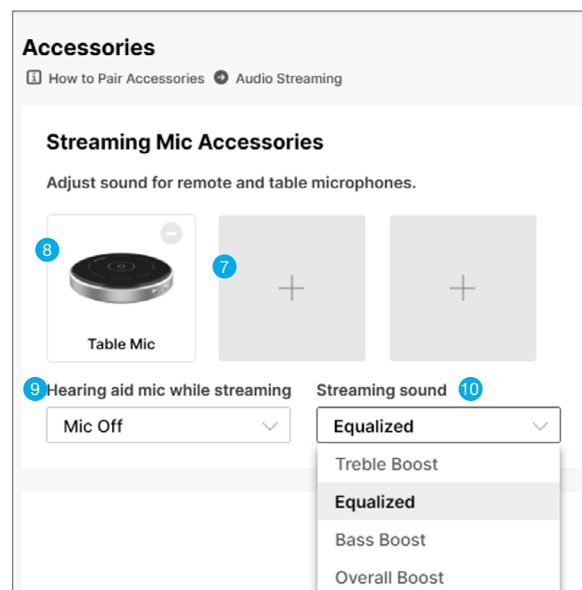

## Pairing (Continued)

### Pairing outside of Software

- 1 Power off any smartphone or other accessories that were previously paired with the hearing aids.
- 2 Power off, then power on the hearing aids to place in pairing mode.
- 3 Place the hearing aids within six inches of the Table Microphone.
- 4 Place the Table Microphone in pairing mode by pressing the Hearing Aid Pairing Button on the bottom of the device for 2 seconds. The blinking blue brackets on the top of the device indicate the Table Microphone is in pairing mode (A).
- 5 A green bracket indicates pairing is successful (B). One bracket is for the left hearing aid, and one bracket is for the right hearing aid.

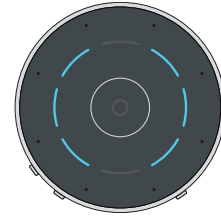

(A) Searching for hearing aids

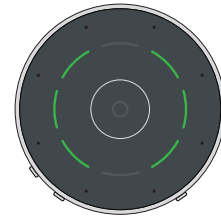

(B) Hearing aid pairing successful

## How it Works

The Table Microphone is designed to improve listening in noise by allowing the user to focus on the primary speaker in multiple-speaker settings, like meetings or family gatherings, and connect with the world around them.

## Use Modes

### Automatic Mode:

Tap the Automatic Mode button. Five segments will illuminate with one brighter than the other. The microphones will detect speech and indicate its direction with the brighter LED.

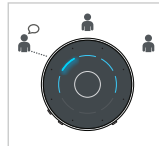

### Manual Mode:

- Tap any number of segments to focus in a particular direction(s). Up to 8 blue segments indicate selected listening direction(s).

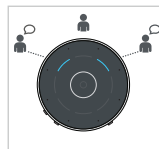

**Surround Mode:** Designed for listening to multiple speakers in a quiet environment.

- Tap all segments to listen to multiple people in quiet settings.

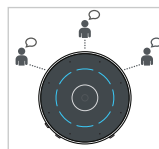

### Remote Microphone:

The Table Microphone can be used as a remote microphone when worn on a lanyard around the neck. The Table Microphone should be within 8 inches of the speaker's mouth.

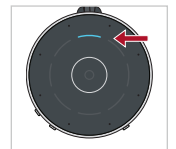

- Attach the magnetic hanger to the back of the Table Microphone. Make sure the hanger is properly secured.
- When the Table Microphone is worn by the speaker the top indicator will light up for 3 seconds.

### Mute:

Manually close all segments, the middle circle will be illuminated. Tap the middle circle and the Table Microphone will return to Automatic Mode.

## Use

The Table Microphone can be paired to one set of compatible 2.4 GHz hearing aids with the G2 Neuro Processor. For best performance, make sure the Table Microphone volume and power buttons are facing you.

- Audio streaming will begin automatically when the Table Microphone is powered on. Audio streaming will stop when the Table Microphone is powered off.
  - To adjust the stream volume, press the + or – buttons on the Table Microphone, move the volume slider on the Accessories screen of your compatible mobile app and/or press your hearing aid user controls.
  - The Table Microphone operating range is up to 50 feet (15 meters).
  - The Table Microphone can stream for up to 10 hours on a single, full charge.
  - The Table Microphone reaches a full charge in up to 2 hours.
- Battery Status Indicators:
    - (A) **Green segments** indicate battery charge level. The blinking green segment indicates the current level.
    - (B) **Orange** segments indicate less than two hours of battery life.
    - (C) A **Red** segment indicates less than one hour of battery life.

