



Boise Cascade®
ENGINEERED WOOD PRODUCTS

VERSA-LAM LVL

1.8E Wide Rimboard

Durability and Dependability, Built-In

**Apartments | Condominiums | Townhouses | Student Housing
Hotels | Government Housing | Assisted Living Facilities**

Versa-Lam® LVL 1.8E Wide Rimboard is a strong, stable and readily available engineered solution for multifamily and light commercial structures. Available in 3½" - 5¼" widths, It combines the reliability and stability of Boise Cascade® Versa-Lam LVL with reliable lateral support, making it ideal for demanding high-wind and seismic zones. With high load-bearing capacity and dimensional consistency, it ensures durable, Type IIIA code-compliant assemblies and straightforward installation on the jobsite.

Versa-Lam LVL Wide Rimboard Advantages:

- Manufactured to the exact depth of BCI® and AJS® Joists
- Thicker Versa-Lam LVL has natural charring benefits that replaces the need for fire retardant treated wood rim in Type IIIA exterior walls, per 2024 IBC sections 705.6 and 705.7.1
- High vertical and lateral load support without twisting or warping
- Offers higher design values and dimensional stability than comparable rim board solutions
- Evaluated by ICC Evaluation Service and APA – The Engineered Wood Association for quality assurance and performance standards
- Minimal shrinking and no camber for flat, flush, and precise rim board installation
- Wider widths help accommodate dense nailing patterns required in high seismic zones
- Provides capacities for high load, blocked and un-blocked diaphragms to replace 3" nominal framing per AWC SDPWS

SIZE GUIDE

- **Depth:** 9½" - 24"
- **Width:** 3½" - 5¼"

THE BOISE CASCADE DIFFERENCE

- Full line of EWP solutions for single-family, multi-family and commercial projects
- Reliable nationwide distribution network
- More than 60 years of proven performance
- Peace of mind with our limited lifetime warranty
- Industry-leading SawTek® automated saw system
- EWP product support from knowledgeable engineers



Versa-Lam LVL Wide Rimboard Properties



Boise Cascade®
ENGINEERED WOOD PRODUCTS

3½" & 5¼" Versa-Lam LVL 1.8E 2650

Allowable Design Values				
Flexural Stress [lb/in ²]	Modus of Elasticity True [lb/in ²]	Modus of Elasticity Apparent [lb/in ²]	Horizontal Shear [lb/in ²]	Compression Perpendicular to Grain [lb/in ²]
2,650	1,800,000	1,700,000	285	750

Vertical Load Capacity 16" Max. Depth		Vertical Load Capacity 20" Max. Depth		Vertical Load Capacity 24" Max. Depth		Diaphragm Capacity [lb/ft]	Specific Gravity Equivalency for Lateral Fastener Design	Closest Allowable Nail Spacing – Narrow Face (in)					
Uniform (PLF)	Point (lb)	Uniform (PLF)	Point (lb)	Uniform (PLF)	Point (lb)			8d box	8d cmn	10d box	16d box	10d cmn	16d cmn
4,260	6,000	3,700	6,000	3,700	6,000	Permitted per building code for nominal 3" thick framing blocked, high load, and unblocked diaphragms (AWC SDPWS)	0.5	3	3	3	3	4	6

THICK RIM - HIGH SEISMIC CONNECTIONS

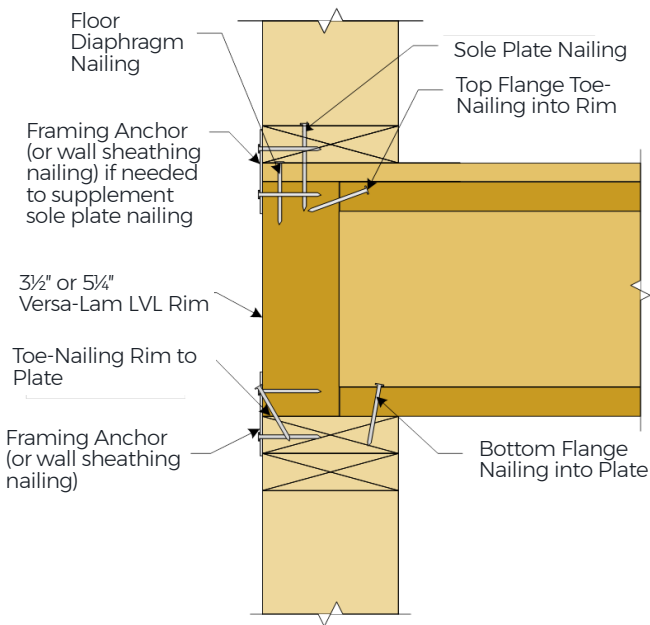

THICK RIM FIRE CHAR - TYPE IIIA EXTERIOR WALL

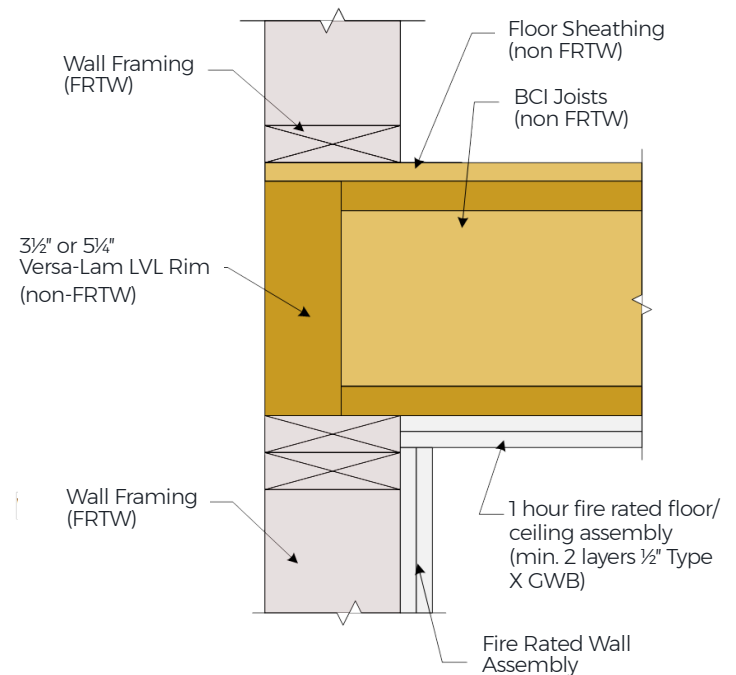

With quality products and unsurpassed customer service, Boise Cascade helps you build better structures

The Boise Cascade EWP sales and distribution teams are here to help with your next multifamily or light commercial project. For more information go to bc.com/ewp/ or call our support center at **800-232-0788**.