

frameless door systems

TUT and TUS profiles : an introduction

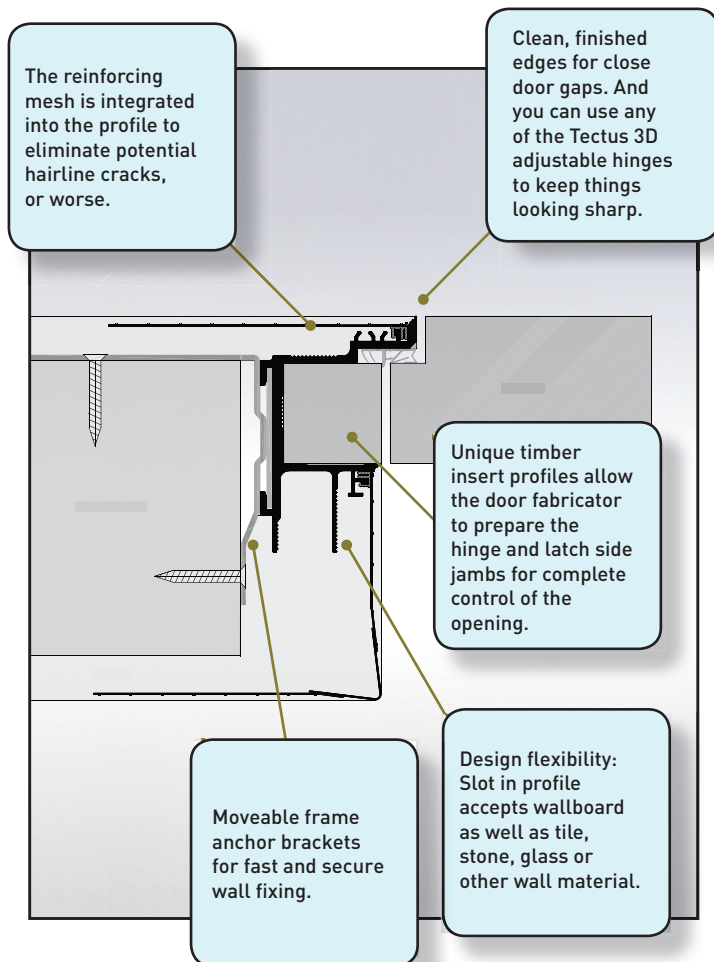



THE **TUT** AND **TUS** PROFILES FROM AGS ARE AN EXCELLENT OPTION FOR PROJECTS LOOKING FOR A FRAMELESS DOOR DETAIL :

- sturdy, aluminum extrusion profile for large openings up to 10-feet high.
- timber insert for prepping hinges, locks, controls and seals.
- allows integration of heavy-duty concealed hinges, so doors up to 440 lbs. are possible.
- integrated reinforcing mesh clicks in to the profile to secure the plaster right up to the clean edge of the opening—no cracks, or ugly frame sealants.
- use with any drywall preparations including Level 5 (5/8" + 1/8" skimcoat).

PERFECT, SIMPLE AND FAST ASSEMBLY

Our AGS Frame Kits come with everything you need to prepare the opening with precision and speed. Review the following pages for more information.

AGS TUT : OUTSWING

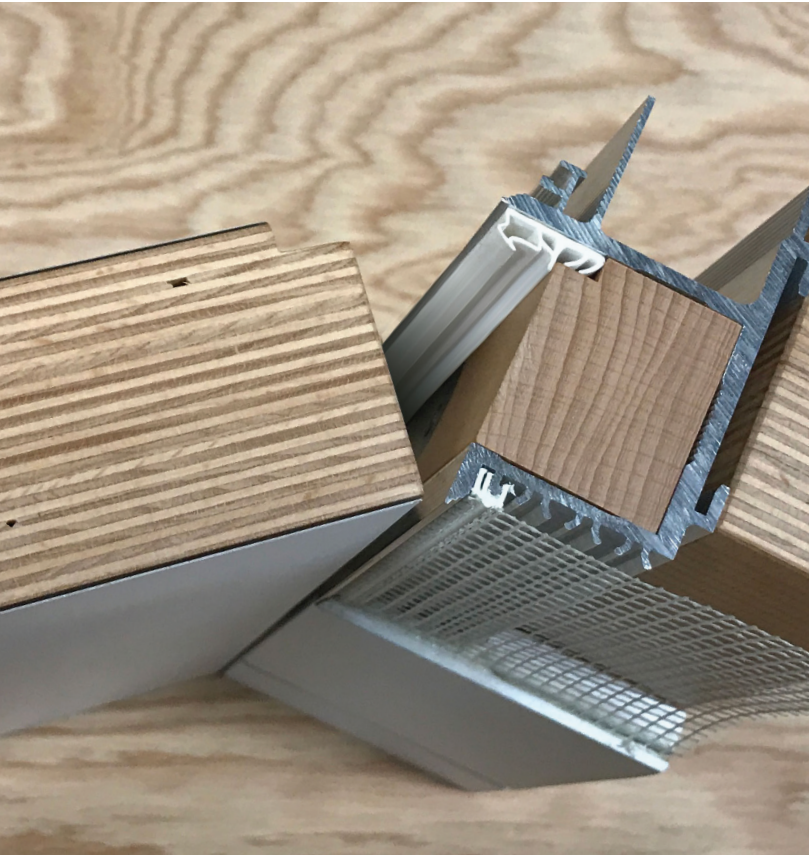

The AGS TUT frameless door profiles are designed to work with concealed hinges for recessed frames (e.g. Simonswerk Tectus TE 541 3D FVZ).

The profiles can be used with or without a transom and are available in standard lengths for doors up to 10'-8" tall and up to 2-1/4" thick.

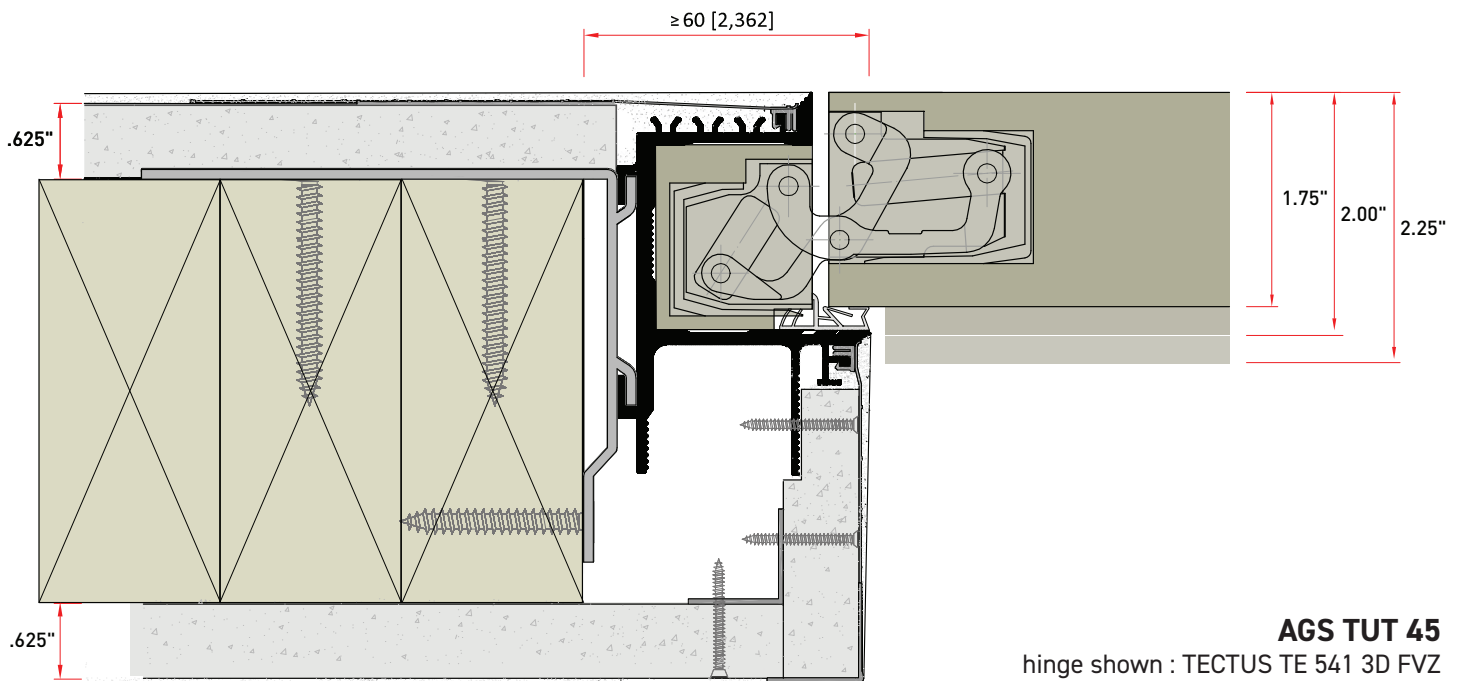
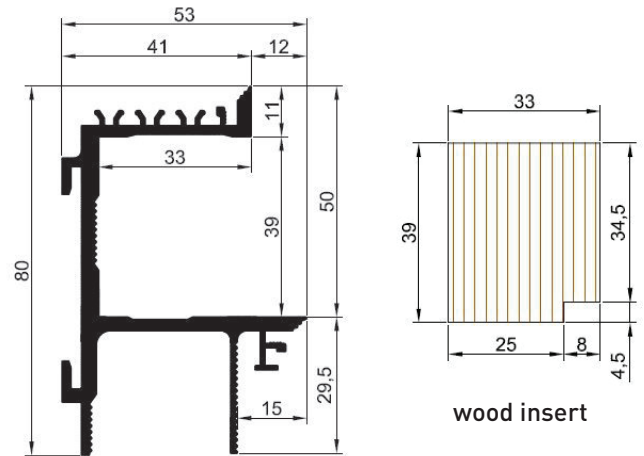

AGS TUS : INSWING

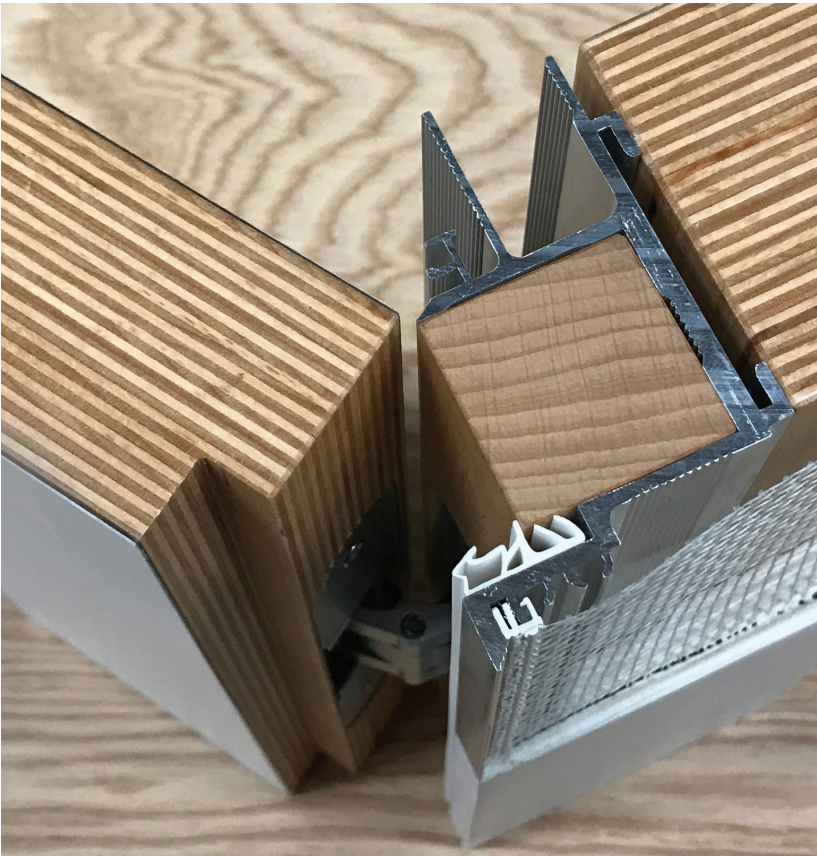

The AGS TUS frameless door profiles are designed to work with a wide range of concealed hinges.

The profiles (TUS 45/50/56) are suitable for doors from 1-3/4" to 2-1/4" thick and up to 440 lbs. TUS profiles can be used with or without a transom and are available in standard lengths for doors up to 10'-8" tall and doors up to 2-1/4" thick.

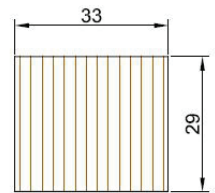
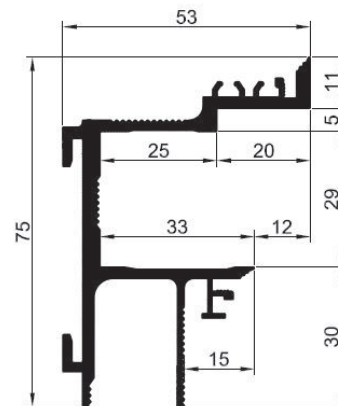

wood insert

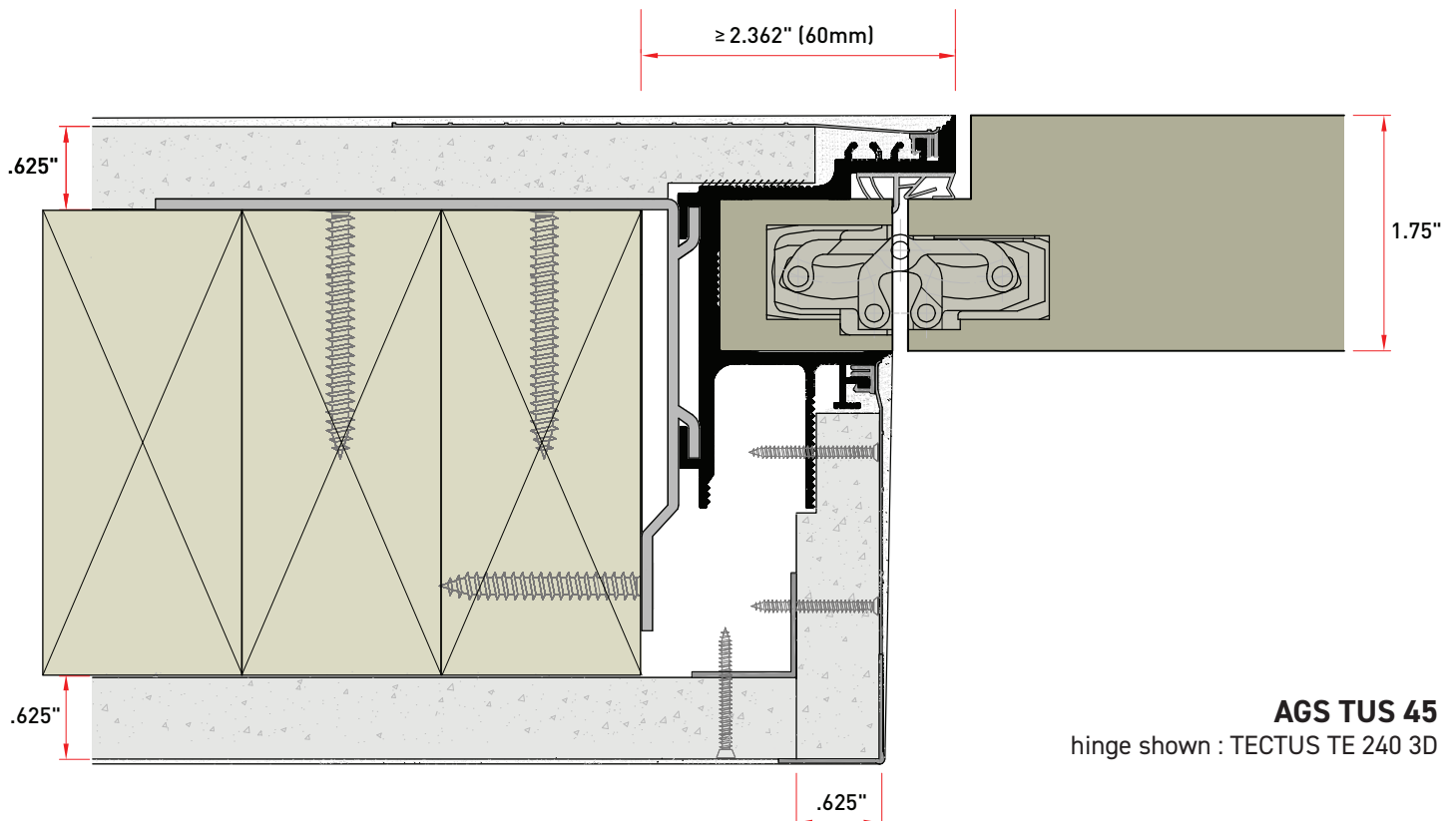

AGS TUS 45

hinge shown : TECTUS TE 240 3D

AGS TUT/TUS : INSTALLATION

Corner Connectors

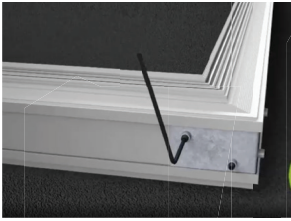

Triangular Stiffeners

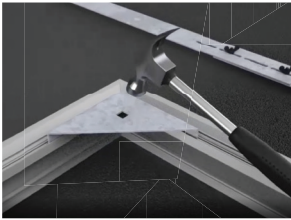

Wall-fixing Brackets

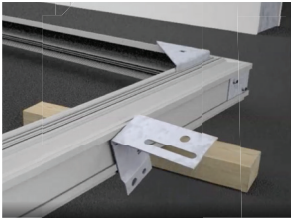

Adjusting and fixing the Frame

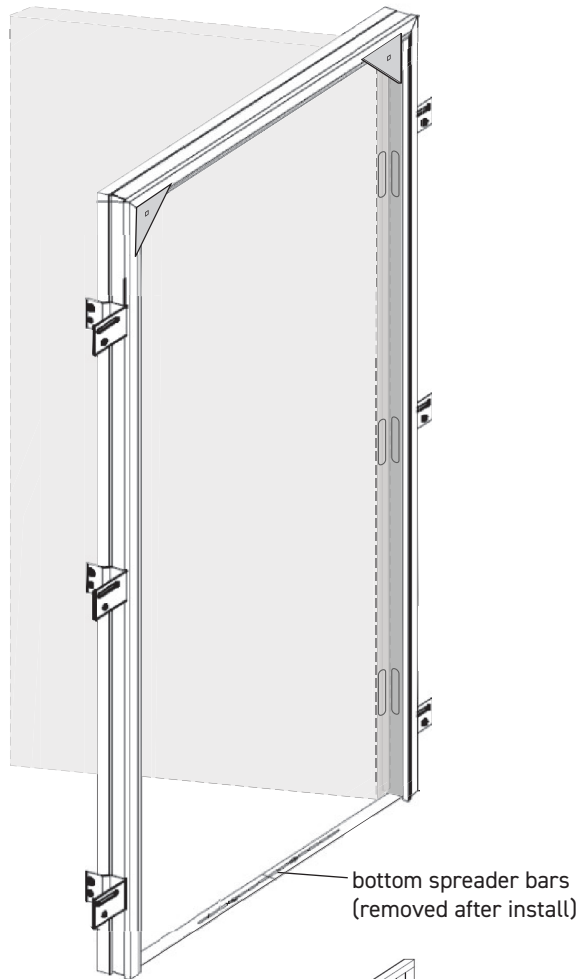

Clip-in-Place Mesh

TUT

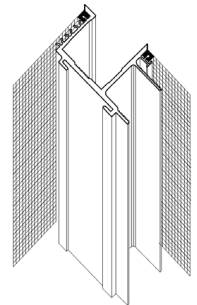

TUS

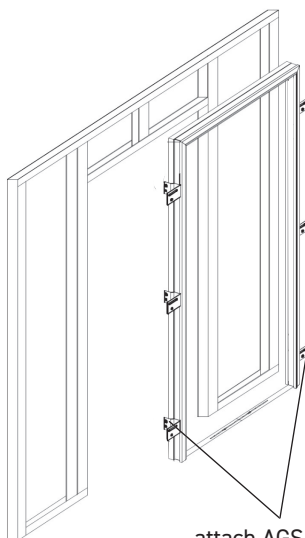
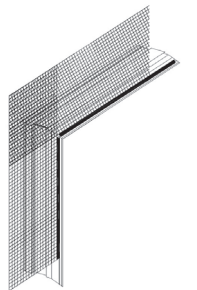
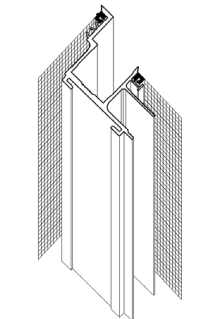

attach AGS System
to wood framing
using wall-fixing brackets

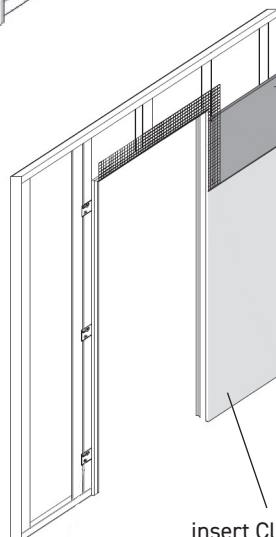

insert Clip-in Mesh,
fasten drywall,
apply plaster skim-coat

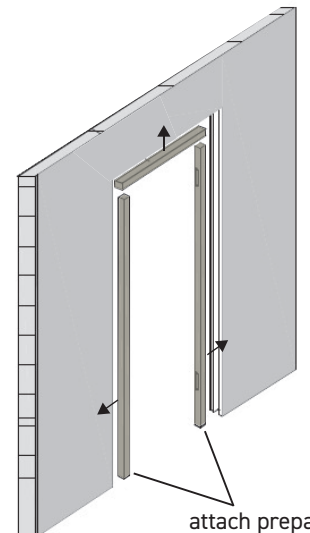

attach prepared
wood inserts
into profiles
with adhesive

