

CORNER SEAL



ForceField® Corner Seal is an effective, innovative solution to help protect your home or building against water intrusion in some of the most difficult areas to treat. Corner seal is a semi-rigid polypropylene seal with a “living hinge” designed to ease the installation in both inside and outside corners.

Working with other accessories in the ForceField® Weather Barrier System, corner seals help create a continuous building envelope for a more energy-efficient structure.



ADVANTAGES

- Innovative solution for finishing inside and outside exterior corners
- Center channel creates a “living hinge” for bending angles
- Simplifies difficult corner treatment
- Bonds to ForceField Panels with approved ForceField tapes
- Helps provide additional protection against air and moisture intrusion

General Product Information

Width	4”x200’
Length	200’ rolls
Material	Polypropylene
Exposure Limit	180 days to normal weather
Thickness	minimum 0.03”
Packaging	1 roll/case

QUICK TIPS

- Cut the corner seal into manageable lengths. Do not install corner seal across joints or where movement is anticipated.
- For best performance results, immediate treatment of panel seams and corners with tape is recommended.

More details can be found here:

<https://buildgp.com/forcefield/accessories/>

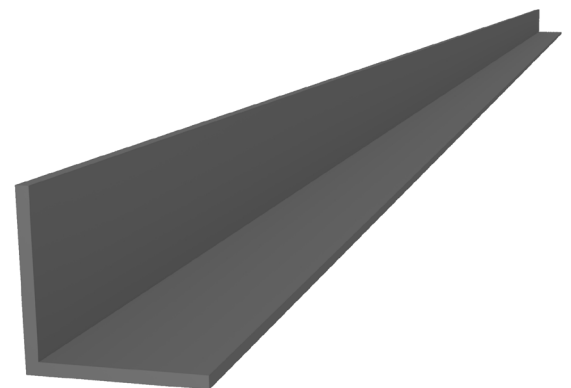



HOW TO INSTALL

1. Before the application of tape, ensure that the sheathing surfaces are free from moisture, frost, dust, dirt, and other bond-inhibiting materials.
2. Unspool material and cut to a length that is manageable for the installation. Where applicable, overlap the corner seal pieces a min. 2" in a shingle lap application. Apply a 6" piece long piece of approved ForceField Seam Tape over the splice.
3. Bend the corner seal appropriately to form an inside or outside corner. See figure on the right.
4. Align corner seal 1"- 2" from the top of the wall.
5. Secure corner seal using nails, brad nails, or staples at 3' intervals down the length of the piece a maximum 1" from outside edge.
6. Seal bottom with another 6" piece of ForceField Seam Tape 1"-2" from bottom of wall.
7. Center approved ForceField tape over one edge of the corner seal. The tape should overlap onto the panel a minimum of 1".
8. Apply firm pressure on the tape surface with your hand or a J-roller to ensure that a continuous bond is achieved between the tape and the panel surface and to eliminate wrinkles and air bubbles.
9. Repeat steps 7-8 for the other edge of the corner seal. Apply a 6" piece of ForceField tape across the top of the corner seal.

WARRANTY

For terms and conditions, please refer to Georgia-Pacific's 10 year transferable* limited warranty for ForceField Weather Barrier System available at warranty.gpforcefield.com.

Only approved ForceField tapes are covered by the Georgia-Pacific ForceField Weather Barrier System limited warranty.

*transferable to subsequent building owner only

HANDLING AND STORAGE

Store in a dry, cool place out of direct sunlight

CUSTOMER CARE

Our sales and technical experts are available to assist. Contact your Georgia Pacific field representative directly or contact the GP Technical Hotline at **800-225-6119**. For sales information contact **866-249-3639**.

LIMITATIONS

- Do not install ForceField tapes in temperatures less than 20°F (-6.7 °C).
- Before tape application, surfaces must be free from moisture, frost, dust, dirt and other bond inhibiting materials.
- Avoid contact with solvents and high alkalinity materials. Use only solvent free primers, materials and cleaning agents.
- ForceField accessories should not replace rigid through wall flashing and are not intended for long term exposure, for immersion in water or cascading water from an unfinished roof or floor. Water should always be directed away from the ForceField Weather Barrier System.
- Do not Remove and reposition ForceField tapes after initial application.
- ForceField Corner Seal is not intended for use on joints. For joints, refer to DensDefy Transition Membrane.



Georgia-Pacific Building Products

133 Peachtree Street, N.E., Atlanta, Georgia 30303

GP Technical Hotline: (800) 225-6119

BuildGP.com/ForceField

Unless otherwise noted, all trademarks are owned by or licensed to Georgia-Pacific Building Products.

Rev 01/24
Lit # 622061