

CORNER SEAL



ForceField® Corner Seal is an effective, innovative solution to help protect your home or building against air and water intrusion in some of the traditionally most difficult areas to treat. Corner seal is a semi-rigid polypropylene seal with a “living hinge” designed to allow for installation in both inside and outside corners.

Working with other products in the ForceField® Weather Barrier System, corner seals help create a continuous building envelope for a more energy-efficient structure.



ADVANTAGES

- Innovative solution for finishing inside and outside exterior corners
- Center channel creates a “living hinge” for bending angles
- Simplifies difficult corner detailing
- Seals to ForceField Panels with ForceField Seam Tape
- Helps provide additional protection against air and moisture intrusion

General Product Information

Width	4" (2" on each side of hinge)
Length	200' rolls
Thickness	minimum 0.03"
Material	Polypropylene

QUICK TIP

Cut the corner seal into manageable lengths.

Do not install corner seal across drift joints and expansion joints or where movement is anticipated. For drift or expansion joints, refer to DensDefy™ Transition Membrane. More details can be found here: buildgp.com/denselement/accessory-products/

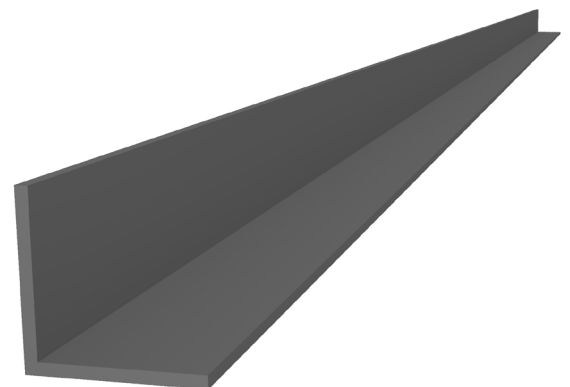



HOW TO INSTALL

- Step 1** Before the application of tape, ensure that the sheathing surfaces are free from moisture, frost, dust, dirt, and other bond-inhibiting materials.
- Step 2** Unspool material and cut to a length that is manageable for the installation. Where applicable, overlap the corner seal pieces a min. 2" in a shingle lap application. Apply a 6" piece of ForceField Seam Tape over the splice.
- Step 3** Bend the corner seal appropriately to form an inside or outside corner. See figure on the right.
- Step 4** Align corner seal 1"-2" from the top of the wall.
- Step 5** Secure corner seal using nails, brad nails, or staples at 3' intervals down the length of the piece a maximum 1" from outside edge.
- Step 6** Seal bottom with another 6" piece of ForceField Seam Tape 1"-2" from bottom.
- Step 7** Center ForceField Seam Tape over one edge of the corner seal. The tape should overlap onto the panel a minimum of 1".
- Step 8** Apply firm pressure on the tape surface with your hand or a J-roller to ensure that a continuous bond is achieved between the tape and the panel surface and to eliminate wrinkles and air bubbles.
- Step 9** Repeat steps 7-8 for the other edge of the corner seal.
- Step 10** Apply a 6" piece of ForceField Seam Tape across the top of the corner seal.

WARRANTY

For terms and conditions, please refer to Georgia-Pacific's 10 year transferable* limited warranty for ForceField Weather Barrier System available at warranty.gpforcefield.com.

*transferable to subsequent building owner only

CUSTOMER CARE

Our sales and technical experts are available to assist. Contact your Georgia-Pacific field representative directly, call our GP Technical Hotline at 800-225-6119 or contact us for sales information at **866-249-3639**.

LIMITATIONS

Do not install corner seal across drift joint and expansion joints or where movement is anticipated. For drift or expansion joints, refer to DensDefy™ Transition Membrane. More details can be found at buildgp.com/denselement/accessory-products/

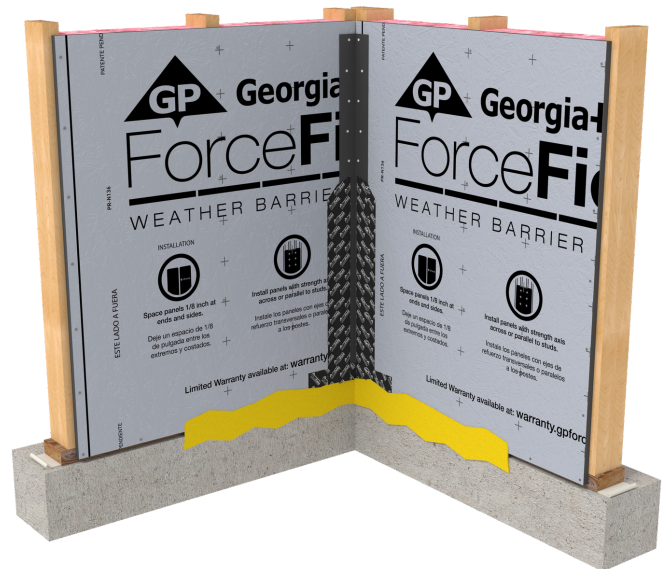

Georgia-Pacific Building Products

133 Peachtree Street, N.E., Atlanta, Georgia 30303
 GP Technical Hotline: (800) 225-6119
GPForceField.com

Unless otherwise noted, all trademarks are owned by or licensed to Georgia-Pacific Building Products.

Rev 11/20
 Lit # 622061