



INSTALLATION GUIDE

DIAL COMBO | SURFACE MOUNT | BOLT | LATCH | FLAT CAM | OFFSET CAM

VERSION 1

DATE: 111324

PG-D6CL-1X-XX-0-UEN



OVAL BODY WITH INTEGRATED PULL



STANDARD BODY WITH INTEGRATED PULL

MECHANICAL REAR UNITS



12MM BOLT



8MM BOLT



12MM LATCH



8MM LATCH



FLAT CAM



OFFSET CAM

Metal Door Preparation

Compatibility Guide3

Required Tools & Materials3

Removal of 3-hole Lock Plug.....3

Removal of Padlock Hasp3

Wood Door Preparation Required Components, Tools, & Materials4

Surface Mount - 8 mm Bolt/Latch

For door thickness measuring between [0mm - 26mm]

Strike Installation Steps5

Wood Door Drill Instructions.....6

Hole Mounting Template6

Required Components and Tools7

Lock Installation Steps8

Surface Mount - 12 mm Bolt/Latch

For door thickness measuring between [0mm - 26mm]

Strike Installation Steps9

Wood Door Drill Instructions.....10

Hole Mounting Template10

Required Components and Tools11

Lock Installation Steps.....12

Surface Mount - Flat Cam

For door thickness measuring between [0mm - 20mm]

Wood Door Drill Instructions.....13

Hole Mounting Template13

Required Components and Tools14

Lock Installation Steps.....15

Surface Mount - Offset Cam

For door thickness measuring between [0mm - 9mm]

Hole Mounting Template16

Required Components and Tools17

Lock Installation Steps.....18

Warranty19

Contact Information20

Digilock is compatible with a majority of 3-hole configuration, latch, and handle door types. Some doors may require modification to clear obstructions.

COMPATIBILITY GUIDE

TYPES OF METAL BOX LOCKER DOORS

Single Point Latch

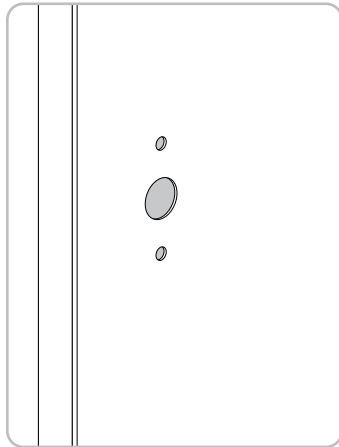

Standard Lift

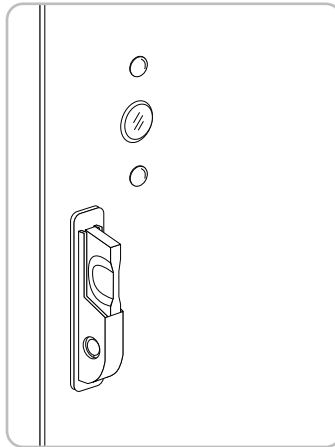

Handle

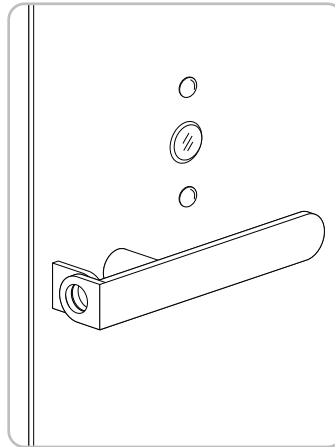

Box Locker Padlock Hasp

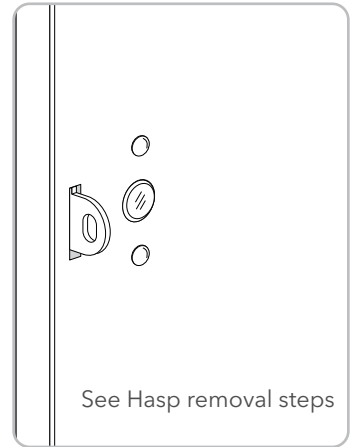

REQUIRED TOOLS

* Not Included

Hack Saw*

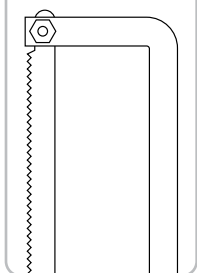

Metal File*

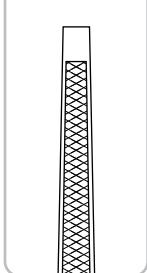

Screw Driver*

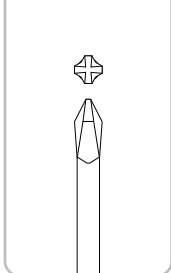

Adjustable Wrench*

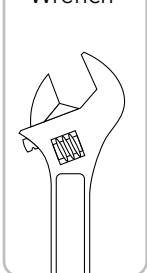

PLUG REMOVAL STEPS

1

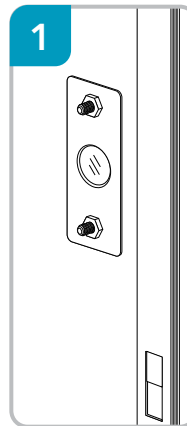

2

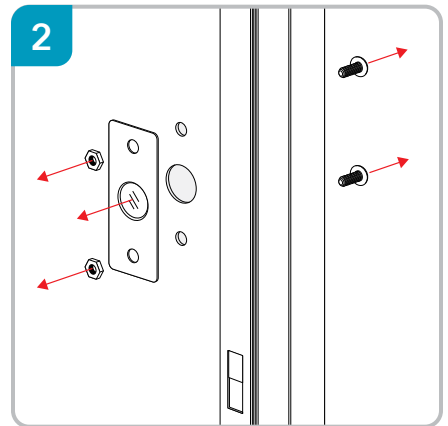

HASP REMOVAL STEPS

1

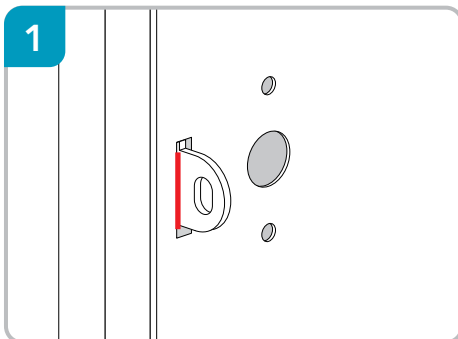

Close the door and mark the area to cut the padlock hasp.

2

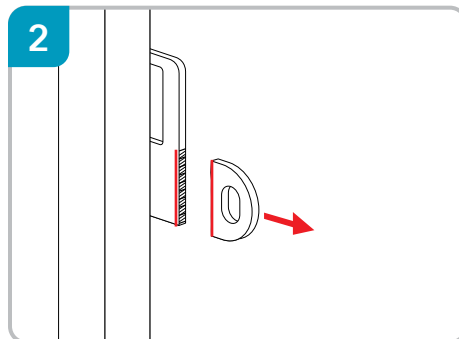

Open the door then cut the padlock hasp on the marked cut line.

3

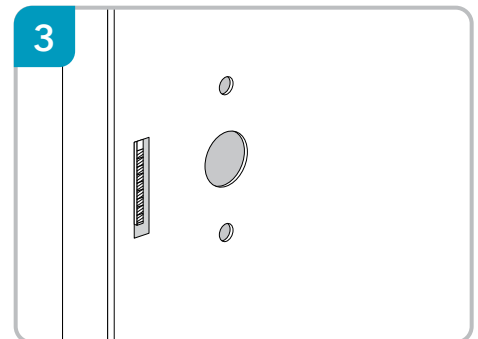

Smooth out rough or sharp edges.

This section is for new installations with wood, MDF, or non-metal doors.

REQUIRED COMPONENTS

STRIKE PLATES

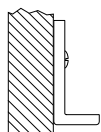

Angled

General Purposes Use

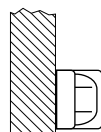

Security

Recommended for latch products

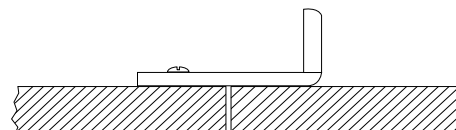

Double-Door

Requires a base latch on strike door (Not included)

REQUIRED TOOLS & MATERIALS

* Not Included

1 - Phillips Driver (#1)*



1 - Phillips Driver (#2)*

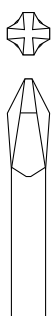

1 - Pencil*



Removable Tape*

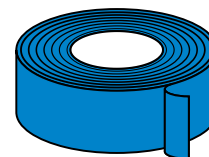

1 - Ruler*

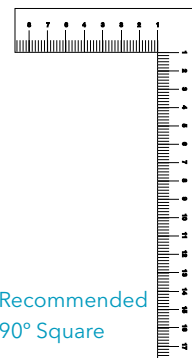

Recommended
90° Square

1 - Power Drill*

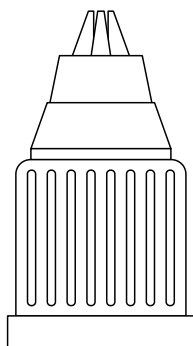

1 - 3/32" Wood Drill bit*

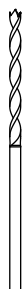

Recommended
Brad Point Bit

1 - 7/32" Wood Drill bit*



Recommended
Brad Point Bit

1 - 3/4" Wood Drill bit*

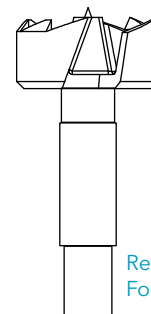

Recommended
Forstner Bit

Note: It is recommended to only use torque **5 or lower** if using a power drill to avoid overtightening.

STRIKE INSTALLATION STEPS

Shown below Angled Strike Plate

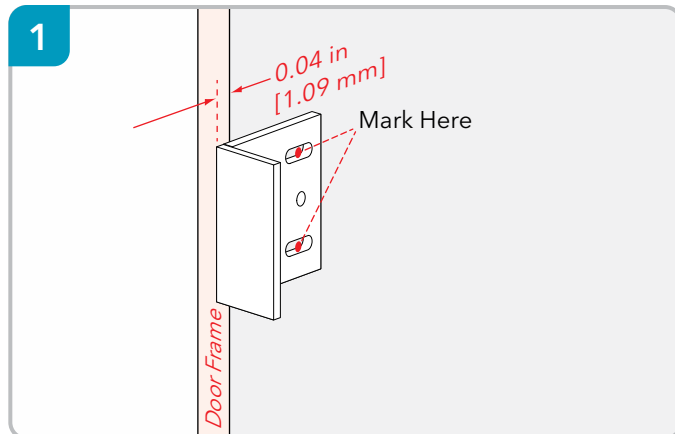

Position the strike plate on the door frame aligning it with the center of the lock's mounting holes.

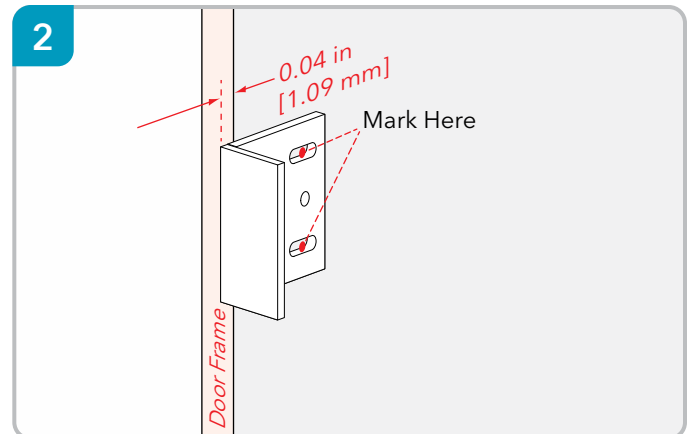

Allow 0.04" [1.09 mm] overhang from door edge and mark the position of the adjustment slot holes.



Drill 0.09" [2.38 mm] pilot holes using a $\frac{3}{32}$ " drill bit.

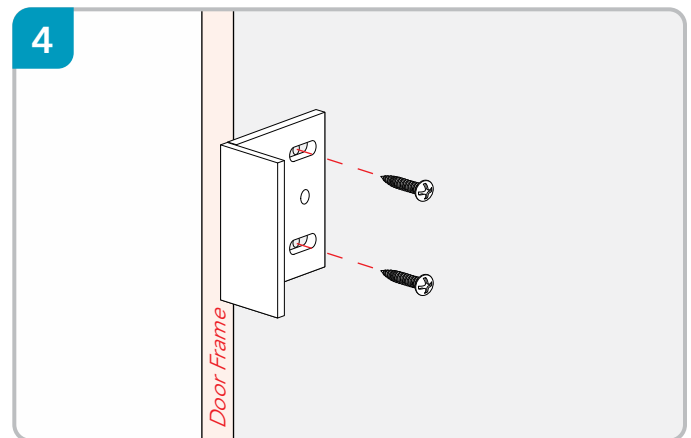

Position the strike plate and the self tapping screws into the adjustment slot holes. Do not tighten the screws.

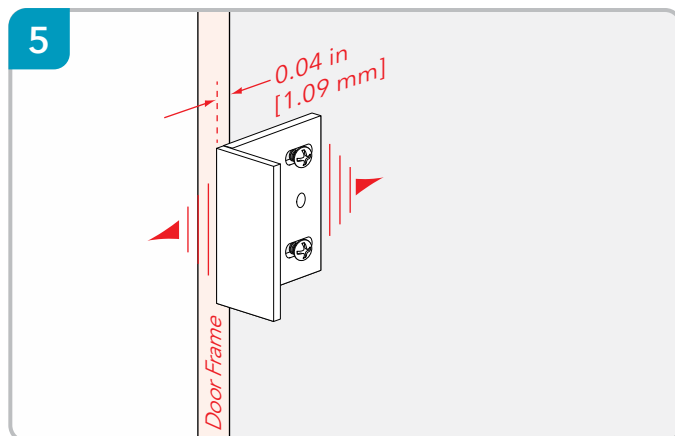

Adjust the strike plate to the proper position 0.04" [1.09 mm] overhang from the door edge then tighten the self tapping screws.

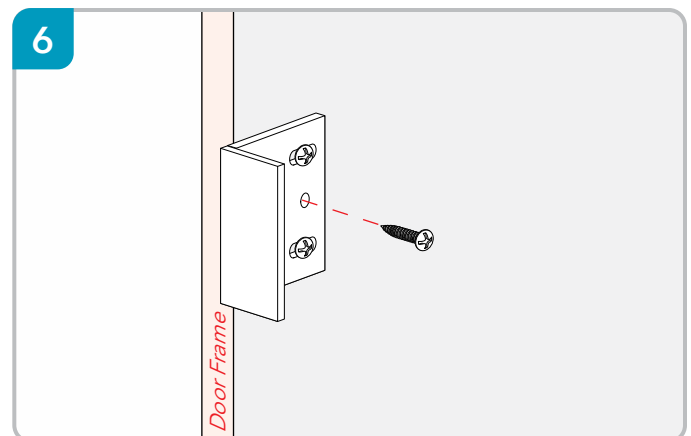

Insert and tighten the remaining self tapping screw into the center opening to secure strike position.

WOOD DOOR DRILLING INSTRUCTIONS

Door Mounting Holes Drill Instruction

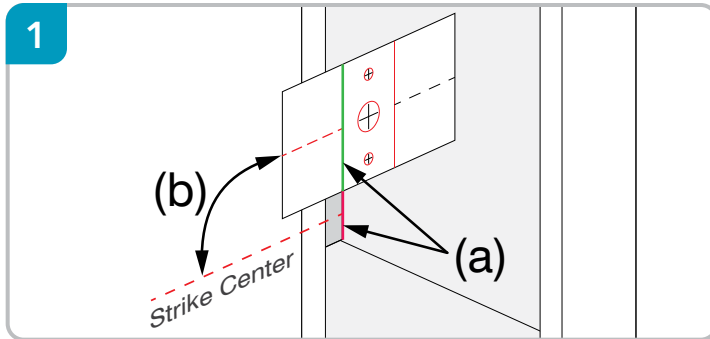

With the door open place the Template over the locker frame.
(a) Align the edge of Strike Plate with the Strike Plate Marker.
(b) Center the Template to the center of the Strike Plate.
 You may secure the Template with removable tape.

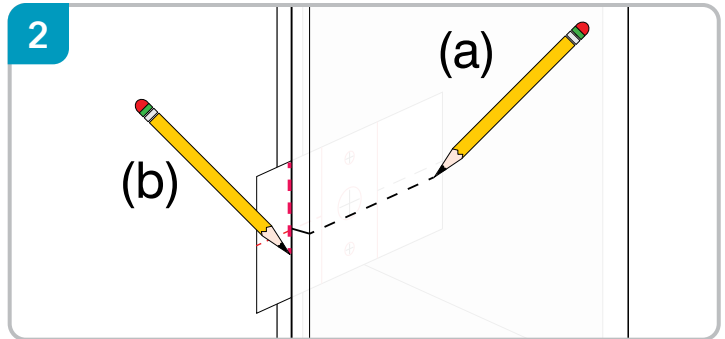

Close the door over the Template.
(a) Mark the door edge at the Template Center Line.
(b) Mark the Template with the edge of the door.

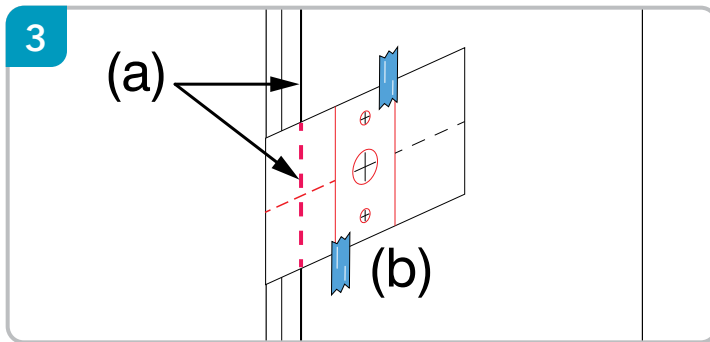

Place the Template on the front of the door.
(a) Align the drawn mark on the Template with the door edge.
(b) Center the Template with the mark on the door.
 Secure the Template with removable tape.

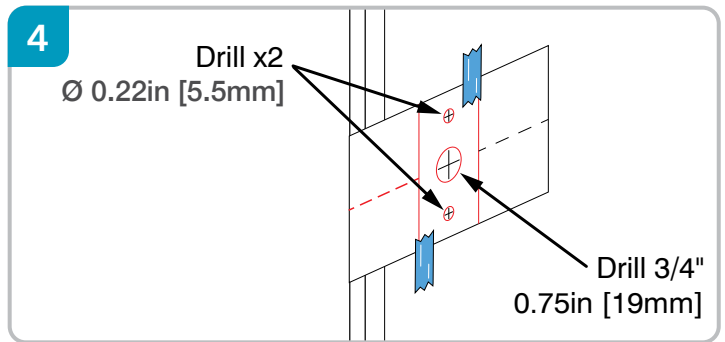

Mark the center points of the door mounting holes on the front of the door. Drill the holes according to the specified dimensions.

HOLE MOUNTING TEMPLATE

⚠ Before printing, turn off auto scaling or "Fit to Paper" in your printer setup and print at 100% ⚠

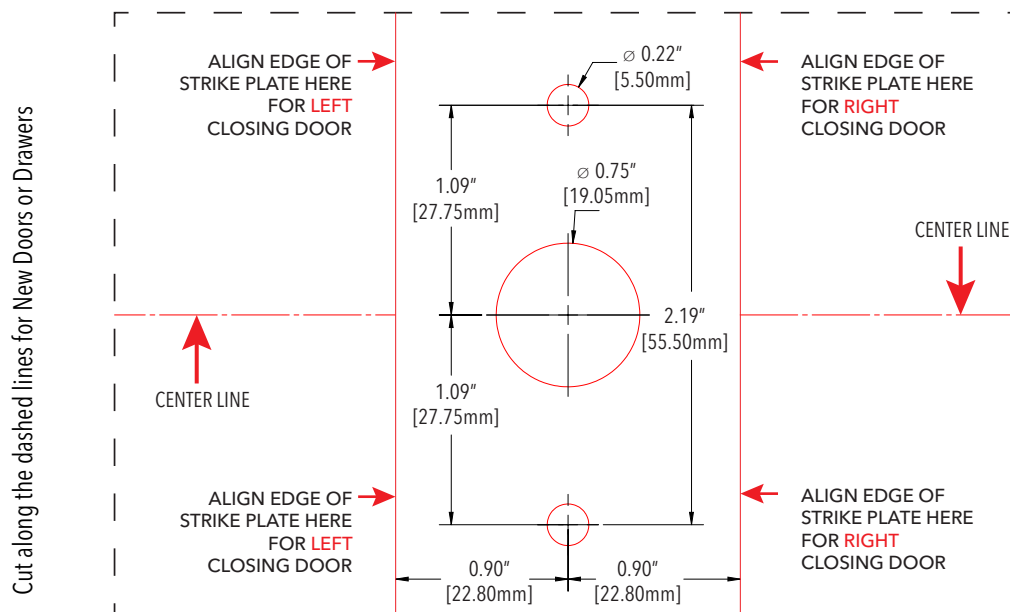

SURFACE MOUNT - 8 MM BOLT/LATCH



For door thickness measuring between [0mm - 26mm]

REQUIRED COMPONENTS

FRONT UNITS

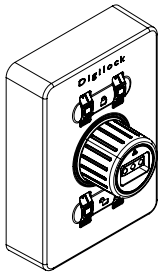

Standard Body

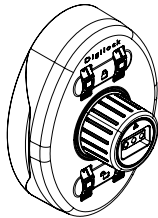

Oval Body

REAR UNITS

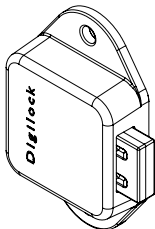

8 mm Bolt

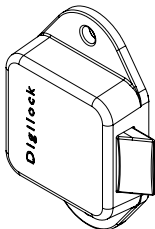

8 mm Latch

HARDWARE

2 - #10-24 Pan-head Phillips Screws

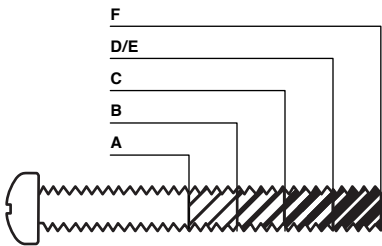

Screw Size	Length	Door Thickness	
		Min	Max
A	1/2" [12.70 mm]	0.0 mm	5.0 mm
B	3/4" [19.05 mm]	8.5 mm	12.0 mm
C	7/8" [22.22 mm]	11.5 mm	15.0 mm
D	1 1/8" [28.57 mm]	15.0 mm	19.5 mm
E	1 1/8" [28.57 mm] (with extender)	19.0 mm	21.5 mm
F	1 3/8" [34.92 mm]	21.5 mm	26.0 mm

REQUIRED TOOL

* Not Included

1 - Phillips Head Screwdriver (#2)*

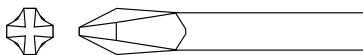

Note: It is recommended to only use torque **5 or lower** if using a power drill to avoid overtightening.

LOCK INSTALLATION STEPS

For illustration, oval body front unit with a bolt rear unit is shown.

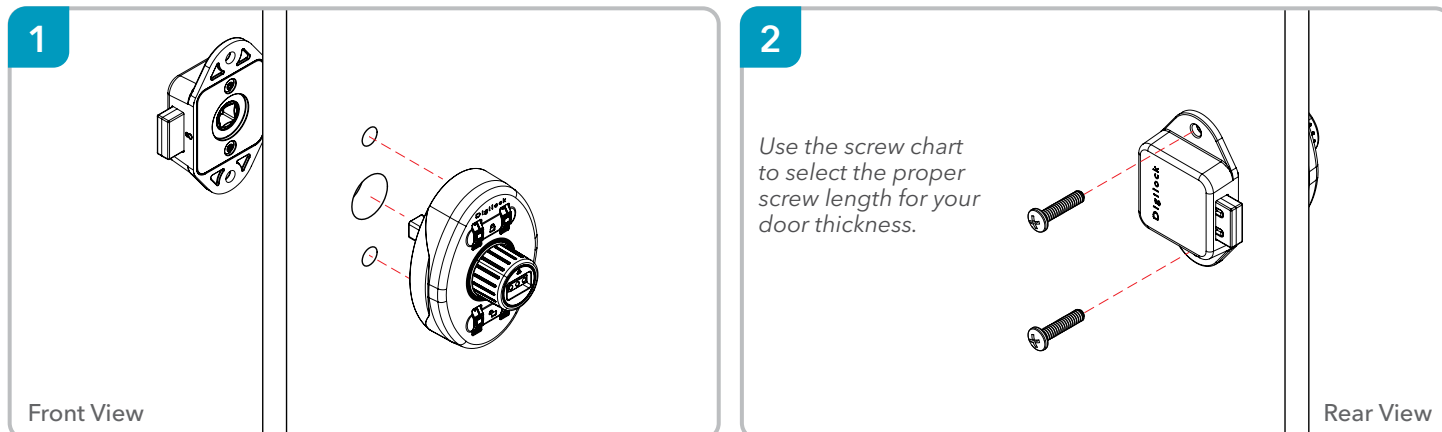

Hold and align the rear-unit behind the door using the mounting holes. Slide the front and rear units together.

Insert the screws through the mounting holes.

Tighten screws to the **torque level of: 5 or lower**

NOTE: Overtightening of the mounting hardware may result in the lock to improperly function.



Test the lock while the door is open to ensure that the bolt or latch is operating properly. Once installation is complete, refer to the Product Guide to setup and operate locks.

STRIKE INSTALLATION STEPS

Shown below Angled Strike Plate

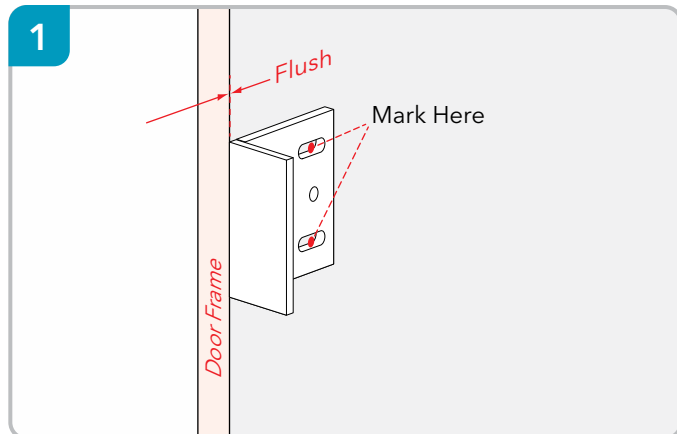

Position the strike plate on the door frame aligning it with the center of the lock's mounting holes.

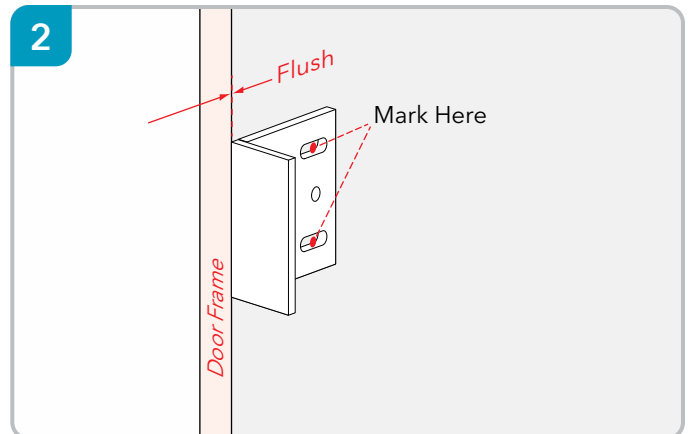

Keep flush with the door edge and mark the position of the adjustment slot holes.

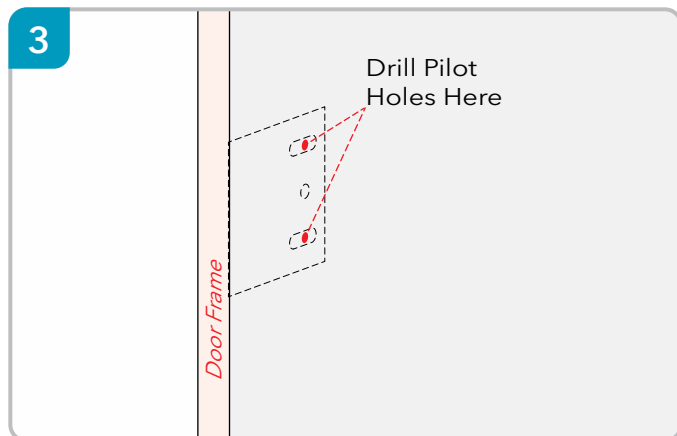

Drill 0.09" [2.38 mm] pilot holes using a $\frac{3}{32}$ " drill bit.

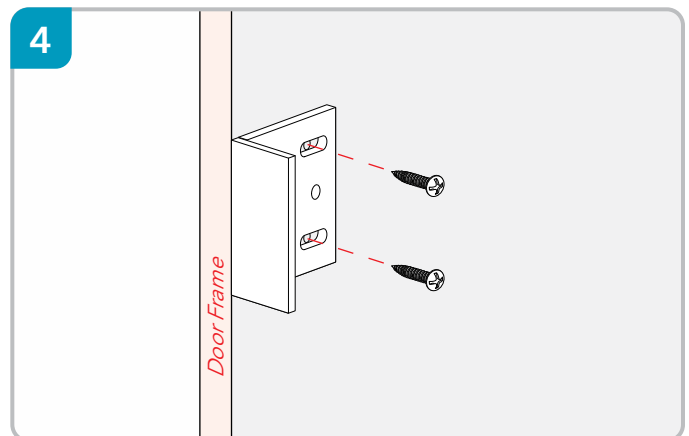

Position the strike plate and the self tapping screws into the adjustment slot holes. Do not tighten the screws.

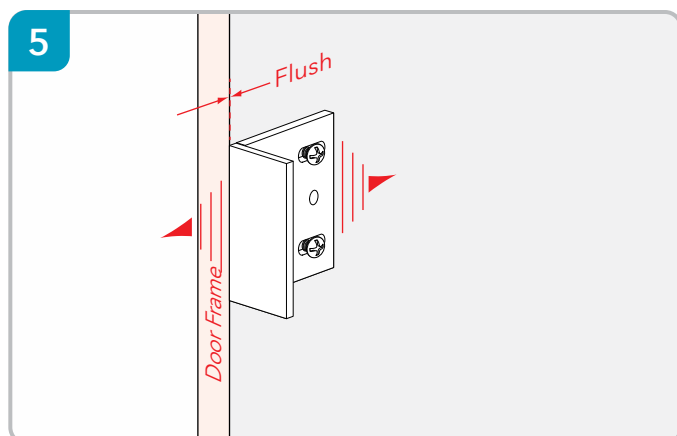

Adjust the strike plate to the proper position flush with the door edge then tighten the self tapping screws.

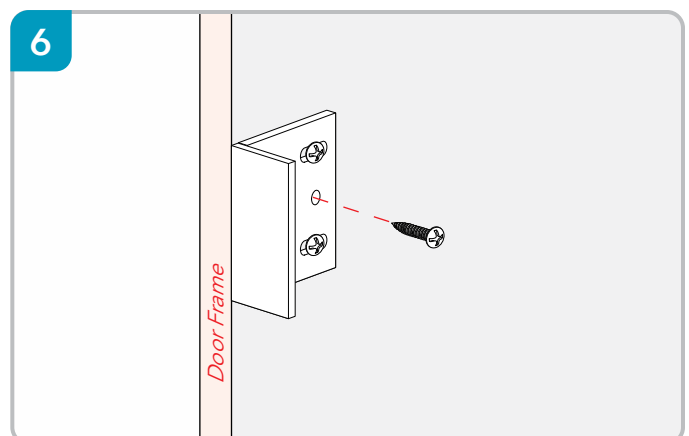

Insert and tighten the remaining self tapping screw into the center opening to secure strike position.

WOOD DOOR DRILLING INSTRUCTIONS

Door Mounting Holes Drill Instruction

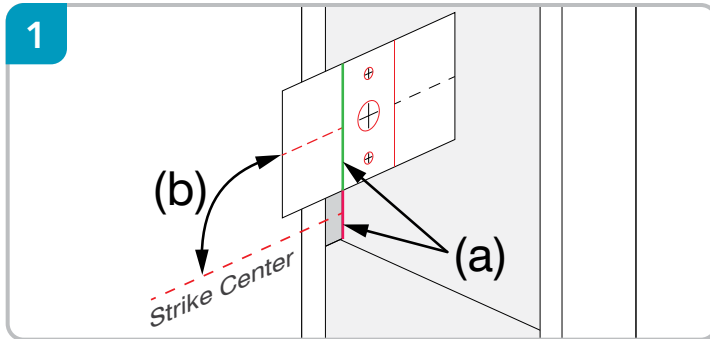

With the door open place the Template over the locker frame.
(a) Align the edge of Strike Plate with the Strike Plate Marker.
(b) Center the Template to the center of the Strike Plate.
 You may secure the Template with removable tape.

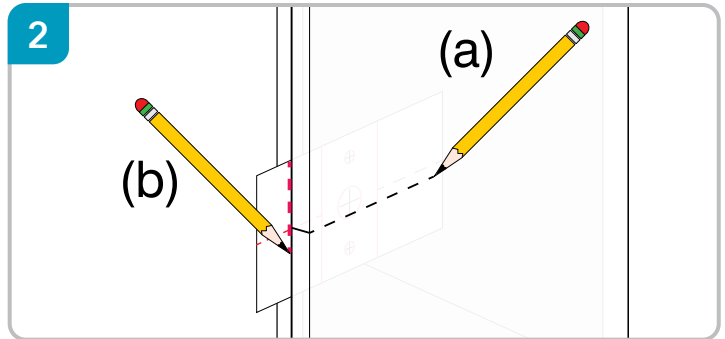

Close the door over the Template.
(a) Mark the door edge at the Template Center Line.
(b) Mark the Template with the edge of the door.

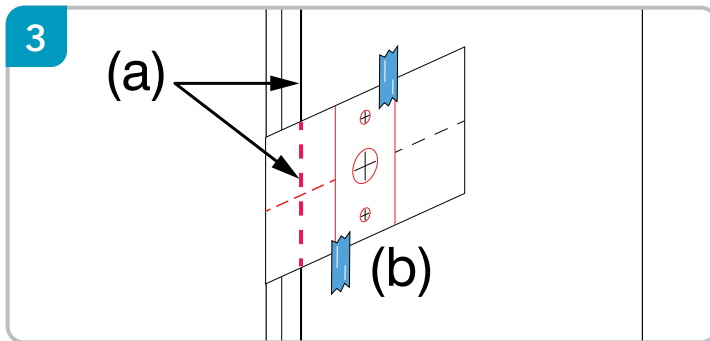

Place the Template on the front of the door.
(a) Align the drawn mark on the Template with the door edge.
(b) Center the Template with the mark on the door.
 Secure the Template with removable tape.

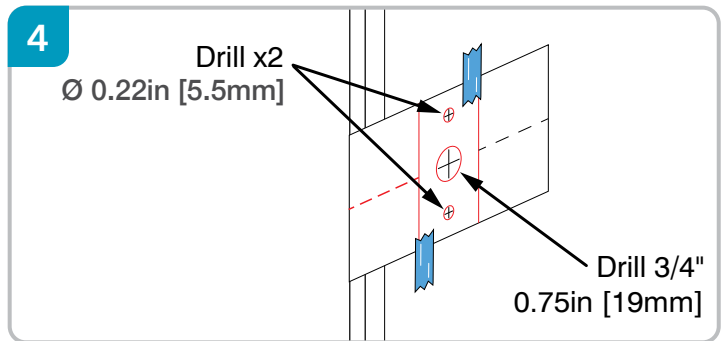

Mark the center points of the door mounting holes on the front of the door. Drill the holes according to the specified dimensions.

HOLE MOUNTING TEMPLATE

⚠ Before printing, turn off auto scaling or "Fit to Paper" in your printer setup and print at 100% ⚠

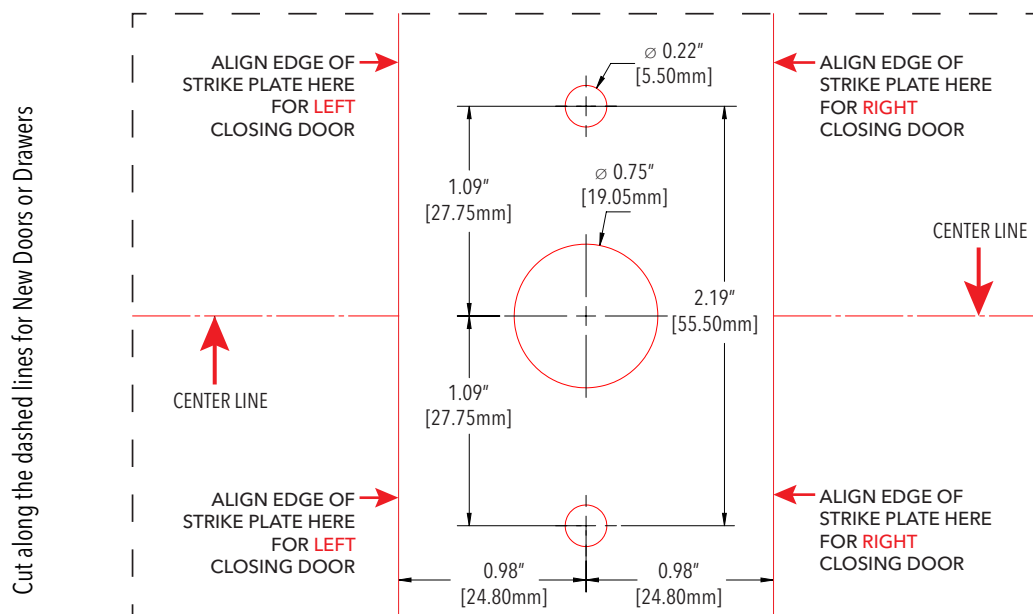

SURFACE MOUNT - 12 MM BOLT/LATCH

For door thickness measuring between [0mm - 26mm]

REQUIRED COMPONENTS

FRONT UNITS

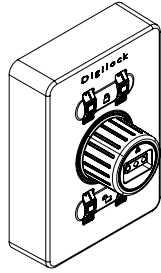

Standard Body

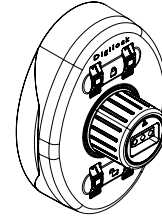

Oval Body

REAR UNITS

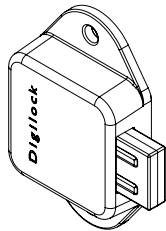

12 mm Bolt

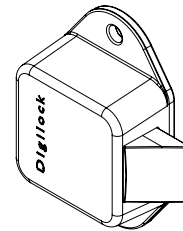

12 mm Latch

HARDWARE

2 - #10-24 Pan-head Phillips Screws

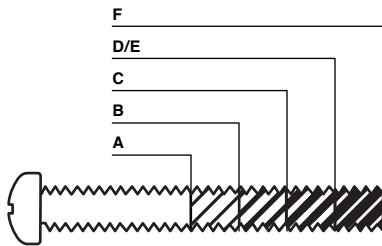

Screw Size	Length	Door Thickness	
		Min	Max
A	1/2" [12.70 mm]	0.0 mm	5.0 mm
B	3/4" [19.05 mm]	8.5 mm	12.0 mm
C	7/8" [22.22 mm]	11.5 mm	15.0 mm
D	1 1/8" [28.57 mm]	15.0 mm	19.5 mm
E	1 1/8" [28.57 mm] (with extender)	19.0 mm	21.5 mm
F	1 3/8" [34.92 mm]	21.5 mm	26.0 mm

REQUIRED TOOL

* Not Included

1 - Phillips Head Screwdriver (#2)*

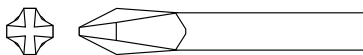

Note: It is recommended to only use torque **5 or lower** if using a power drill to avoid overtightening.

LOCK INSTALLATION STEPS

For illustration, oval body front unit with a bolt rear unit is shown.

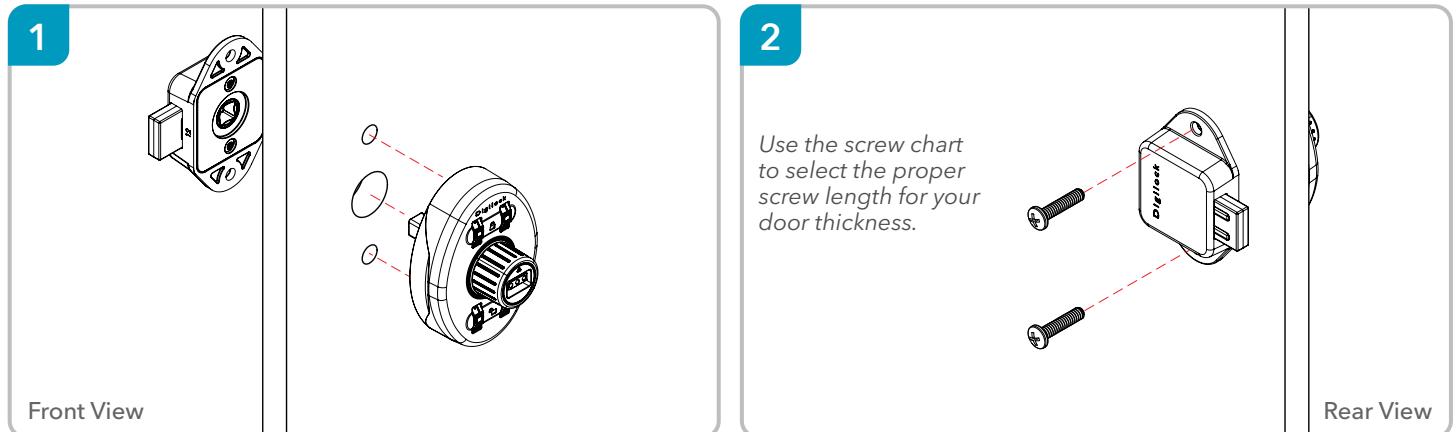

Hold and align the rear-unit behind the door using the mounting holes. Slide the front and rear units together.

Insert the screws through the mounting holes.

Tighten screws to the **torque level of: 5 or lower**

NOTE: Overtightening of the mounting hardware may result in the lock to improperly function.



Test the lock while the door is open to ensure that the bolt or latch is operating properly. Once installation is complete, refer to the Product Guide to setup and operate locks.

WOOD DOOR DRILLING INSTRUCTIONS

Door Mounting Holes Drill Instruction

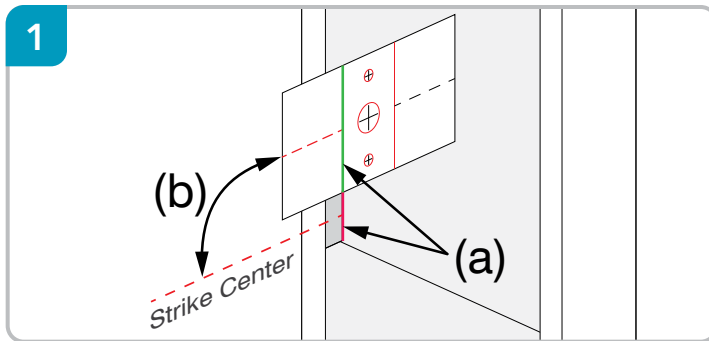

With the door open place the Template over the locker frame.
(a) Align the edge of Strike Plate with the Strike Plate Marker.
(b) Center the Template to the center of the Strike Plate.
 You may secure the Template with removable tape.

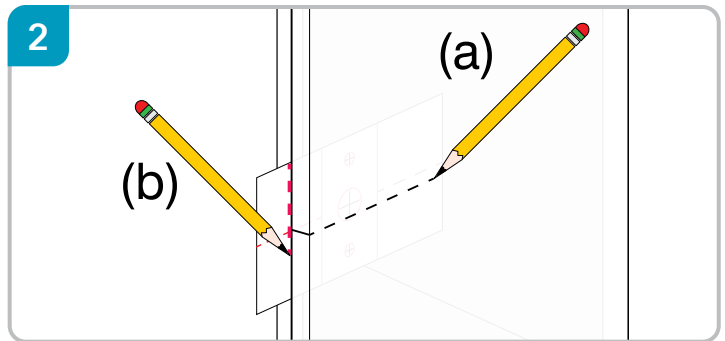

Close the door over the Template.
(a) Mark the door edge at the Template Center Line.
(b) Mark the Template with the edge of the door.

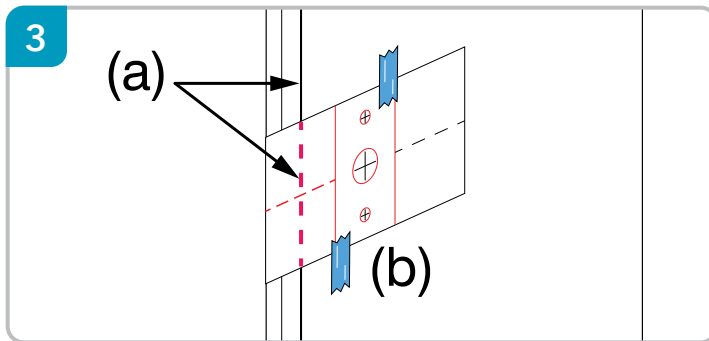

Place the Template on the front of the door.
(a) Align the drawn mark on the Template with the door edge.
(b) Center the Template with the mark on the door.
 Secure the Template with removable tape.

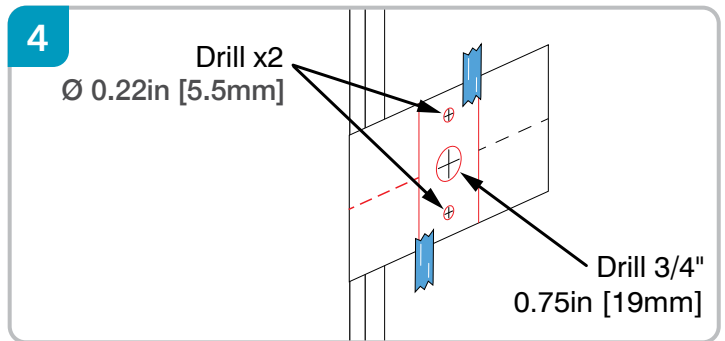

Mark the center points of the door mounting holes on the front of the door. Drill the holes according to the specified dimensions.

HOLE MOUNTING TEMPLATE

⚠ Before printing, turn off auto scaling or "Fit to Paper" in your printer setup and print at 100% ⚠

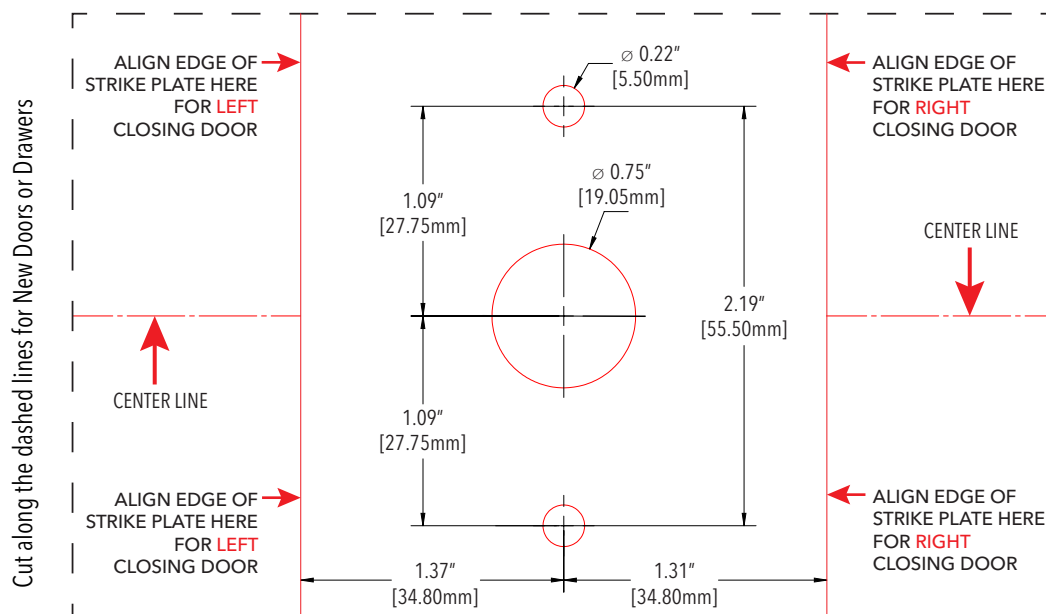

SURFACE MOUNT - FLAT CAM



For door thickness measuring between [0mm - 20mm]

REQUIRED COMPONENTS

FRONT UNITS

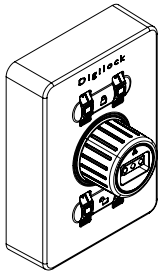

Standard Body

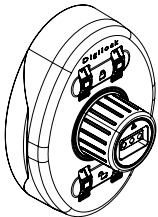

Oval Body

REAR UNIT

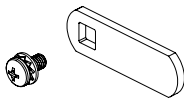

Flat Cam

HARDWARE

2 - #10-24 Pan-head Phillips Screws

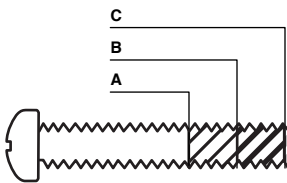

Screw Size	Length	Door Thickness	
		Min	Max
A	1/2" [12.70 mm]	0 mm	9 mm
B	3/4" [19.05 mm]	9 mm	15 mm
C	1" [25.40 mm]	15 mm	20 mm

REQUIRED TOOL

* Not Included

1 - Phillips Head Screwdriver (#2)*

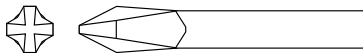

Note: It is recommended to only use torque **5 or lower** if using a power drill to avoid overtightening.

LOCK INSTALLATION STEPS

For illustration, oval body front unit is shown.

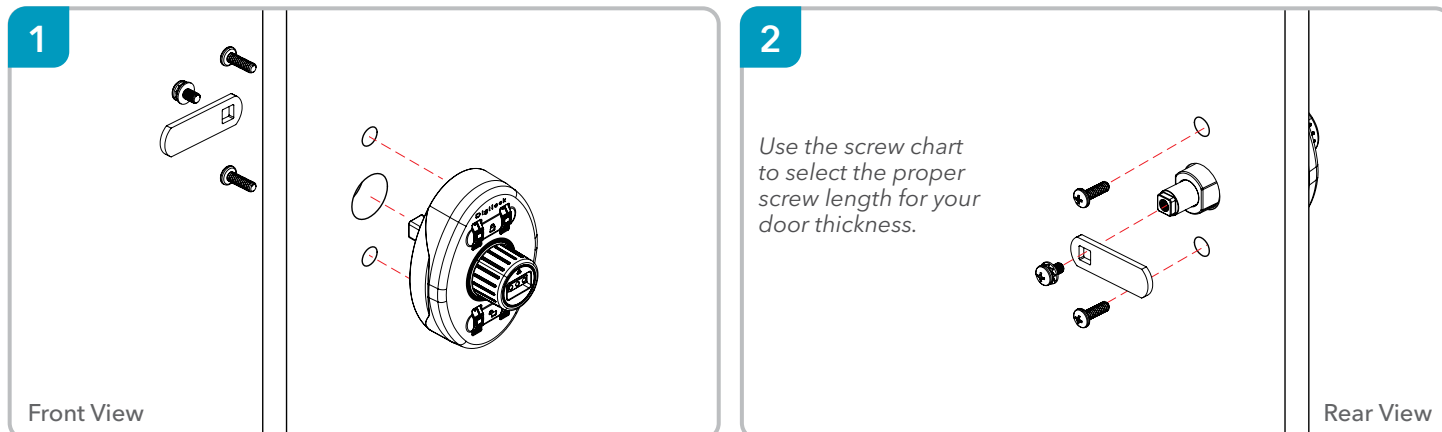

Hold and align the front-unit behind the door using the mounting holes. Insert the flat cam.

Insert the screws through the mounting holes.

Tighten screws to the **torque level of: 5 or lower**

NOTE: Overtightening of the mounting hardware may result in the lock to improperly function.



Test the lock while the door is open to ensure that the cam is operating properly.

Once installation is complete, refer to the Product Guide to setup and operate locks.

HOLE MOUNTING TEMPLATE

⚠ Before printing, turn off auto scaling or "Fit to Paper" in your printer setup and print at 100% ⚠

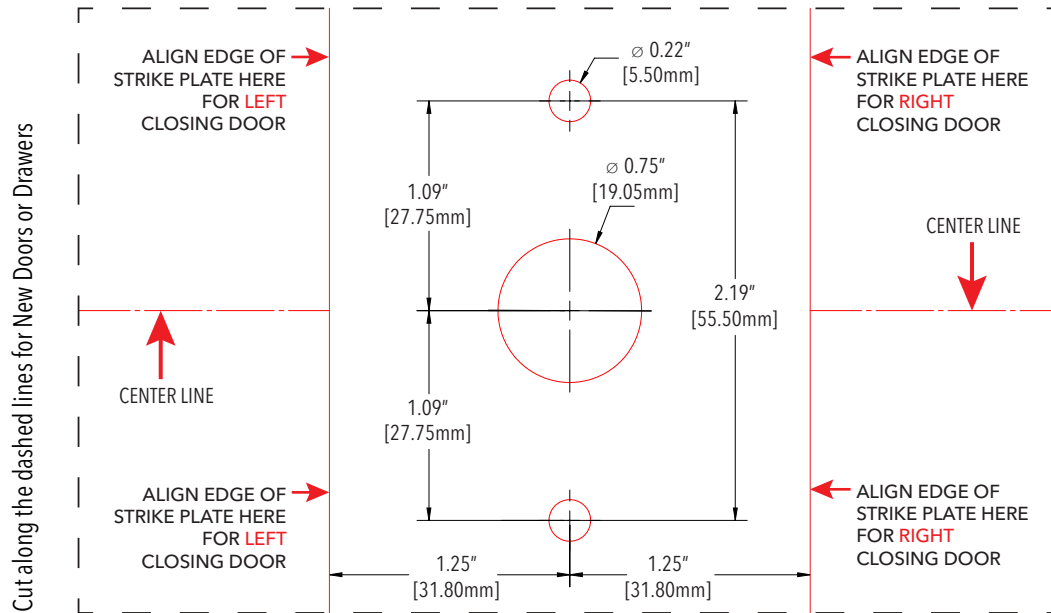

SURFACE MOUNT - OFFSET CAM



For door thickness measuring between [0mm - 9mm]

REQUIRED COMPONENTS

FRONT UNITS

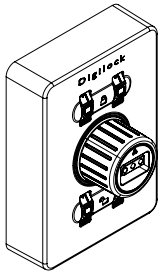

Standard Body

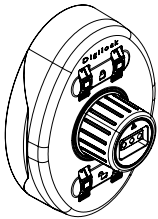

Oval Body

REAR UNIT

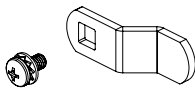

Offset Cam

HARDWARE

2 - #10-24 Pan-head Phillips Screws

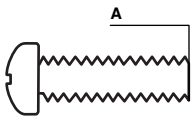

Screw Size	Length	Door Thickness	
		Min	Max
A	1/2" [12.70 mm]	0 mm	9 mm

REQUIRED TOOL

* Not Included

1 - Phillips Head Screwdriver (#2)*

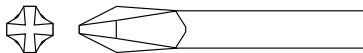

Note: It is recommended to only use torque **5 or lower** if using a power drill to avoid overtightening.

LOCK INSTALLATION STEPS

For illustration, oval body front unit is shown.

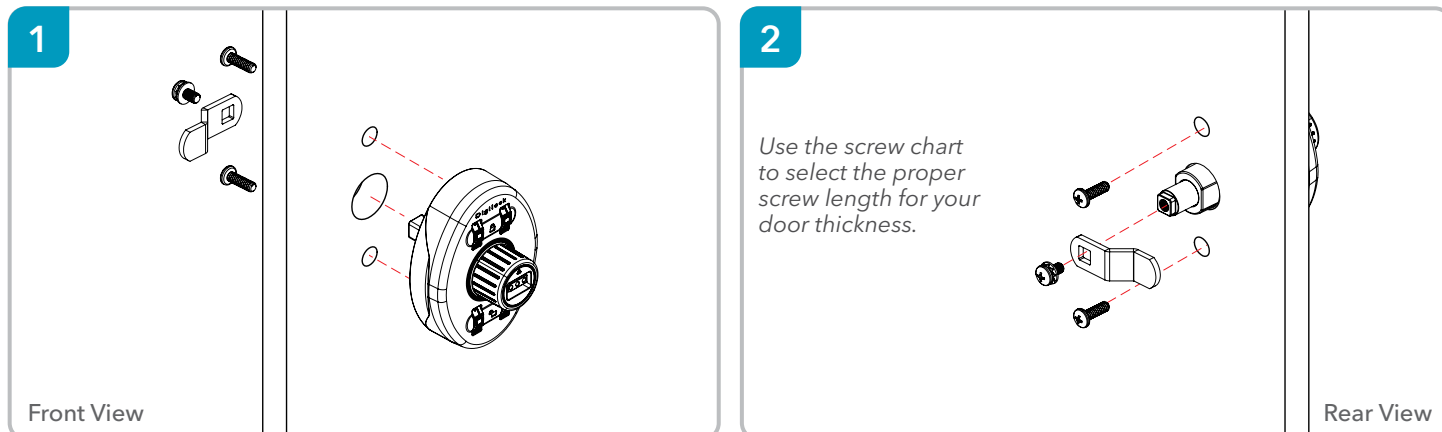

Hold and align the front-unit in front of the door using the mounting holes. Insert the offset cam.

Insert the screws through the mounting holes.

Tighten screws to the **torque level of: 5 or lower**

NOTE: Overtightening of the mounting hardware may result in the lock to improperly function.



Test the lock while the door is open to ensure that the offset cam is operating properly. Once installation is complete, refer to the Product Guide to setup and operate locks.

LIMITED WARRANTY. Company warrants to the original purchaser of Product manufactured by Company to be free of defects in material and workmanship, provided: (1) Company has been notified of such defects within two years of purchase date and been given the opportunity of inspection by return of any alleged defective Product to Company, or its authorized distributor, free and clear of liens, encumbrances, transportation prepaid, accompanied by the statement of defects and proof of purchase; and (2) Product has not been subject to modification, abuse, misuse, mishandling, misapplication, neglect (including but not limited to improper maintenance), accident, improper installation, alteration and/or modification (including but not limited to use of unauthorized parts or attachments), disassembly, or adjustment or repair performed by anyone other than an authorized service personnel during such period; and (3) such defect has not been caused by corrosion or ordinary wear and tear. This warranty does not cover batteries, normal wear and tear of parts and/or damage resulting from any of the following: negligent use or misuse of product, use of improper voltage or current, and/or use contrary to operating instructions. The exclusive remedy shall not be deemed to have failed of its essential purpose so long as Company is willing and able to repair or replace non-conforming Product in the prescribed manner.

Unless the product is listed as IP55 rated or otherwise expressed by Company on the sales order acknowledgment, Product is not designed or intended for exterior use or where exposed to moisture. Any use where Product is exposed to moisture is not covered by any warranties and voids any warranties and any resulting damage caused by direct exterior exposure or moisture is at the Buyer's own risk.

The liability of Company for any breach of the foregoing warranty shall not extend to dismantling, installing or reinstalling, but shall be limited to repairing or replacing said items, as Company's option, within a reasonable time after receipt of written notice from Buyer, within the period of time stipulated herein, of any such non-conforming Product, provided that (i) such notice is given immediately upon the detection of such non-conformance and (ii) such notice is received within the time period stipulated herein. BUYER AND COMPANY EXPRESSLY AGREE THAT THE BUYER'S SOLE AND EXCLUSIVE REMEDY AGAINST COMPANY SHALL BE FOR THE REPAIR OR REPLACEMENT (AT COMPANY'S OPTION) OF NON-CONFORMING PRODUCT AS PROVIDED HEREIN.

COMPANY SPECIFICALLY DISCLAIMS ANY OTHER WARRANTIES, EXPRESS, IMPLIED, OR STATUTORY, INCLUDING WITHOUT LIMITATION THE IMPLIED WARRANTY OF FITNESS FOR A PARTICULAR PURPOSE AND THE IMPLIED WARRANTY OF MERCHANTABILITY, AND COMPANY ALSO SPECIFICALLY DISCLAIMS ANY LIABILITY FOR CONSEQUENTIAL OR INCIDENTAL DAMAGES. IN NO EVENT SHALL COMPANY BE LIABLE FOR INCIDENTAL OR CONSEQUENTIAL DAMAGES ARISING OUT OF OR IN CONNECTION WITH THIS AGREEMENT (INCLUDING BUT NOT LIMITED TO BREACH OF ANY OBLIGATION IMPOSED ON COMPANY HEREUNDER OR IN CONNECTION HERewith) OR THE USE, STORAGE, DISPOSAL OR HANDLING OF PRODUCT. Consequential damages for purposes hereof shall include, without limitation, loss of use, income or profit, shutdown, slowdown or stoppage of any production line or facility, or losses sustained as the result of injury (including death) to any person, or loss of or damage to property (including without limitation property handled or processed by the use of Product). Buyer shall indemnify Company against all liability, cost or expense which may be sustained by Company on account of any such loss, damage or injury.

Company will not evaluate warranted Product without Buyer obtaining a Return Merchandise Authorization (RMA) number from Company. Such returns must be prominently marked with the RMA number and shipped prepaid.

Company makes no other warranty, and the warranty is limited to the duration of the expressed warranty period as set forth above

NOTE: Should Product be considered a consumer product as may be covered by the Magnusson Moss Federal Warranty Act, please be advised that: (1) some states do not allow limitations on incidental consequential damages or how long an implied warranty lasts so that the above limitations may not fully apply; (2) this warranty gives specific legal rights, and a buyer may also have other rights which may vary from state to state.

LIMITATION OF LIABILITY. Company's maximum liability for any damages resulting from or caused by Product, whether in contract, tort, or otherwise, is limited to the purchase price of Product. In no event shall Company be liable for any consequential damages of any nature arising from the sale or use of Product, whether in contract, tort or otherwise, by either use or purchase of Product, the user or purchaser agrees to this limit on Company's liability. Company is not responsible for any modification, addition or alteration to Product by others.

Company reserves the right to make changes in designs and specifications or to make additions or improvements on its products without notice and without incurring any obligation to incorporate them on products previously manufactured.



CONTACT INFORMATION

DIGILOCK AMERICAS

Sales

Email: sales@digilock.com

Phone: +1 800 989 0201

Support

Email: support@digilock.com

Toll Free: +1 866 712 7071

DIGILOCK EUROPE BV

Sales

Email: sales@digilock.eu

Phone: +31 0 20 303 3060

Support

Email: support@digilock.eu

Toll Free: +1 866 696 0979

DIGILOCK ASIA

Sales

Email: sales@digilock.asia

Phone: +852 2776 0800

Support

Email: support@digilock.asia

Toll Free: +1 866 699 9180