

Zones Guide

Streamline control of your Sonos system.

SONOS



Customize your Sonos sound experience with different speaker configurations

With a dynamic range of audio products that include everything from plug-and-play speakers to integrated multiroom systems, Sonos makes it easy to create a custom sound solution for every space. With configurations, such as a stereo pair or home theater system, Sonos provides multiple ways to connect speakers for flexible and immersive listening. A zone is a specific type of configuration that offers easier control of multiple speakers in a large space.

What is a zone?

A zone is a configuration where multiple speakers play together for easier control in the Sonos app. Zones are most beneficial in commercial environments, where there are often a greater number of speakers. Zones can be created, edited, and removed easily in the Sonos app. Think of a zone as a semi-permanent collection of speakers.

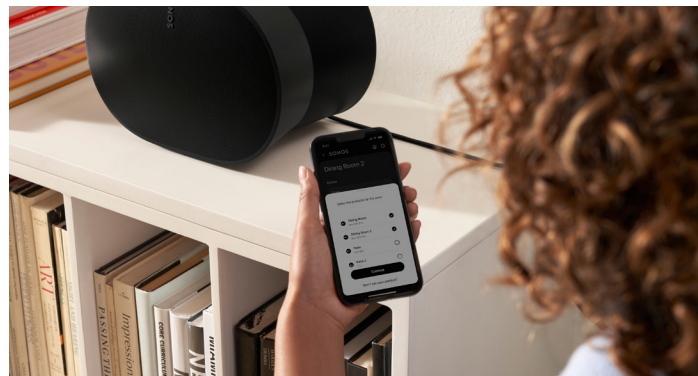

What is a group?

A group is used to temporarily synchronize individual speakers and/or configurations — including zones — so listeners can enjoy a consistent sound experience as they move through a space. For example, if you were throwing a party in a home, you could group speakers in the kitchen, living room, and backyard to all play the same music.

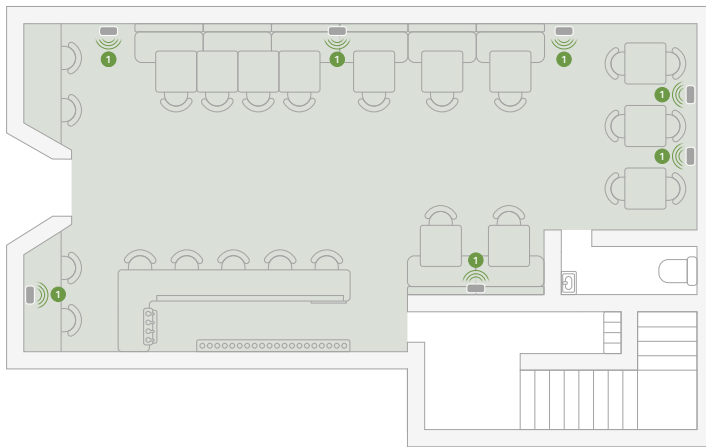

A single zone

When multiple speakers are placed within a space, creating a zone allows you to control the entire system together. In many cases, you will configure all speakers in a space as a zone to ensure even sound coverage and simplify management of playback and audio settings, such as volume.

Multiple rooms, multiple zones

Alternatively, you may have multiple rooms or areas that are used for different purposes. For example, a restaurant may have a main dining area and another room for private events. Setting up the private room as a zone gives the restaurant greater control if the patrons want to play different content.

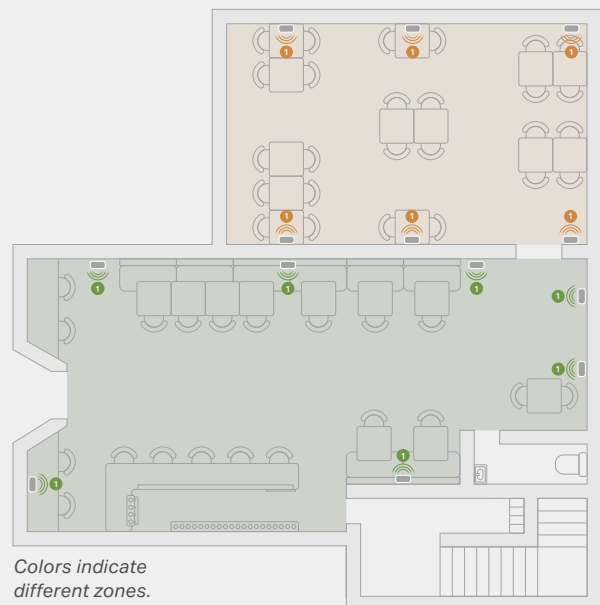

Colors indicate different zones.

How to use zones

Once speakers are configured as a zone, they will all play the same content at the same volume.

You can still control the volume and EQ settings of each speaker in a zone, but you can't stream different content to each individually.

You can also use the chime function for speakers in a zone. This will help you identify an individual speaker in case you need to troubleshoot or make adjustments.

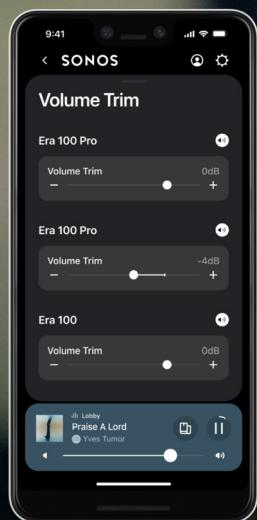

Volume Trim

Provides a relative volume control for each speaker in a zone.

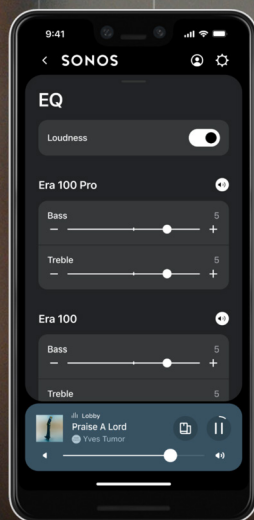

EQ

Settings can be adjusted for each speaker in a zone.

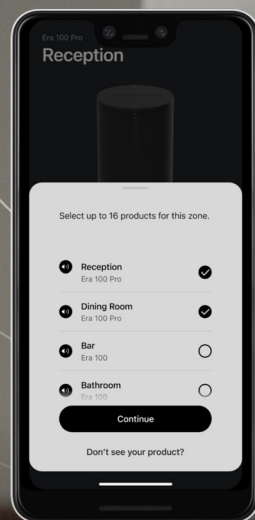

Chime

Plays audio and flashes the speaker's LED for easy identification.



Using groups with zones

Temporarily group zones together in the Sonos app to tailor the sound experience for activities and preferences. In a spa, for example, you could play one kind of music in the reception area to welcome guests and another kind of music in treatment rooms.

Colors indicate different zones. Orange line indicates groups.

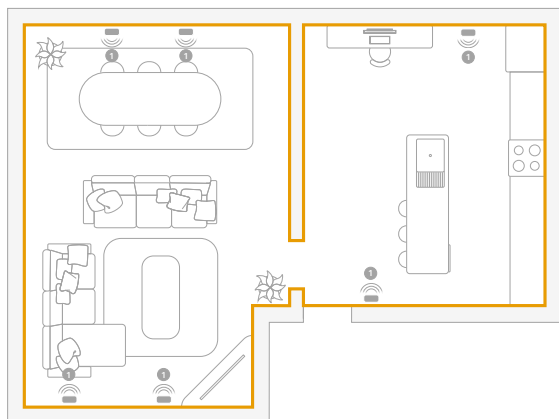

Group multiple speakers together

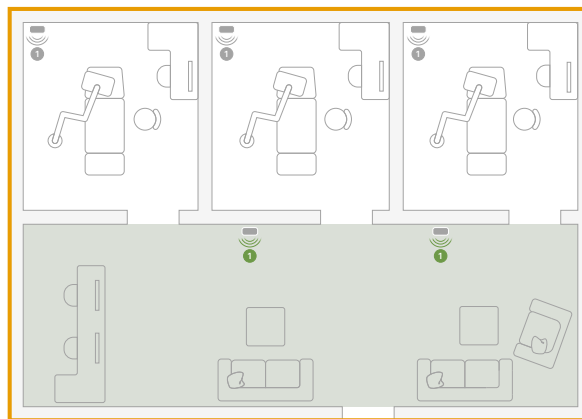

Group any unzoned loudspeakers and zones

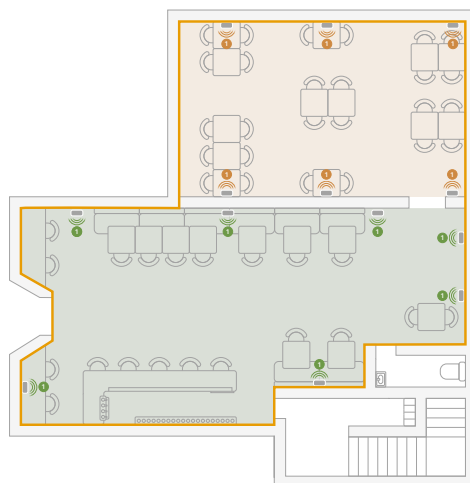

Group two zones together

Zones compatibility

You can place a maximum of 16 devices (any combination from the list) into a zone. To ensure the best experience, we recommend a wired internet connection into each speaker. If a wireless connection is needed, we recommend not exceeding six (6) WiFi connected devices per zone.

The following Sonos speakers can be used in any combination to create a zone.

- Era 100 Pro
- Era 100
- Era 300*
- Sonos One SL
- Sonos One (all generations)
- Sonos Five

**Era 300 works as a stereo speaker when placed in a group or zone.*

How to set up a zone

Navigate to system settings, choose a **product**, and press **Set Up a Zone**.

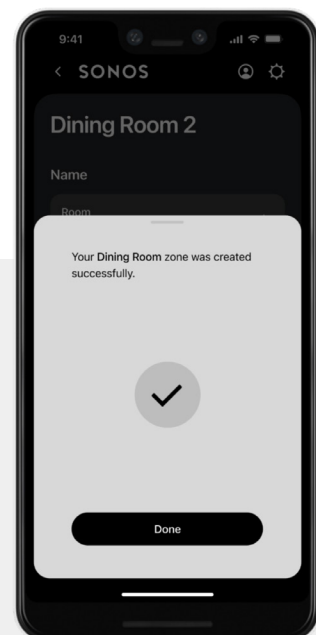
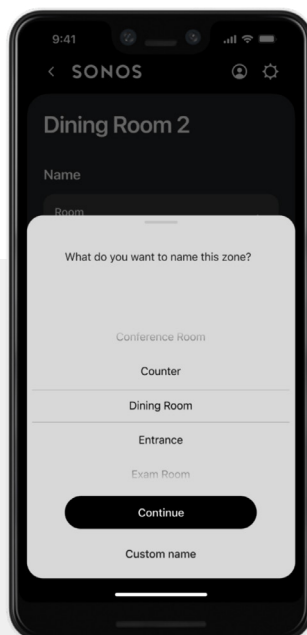
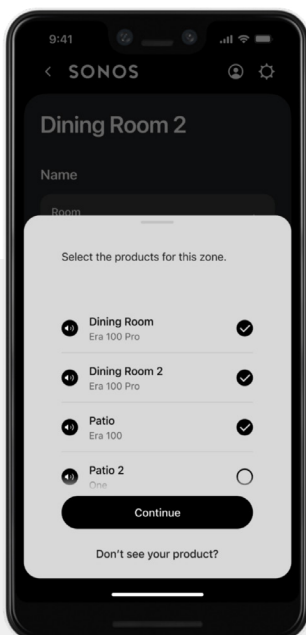
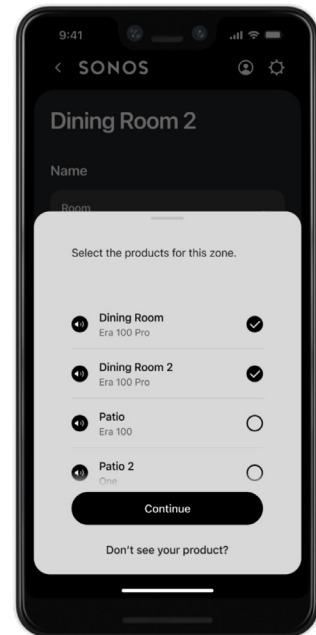
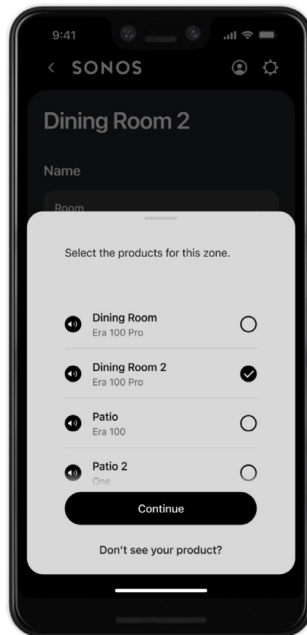
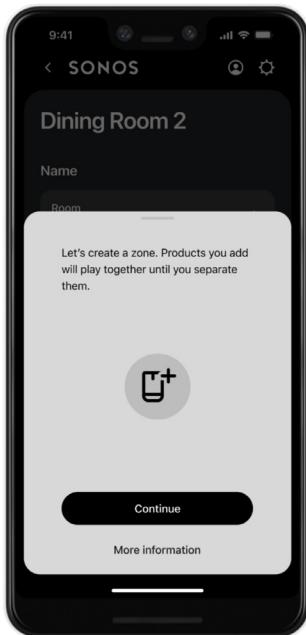

SONOS